

S+

GP

THE GLASS
PANORAMA
ELEVATOR

S+

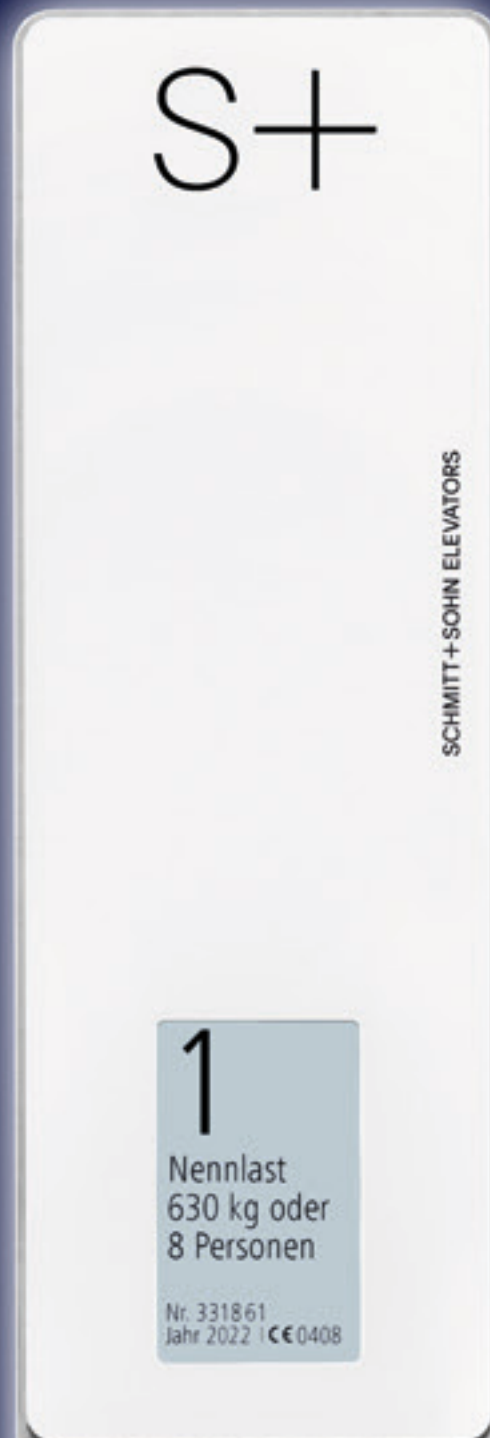

GP
GLASS PANORAMA ELEVATOR
DESIGN THE FUTURE
SPARK INSPIRATION

CONTENTS

Welcome	6
<hr/>	
Key performance indicators	8 – 9
<hr/>	
The Elevator	10 – 61
Quality	14
Materials–Colours–Surfaces	28
Doors	36
Accessories	40
Responsibility	66
<hr/>	
The planning	68 – 79
<hr/>	
The service	80 – 85
<hr/>	
Contact	86
Imprint	88



WELCOME

It is with joy and pride that we present to you the product brochure for the GP The Glass Panorama elevator, an internationally award-winning product, born from the passion of 1,900 committed employees. For customers with the highest expectations for architecture, design, and quality and who value long-lasting partnership. A product that captures the imagination from design through to service, setting international standards thanks to its impressive technology and outstanding design. A product based on experience that you will value.

We are a family company that has been designing, constructing and looking after elevators for over 100 years now based on our commitment to firstclass and sustainable products. The GP Glass Panorama Elevator is just such a product.

By concentrating on what is truly important, like function and quality design, we develop outstanding, high-performing elevators. These are elevators characterised by their elegance and lasting value. Elevators that invite people to use them, and that enable mobility in any building with reliability and high efficiency. The economy of the GP is based not only on an outstanding concept of simplified design and personal project support. The high-quality materials and precise execution of exacting detailing solutions make the GP unique, and ensure it retains its value. Combined with the excellent service, the GP stands for the high availability of every Schmitt+ Sohn elevator.

We and all of our employees stand for these values. From the conviction of a family-run company with a century-long tradition. Responsible for employees, customers and partners.

Browse, read, discover.

Experience elevator architecture in a new light.
Welcome to Schmitt+ Sohn.

Maximilian Schmitt
Managing Partner



OUR KEY PERFORMANCE INDICATORS

Schmitt+Sohn at a glance – the key performance indicators of a successful company

1861	6	18	4
Foundation of the company. A long tradition in elevator construction and service begins.	generations of experience. The company family remains a constant.	domestic and foreign companies. Decentralised, and always close by.	countries in Europe. We maintain locations in: Germany, Portugal, Austria, and the Czech Republic.
2,100	100,000	1,900	9001
systems produced annually. Production in our own plants.	elevator systems built. Our reference customers are distributed throughout Europe.	employees. Success has many faces. 130 apprentices are included in this number.	standard quality. Improving. Developing. Looking ahead.
24	60,000	180	0
-hour on-call readiness 365 days per year. Always there for you.	systems to be serviced annually. Competence you can rely on.	million euros in turnover. Convincing results.	bank liabilities. Independence for strong partnerships.

Our Values

Ongoing learning: That is what our 1,900 passionate employees, who contribute their expertise and abilities every day, stand for.

Quality: Continuous development and improvement of our processes and products, for example in production. Each year, 2,100 new systems leave our company with a consistently high level of quality.

Corporate reliability: The foundation of long-lasting relationships to our customers and our employees. This is a value we have been focused on for over 160 years.

Our products

We develop outstanding products that meet high technical and aesthetic requirements. They are created through a dialog between architecture, design, and technology. This is part of our self-conviction as a company. A systematic approach, functionality, and the quality of painstaking workmanship down to the last detail are part of our commitment to meaningful development and design. Human mobility is our mission.

Our service

We provide you access to a service manager to support you for the entire time your elevators are in service. This is a big responsibility, as we service over 60,000 systems each year. Thanks to a decentralized network, we are always nearby to ensure you receive the support you need. Reliability is our top priority: our services are available to you 24 hours a day, 365 days a year - with no waiting time, for successful, long-term partnership.



View our corporate film here.



GP THE GLASS PANORAMA ELEVATOR

S+

GP THE GLASS PANORAMA ELEVATOR

AN INTERNATIONALLY
AWARD-WINNING
PREMIUM PRODUCT
FOR SOPHISTICATED
ARCHITECTURE.

GP The Glass Panorama Elevator

Welcome to an all-new, fascinating dimension of elevator design. See architecture in a new light. Change perspectives. Experience premium quality.

The GP Glass Panorama Elevator combines excellent quality, progressive design, and impressive technology. Honoured with major design and architectural prizes. For customers who expect uncompromising quality and top technical and design performance. The GP Glass Panorama Elevator impresses from planning to service. Developed from a commitment to good building and timeless values.

GP design

The GP design is characterised by transparency and maximum functionality. Aimed at achieving innovation, mobility and intelligent building circulation. The equipment and design of the GP cars are aimed at achieving an impressive sense of space and a comfortable interior concept with high-quality materials and information focused on the needs of the user. All-new LED-RGB illuminated ceilings present lighting design in perfection. The light quality underscores the elegance of the GP cars. RGB colour controls can also be used to create a wide array of attractive designs. Colours, colour changes and rhythms can be combined to create great effects. The result are inspiring lighting atmospheres in the GP car.

GP economic efficiency

This is where the GP sets standards. Machine room-less, space-saving, with low energy and operating costs. In addition to its outstanding drive advantages, the GP is a top-class, future-proof investment. Easy to design. Quick to manufacture. Safe to assemble. The economy of the GP is based not only on the concept of simplified design and personal project support. The high-quality materials and careful execution of exacting detailing solutions ensure value retention and make it unique. Combined with excellent service, the GP stands for the high availability of every Schmitt+Sohn elevator. We and all of our employees stand for these values.

GP comfort and safety

Safety, ergonomics, and passenger comfort are the result of an intensive development dialogue between architecture, design and technology. Users, operators and service personnel enjoy the effective protection of a comprehensive safety concept. Developed in accordance with European standards. Naturally type-tested. The company's own development employees who undergo regular qualification. Sales, production, assembly and service ensure the highest level of quality and continuous availability

Welcome to Schmitt+Sohn elevators.

GP
QUALITY
PERFECTION
IN EVERY DETAIL





Illumination: LD5X-LED illuminated ceiling

Dimensions: HWD 100 x 940 x 1,240 mm*
 Illuminated frame: Underside LSG, semitransparent, illuminated. Side: acrylic glass, white, polished, semitransparent
 Middle area: LSG, semitransparent, illuminated
 Lamps: LED, neutral white

*Example dimensions for car size KB 1,100 mm x KT 1,400 mm

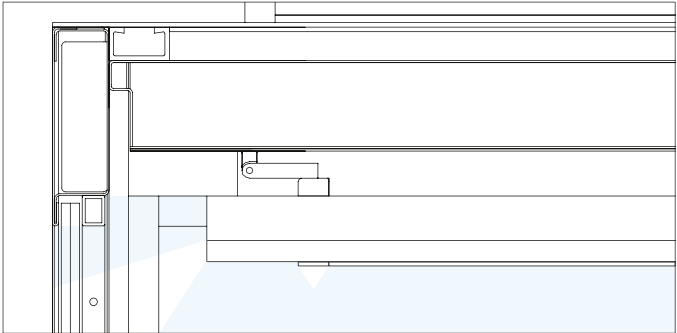

Vertical section: ceiling with surface-mounted LD5X light. Illuminated frame light pattern, illuminated middle area.



Control panel BT-I-TFT-LED

Dimensions: HWD 1,205 x 150 x 15 mm
 Control panel: Fine polished stainless steel
 Illuminated frame: Acrylic glass, white, satin finish, LED white
 Information panel: Acrylic glass, white
 Display: TFT high-resolution
 Buttons: Fine polished stainless, flush-mounted
 Call acknowledgement: Blue LED
 Symbols: Light grey plastic

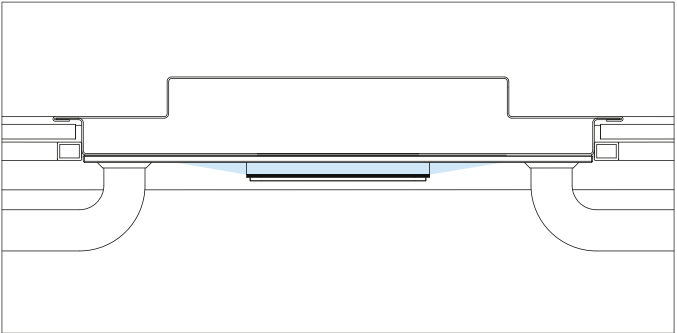

Horizontal section: side wall with surface-mounted control panel. Illuminated frame light pattern.



Handrail HL

- Handrail: Fine polished stainless steel, \varnothing 33.7 mm
- Handrail bracket: Fine polished stainless steel, solid material
- Handrail end pieces: Fine polished stainless steel

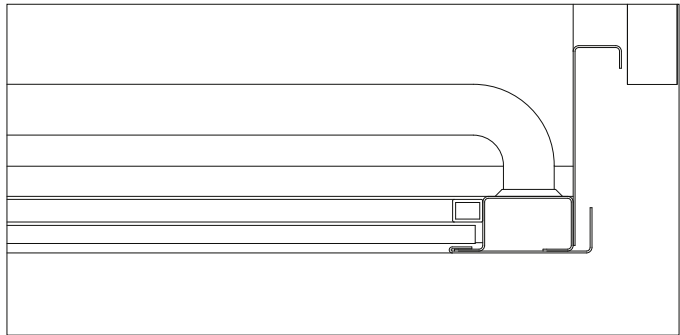

Horizontal section: side wall
Handrail bracket



- Handrail curve: Fine polished stainless steel, welded
- Handrail support: Fine polished stainless steel, solid material

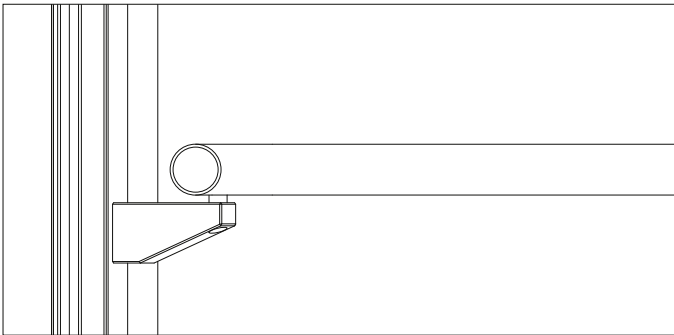

Vertical section: back wall / side wall
Car corner / handrail support

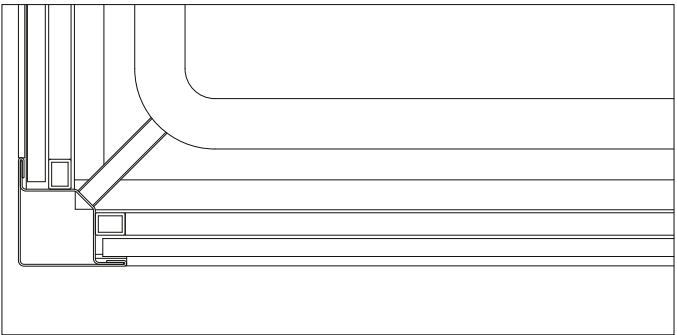

Horizontal section: back wall / side wall
Car corner / handrail support



Handrail GP cars $\geq 1,000$ kg

- Handrail: Fine polished stainless steel, $\varnothing 33.7$ mm
- Handrail bracket: Fine polished stainless steel, solid material
- Handrail holder: Fine polished stainless steel, solid material
- Handrail end pieces: Fine polished stainless steel
- Handrail curves: Fine polished stainless steel, welded

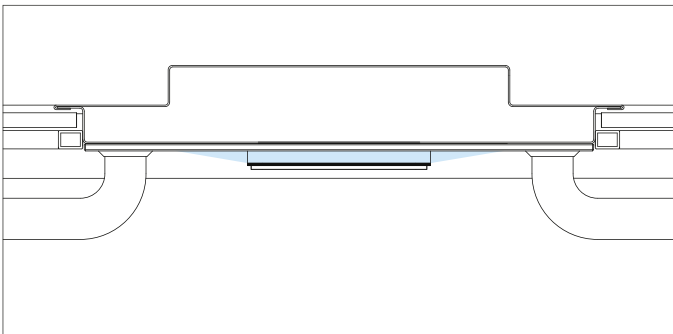

Horizontal section: middle panel, side wall with control panel
Akzent Color Glas®

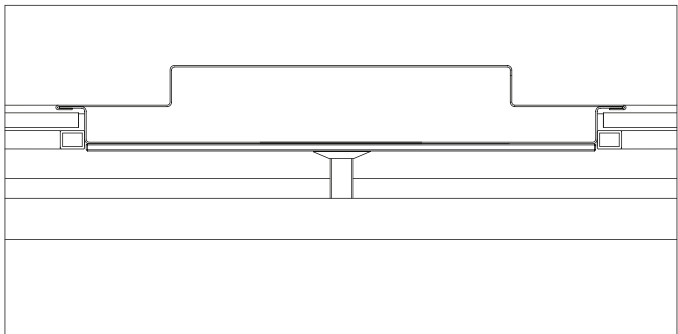

Horizontal section: middle panel, side wall without control panel
Akzent Color Glas®



Floor / skirting

- Floor: Light grey granite
- Skirting: Fine polished stainless steel

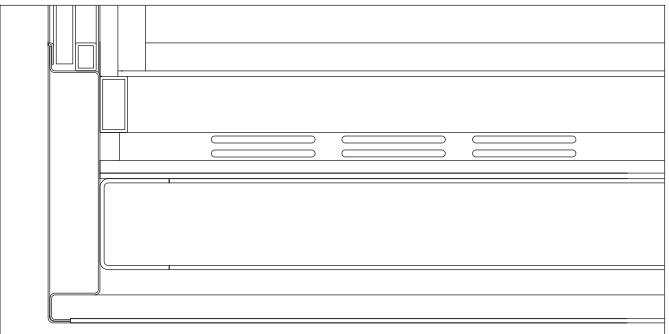

Vertical section: back wall / floor.
Skirting. Concealed, generally dimensioned car ventilation (air supply) under the skirting.



Detail	Description	Series	Accessories
Side walls	Laminated safety glass LSG, stainless steel, satin finish. Glass frames stainless steel, satin finish.	●	
Rear wall	Laminated safety glass LSG. Glass frames stainless steel, satin finish.	●	
Cab corners	Stainless steel, satin finish.	●	
Ceiling	Painted RAL 9016 traffic white. Concealed, generously dimensioned cab ventilation at cabin depth in both side walls.	●	
Lighting	LD5X LED illuminated ceiling, direct, indirect and glare-free illumination. LED neutral white. Illuminated frame made of laminated safety glass, semi-transparent, white acrylic glass side, high-gloss, semi-transparent. Central area made of laminated safety glass, semi-transparent. ¹²⁾	●	
	LD5X LED RGB illuminated ceiling with RGB colour and light control. ¹²⁾		○
	LD7 LED ceiling light, indirect and glare-free illumination. LED neutral white. Shade, varnished metal, brilliant white. Filter disk and illuminated frame made of white acrylic glass, semi-transparent.		○
	LD7 LED RGB ceiling light. LED neutral white, LED RGB with colour and light control ¹⁾		○
	LD8 LED illuminated ceiling, direct and glare-free illumination. LED neutral white. Aluminium frame, brilliant white. Light surface made of white plastic, semi-transparent. ¹²⁾		○
	LD8-LED-RGB illuminated ceiling. LED neutral white, LED-RGB with colour and light control. ^{1), 12)}		○
Floor	Granite, light grey	●	
	Lowered cab floor for installed floor covering. ²⁾		○
Skirting rail	Stainless steel, satin finish. Concealed, generously dimensioned cab ventilation.	●	
Protection rails	Stainless steel, satin finish, side wall ø 33.7 mm. Handrail holder stainless steel, solid. Corner connection stainless steel welded with finishing grinding. Handrail ends: Stainless steel.		○
Handrail	Stainless steel, satin finish, suitable for the handicapped to DIN EN 81-70 ³⁾ , rear wall, side walls ø 33.7 mm. Handrail holder stainless steel, solid. Corner connection stainless steel welded with finishing grinding. Handrail ends: Stainless steel.	●	
Operating panel Cab	Stainless steel, satin finish, concealed attachment. Information panel acrylic glass, white, light frame acrylic glass, white, satin finish. Display high-resolution TFT. Short-travel buttons, flush, round, button surface stainless steel, call acceptance blue LED, symbols plastic, light grey.	●	
	Stainless steel, satin finish, suitable for the handicapped to DIN EN 81-70 ³⁾ Appendix B, horizontal, concealed attachment. Separate information panel. Large, raised buttons, round, button surface stainless steel, call acceptance blue LED, symbols raised, tactile, plastic, light grey. ⁴⁾		○
Nameplates	Nameplates in control panel NS2 ¹³⁾ Stainless steel, satin finish, concealed attachment, set flush in operating panel. Replaceable. Dark grey engraving.		○
Cab portal	Stainless steel, satin finish.	●	
Cab door	Full glass door. Laminated safety glass, stainless steel, satin finish, centre-opening ⁵⁾ , door height 2.100 mm. ⁶⁾	●	
	Full glass door, two-piece, opening one side.		○
	Glass frame door. Laminated safety glass, stainless steel, satin finish.		○
	Steel plate door, stainless steel, satin finish.		○

Detail	Description	Series	Accessories
Door drive	Energy-saving regulated drive with intelligent travel measurement.	●	
Door monitoring	2-D safety light grid over full door height.	●	
	3-D safety light grid with vestibule monitoring.		○
Shaft doors	Full glass door. Laminated safety glass, stainless steel, satin finish ⁷⁾ , centre-opening ⁸⁾ , door height as for cab door.	●	
	Full glass door, two-piece, opening one side.		○
	Glass frame door. Laminated safety glass, stainless steel, satin finish. ⁷⁾		○
	Steel plate door, primed, stainless steel, satin finish, stainless steel lines. ⁷⁾		○
	Wall bezel settings M1, primed, stainless steel, satin finish, stainless steel, linen. ⁷⁾		○
Operating panel Shaft doors	Portals: P1 primed, stainless steel, satin finish, stainless steel lines. Color Glas [®] . P7-G laminated safety glass. ⁷⁾		○
	Stainless steel, satin finish, mounted in door frame, concealed attachment. Skirting frame acrylic glass, white. Display blue LED. Short-travel buttons, inset flush, button surface stainless steel, call acceptance blue LED, symbols plastic, light grey.	●	
	Positioned in the portal or masonry, easier accessibility to DIN EN 81-70, cover plate screw-fitted.		○
	Large buttons, suitable for the handicapped to DIN EN 81-70 Appendix B, panel width 80 mm. ⁸⁾		○
Controls	Single-button collective control in state-of-the-art bus technology. Fast orientation and prevention of failed rides for short waiting times and high transportation capacity. Service access frame at last stop, primed 9). Overload control. Frequency control for load-independent travel curves and flushness. Battery-buffered, load-dependent emergency rescue to the next stop.	●	
	Emergency power and evacuation functions. Access control systems. Penthouse control. Priority carriage with key switch. Floor announcement. Travel direction displays and acoustic signals to DIN EN 81-70. Interfaces to building control systems.		○
	Service access frame made of stainless steel, satin finish, stainless steel linen.		○
	Service access frame at any stop or service panel in neighbouring rooms. ⁹⁾		○
	Collective two-button control, collective group control.		○
Emergency call system	Digital emergency call and diagnosis system to EN 81-28 for emergency call transmission to the continually-manned Schmitt+Sohn Service Centre. Electronic misuse suppression. ¹⁰⁾	●	
	Video misuse identification for the digital emergency call and diagnosis system. ¹⁰⁾		○
	Remote monitoring of elevator attendant functions, transmission of diagnosis data, GSM module. ¹⁰⁾		○
Shaft	Sound separation (decoupling) element of the drive to reduce structure-borne transfer for increased requirements to DIN 8989 ¹⁴⁾		○
Drive	Gearless cable drive in shaft. High efficiency and low energy consumption. Load transfer via guide rails into the shaft pit. Speed 1.0 and 1.6 m/s, travel height up to 40 m.	●	
Elevator gear	Special elevator suspension ropes, very smooth running, maintenance free. No electronic monitoring required.	●	

Detail	Description	Series	Accessories
Energy-saving mode	Deactivation of cab light, fan and displays in the event of stoppage. On call entry, the assemblies switch themselves on again automatically. Potential saving of up to 70% of power consumption.	●	
Stand-by mode	Staggered shutdown of light grid, control and frequency control in the event of longer standstill (night mode).		○
Energy calculator	Production of energy efficiency forecasts to ISO 25745.		○
Shaft smoke extraction	X-TRAC: heat loss reduction system via shaft ventilation. Electrically controlled window, rooflight dome or ventilation hood.		○
Intermediate circuit collective switching.	Reciprocal energy feed in case of opposite movement direction of cabs in one group. ¹¹⁾		○

- 1) In RGB mode, reduction of the brightness in the cab is possible.
- 2) Maximum 75 kg/m² and 30 mm thickness.
Changes in colour shades are possible depending on the floor covering.
- 3) Agreement required between the customer and Schmitt+Sohn on proper use.
- 4) Not for 450 kg capacity.
- 5) Q ≤ 1,000 kg, two-piece doors opening centrally
Q > 1,000 kg, four-piece doors opening centrally
- 6) 2,000mm with reduced shaft head of 2,700 to 2,800 mm.
- 7) Service access frame analogous to shaft door.
- 8) Operating panel stainless steel, satin finish, 2 mm thick.
- 9) Observe possible fire safety requirements in necessary stairwells.
- 10) Redirection to the Schmitt+Sohn Service Centre and permanent on-call readiness is agreed in a separate service contract.
- 11) On request.
- 12) Multi-piece illuminated ceiling/s at Q ≥ 1,000 kg.
- 13) Only for 2-5 stops, floor buttons in single row.
- 14) Building shell requirements in accordance with DIN 8989 must be observed on-site.

We will be happy to assist you with your planning.

Please contact us.
Subject to technical amendment.



Glass Panorama Elevator GP 2, load capacity 1,000 kg

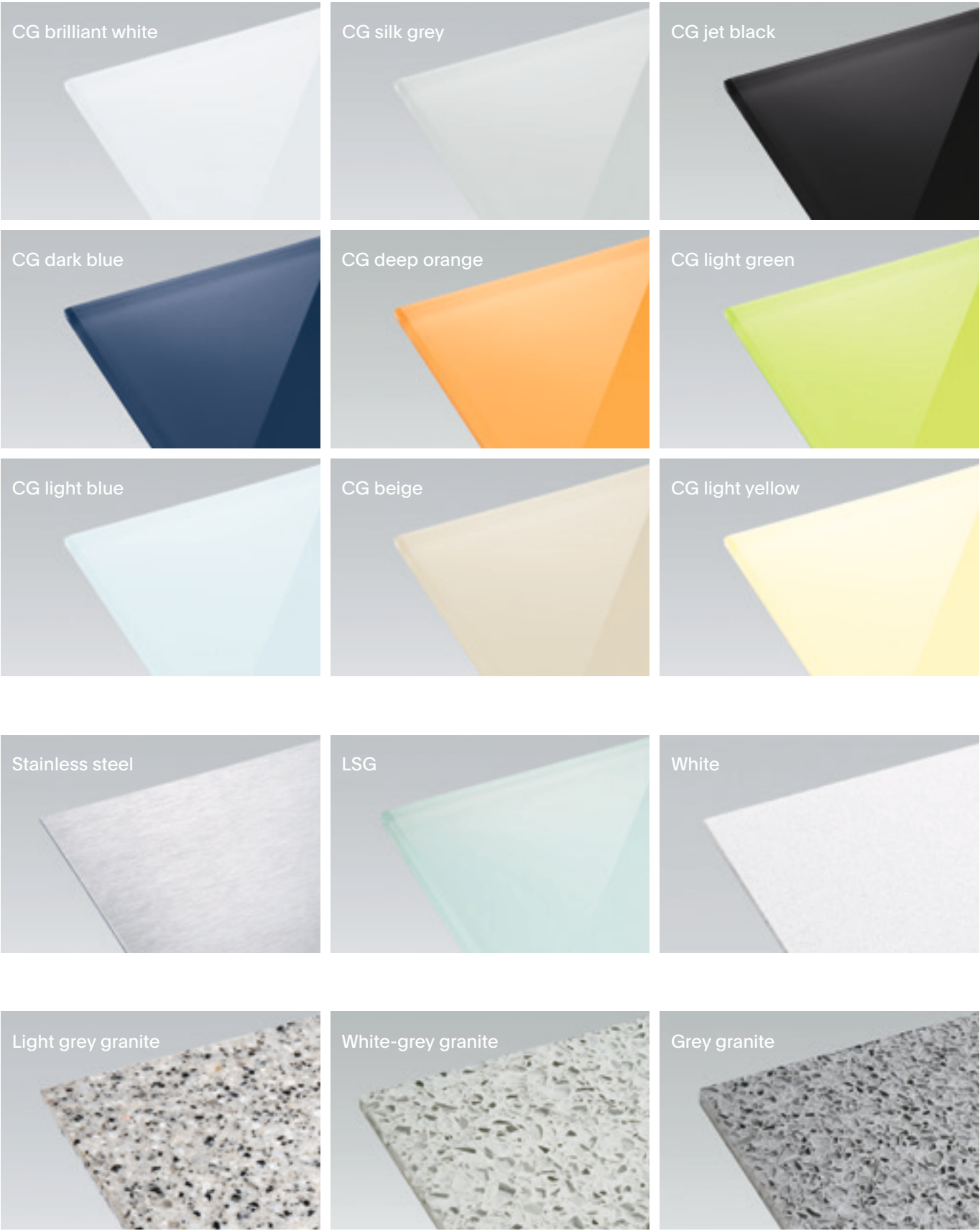



GP 9 CG beige

Materials - Colours - Surfaces



GP 1 Stainless steel



GP 2 CG brilliant white



GP 3 CG silk grey



GP 4 CG jet black



GP 5 CG dark blue



GP 6 CG deep orange



GP 7 CG light green



GP 8 CG light blue



GP 9 CG beige



GP 10 CG light yellow

GP 630 kg



GP 6 CG deep orange

Materials - Colours - Surfaces



GP 1 Stainless steel



GP 2 CG brilliant white



GP 3 CG silk grey



GP 4 CG jet black



GP 5 CG dark blue



GP 6 CG deep orange

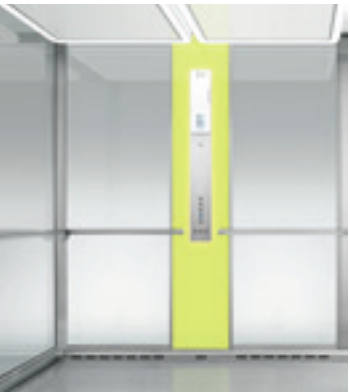

GP 7 CG light green



GP 8 CG light blue



GP 9 CG beige

GP 1,000 kg



GP 10 CG light yellow



Car exterior

Fully glazed:	Laminated safety glass
Car outer panelling:	Fine polished stainless steel, concealed fixing
Ceiling guard rail:	Fine polished stainless steel
Standing area:	Aluminium stud plate, full surface
Traverses and traction angle:	painted
Door drive:	painted



- Car and landing door with wall connection T1
- | | |
|-------------------------------|---|
| Doors: | Two-piece, centrally opening sliding doors, all-glass doors
Laminated safety glass |
| Door frame / wall connection: | Fine polished stainless steel |
| Control panel: | Fine polished stainless steel, acrylic glass |
| Buttons: | Fine polished stainless, flush-mounted |
| Call acknowledgement: | Blue LED |
| Symbols: | Light grey plastic |

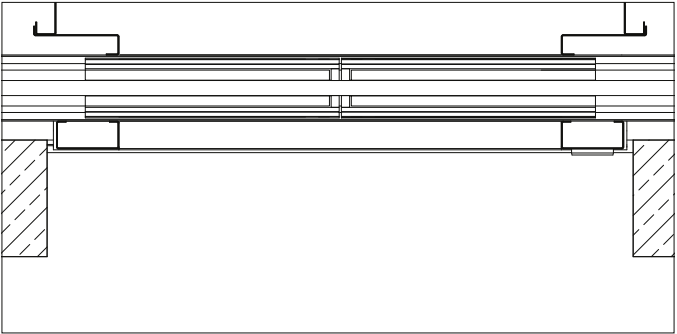

Horizontal section: car and landing door with doorframe / wall connection T1.



Car and landing door with
wall connection T1
Door sills

Wall connection T1 with service frame

Doors: Two-piece, centrally opening
sliding doors
Door frame /
wall connection: Fine polished stainless steel
Door sills: Aluminium

Service frame: Fine polished stainless steel

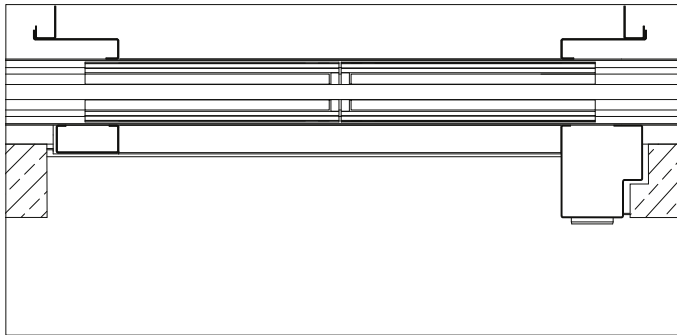

Horizontal section: centrally opening door / service frame



Car and landing door with
wall connection T1, service frame
Door sills

Control panel BT-TP-CG-1

Doors: Two-piece, centrally opening
Sliding doors
Door frame /
wall connection: Fine polished stainless steel
Service frame: Fine polished stainless steel
Door sills: Aluminium

Dimensions: HWD 400 x 66 x 6 mm
Control panel: Fine polished stainless steel
Baseframe: Acrylic glass, white
Information panel: Acrylic glass, blue
Display: Blue LED
Buttons: Fine polished stainless,
flush-mounted
Call acknowledgement: Blue LED
Symbols: Light grey plastic

GP ACCESSORIES FOR INDIVIDUAL REQUIREMENTS

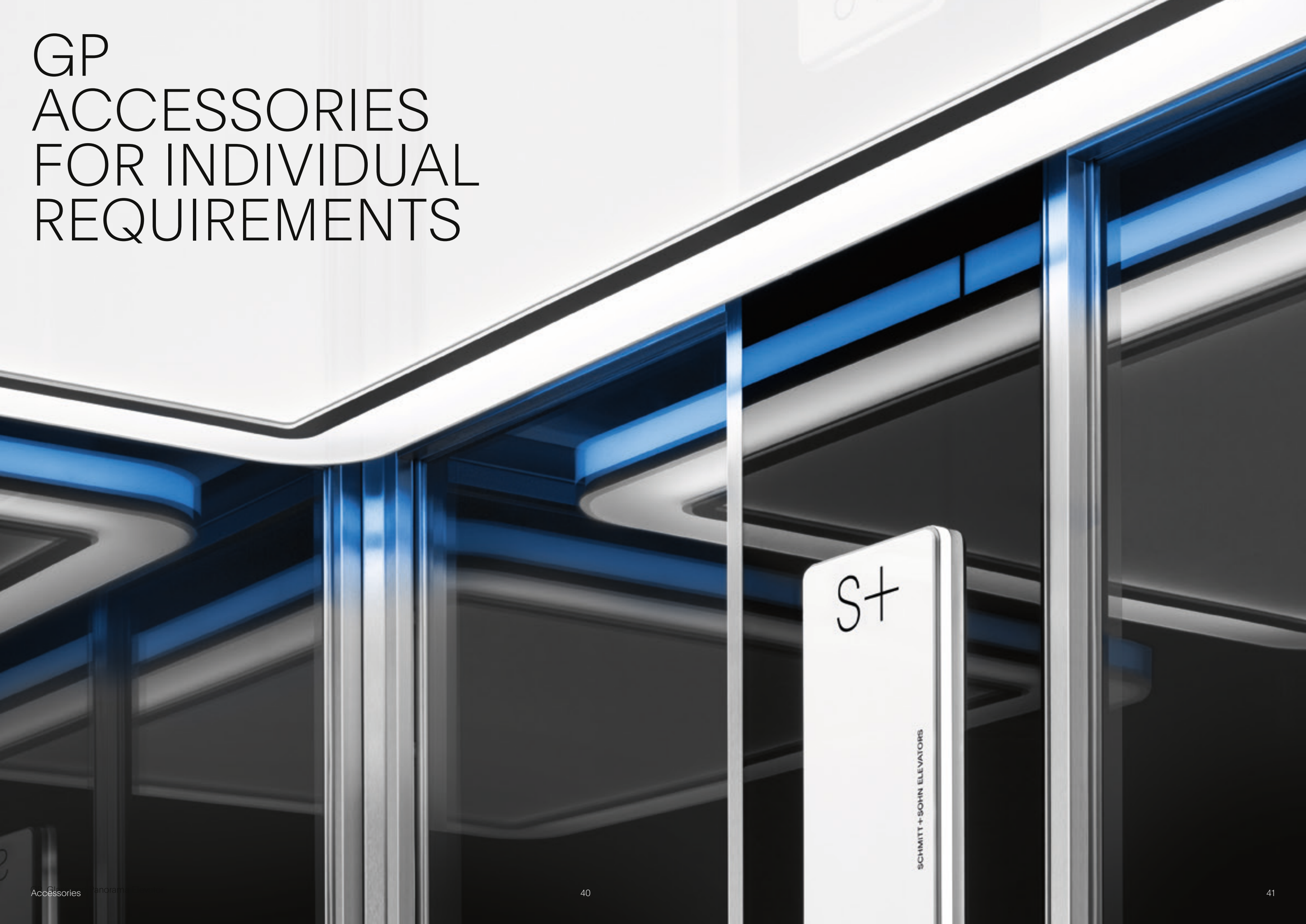



Nameplates NS2

Dimensions: HW 30 x 81 mm
 Nameplates: Fine polished stainless steel
 Individually replaceable
 Lettering: Engraved, dark grey

GP LIGHTDESIGN

THE 4TH DIMENSION
OF ARCHITECTURAL
DESIGN.





GP Glass Panorama Elevator with LD5X-LED-RGB illuminated ceiling.

- Dimensions: HWD 100 x 940 x 1,320 mm*
edge distance to side walls 80 mm each, to
entrance side and back wall 40 mm each.
- Lamps: Power-LED
- Accessories: LED-RGB colour control
- Illuminated
frame: LSG, semitransparent, LED illuminated,
neutral white, side acrylic glass, white,
high-gloss, semitransparent
- Light
surface: LSG, semitransparent,
LED illuminated

* Example dimensions for car size,
width 1,100 mm x depth 1,400 mm

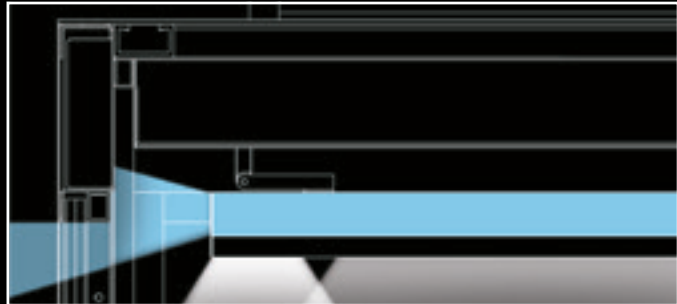

Vertical section: LD5X-LED-RGB illuminated ceiling
Functional diagram: direct-indirect lighting
Neutral white LED / light colour as required

LD5X-LED-RGB illuminated ceiling

Schmitt+Sohn offers excellent light solutions for ele-
vator cars using perfected LED technology; the aim is
to achieve comfort-orientated and generously dimen-
sioned room moods. The light design of the elevator
cars follows the requirements for efficient and accen-
tuated architectural lighting. Vertical light plays a
prominent role in architecture. Schmitt+Sohn trans-
forms this particular light guide into an independent
and excellent light design. The newly developed LED
illuminated ceiling LD5X sets standards with its design
and functional features.

Through intelligent LED-RGB colour controls, diverse
attractive designs are possible with light.
Colours, colour changes and colour rhythms can be
combined effectively.
Thus, creating convincing, inspiring and unusual light
moods in the elevator car.
The colours change in the illuminated frame of the car
lighting. The side light cut-off is amplified optically by
reflection on the car ceiling. The very good back-
ground brightness in the car is generated by the pow-
erful white LED illuminated frame and the LED middle
area.

Light staging can be programmed to customised,
design or functional requirements. Applications are,
for example:
Simulation of a natural daylight pattern.
Generating light moods,
Coloured storey visualisation



GP Glass Panorama Elevator with LD5X-LED-RGB illuminated ceiling.



GP Glass Panorama Elevator with LD7-LED-RGB ceiling light.

LD7-LED ceiling light
LD7-LED-RGB ceiling light

Due to intelligent RGB colour controls, Schmitt+Sohn light design enables a large number of attractive designs with light. Colours, colour changes and colour rhythms can be combined effectively. Thus creating convincing, inspiring and unusual light moods in the elevator car.

The colours change in the illuminated frame of the car lighting. The side light cut-off is amplified optically by reflection on the car ceiling. The very good background brightness in the car is generated by the white LED illuminated frame in the middle.

Light staging can be programmed to customised, design or functional requirements. Applications are, for example:
Simulation of a natural daylight pattern
Generating light moods,
Coloured storey visualisation

- Dimensions: HWD 12 x 132 x 1,260 mm*
- Lamps: Power LED
- Accessories: LED-RGB colour control
- Illuminated frame: Acrylic glass, white, satin finish, semitransparent
- cover: Metal painted brilliant white
- Filter disc: Acrylic glass, white, semitransparent

* Example dimensions for car size, width 1,100 mm x depth 1,400 mm

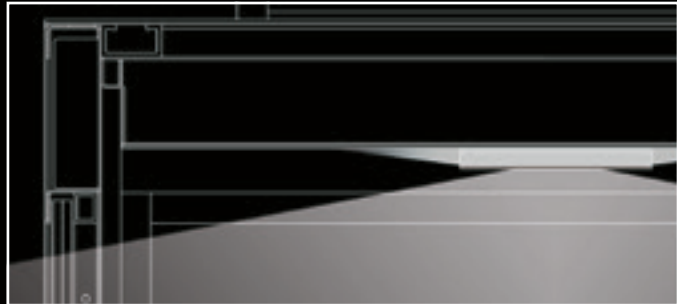

Vertical section: LD7-LED ceiling light
Functional diagram of direct and indirect lighting
Neutral white LED

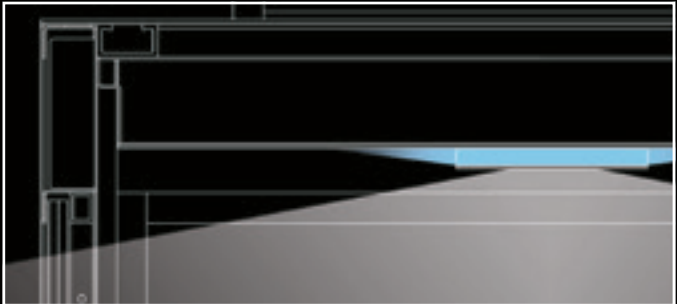

Vertical section: LD7-LED-RGB ceiling light
Functional diagram of direct and indirect lighting
Neutral white LED / light colour as required





GP Glass Panorama Elevator with LD8-LED illuminated ceiling.

- Dimensions: HWD 38 x 940 x 1,300 mm*
 HWD 50 x 940 x 1,300 mm* (LD8-LED-RGB)
 Edge distance to side walls 80 mm each, to the entrance side and back wall 50 mm each.
- Lighting: power LED, neutral white
- Accessories: LED RGB color control
- Frame: aluminium, brilliant white
- Light surface: plastic, white translucent, B1 flame-resistant

* Example dimensions for car size, width 1,100 mm x depth 1,400 mm

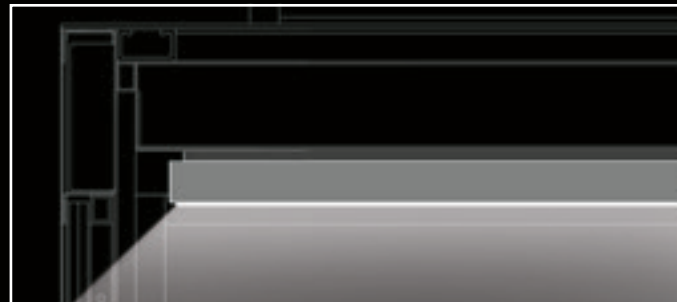

Vertical section: LD8 LED illuminated ceiling
 Functional diagram: direct lighting
 Neutral white LED

Accessories:

LD8-LED illuminated ceiling LD8-LED-RGB illuminated ceiling

Maximum functionality, puristic design and brilliant light technology characterise the completely new type of LD8 LED illuminated ceiling. The main functional features include the homogeneous, neutral white light area and the very flat structure of the LD8.

The especially developed frame geometry not only achieves a virtually frameless light surface – it also gives the LD8 a very delicate appearance. The interior of the elevator car appears generously roomy and elegant. Impressive colours and shapes are a feast for your eyes.

Intelligent LED RGB color control facilitates versatile and attractive lighting designs. Colors, color changes and rhythms can be combined with one another effectively.

This creates impressive, inspiring, and unusual lighting effects in the elevator cab.

Colors change in the illuminated frame of the cab lighting. The light coming from the side is visually amplified by the reflection on the ceiling of the cab. The powerful LED light panel in the car generates excellent brightness.

Lighting effects can be programmed based on customer-specific, design, or functional requirements.

Applications include, for instance:

- Simulating the natural progression of daylight
- Creating lighting moods
- Visualizing different floors in different colors

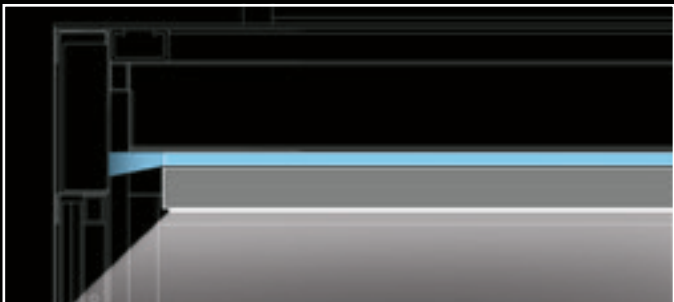

Vertical section: LD8-LED-RGB ceiling light
 Functional diagram of direct and indirect lighting
 Neutral white LED, LED-RGB lighting control.

Accessories:



GP Glass Panorama Elevator with LD8-LED-RGB illuminated ceiling.

51



Display panel AT-I-TFT-LED

Control panel EN 81-70-B

Dimensions:	HWD 180 x 500 / 600 x 99.5 mm
Control panel:	Fine polished stainless steel EN 81-70, Annex B
Buttons:	Fine polished stainless steel, extra large buttons, raised. Main access: Plastic ring, Green, raised. Alarm button: recessed
Call acknowledgement:	Blue LED
Symbols:	Light grey plastic, raised, tactile

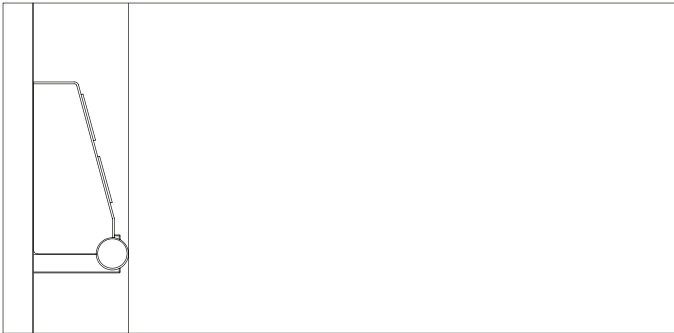

Vertical section: side wall, control panel EN 81-70-B.

Dimensions:	HWD 490 x 150 x 15 mm
Display panel:	Fine polished stainless steel
Illuminated frame:	Acrylic glass, white, satin finish, Neutral white LED
Information panel:	Acrylic glass, white
Display:	TFT high-resolution

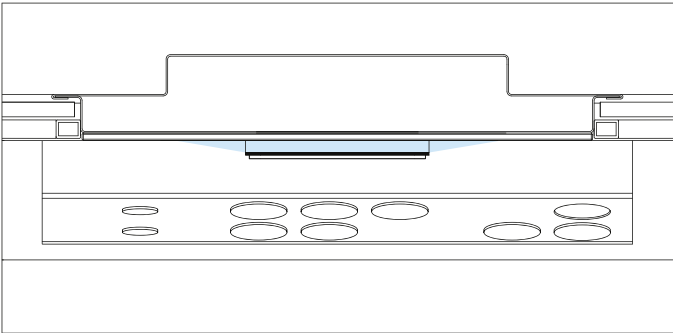

Horizontal section: side wall.
Control panel EN 81-70. Annex B. Surface-mounted
display panel. Illuminated frame light pattern.



Luggage protection strips

Profile: Fine polished stainless steel, \varnothing 33.7 mm
 Bracket: Fine polished stainless steel, solid material
 End pieces: Fine polished stainless steel

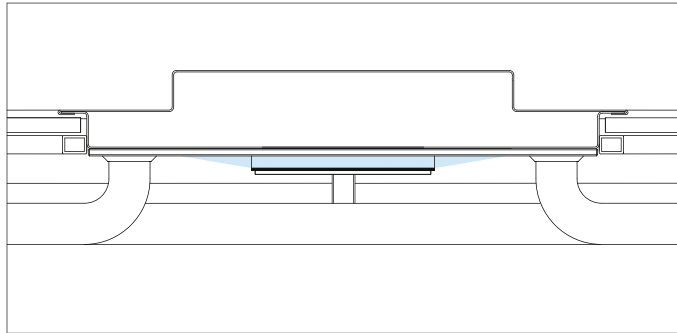

Horizontal section: side wall with surface-mounted control panel. Continuous luggage protection strips. Handrail curve.



Car and landing door with wall connection T1

Doors: Two-piece, centrally opening
 Sliding doors, primed sheet steel
 Accessories: Fine polished stainless steel
 Door frame / wall connection: Sheet steel, primed
 Accessories: Fine polished stainless steel
 Door sills: Aluminium

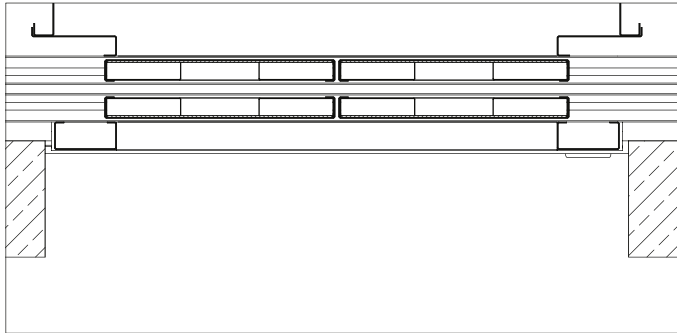

Horizontal section: car and landing door with doorframe / wall connection T1.



Car and landing door with wall connection T1 and wall surround M1

Wall surround: Sheet steel, primed
 Accessories: Fine polished stainless steel

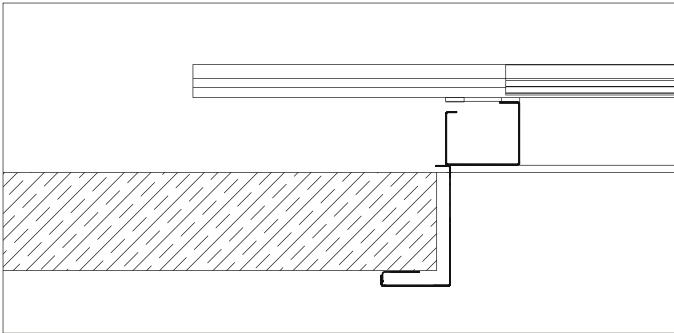

Horizontal section: landing door with wall surround.



Control panel BT-TP-CG-2
 Two-button and group control

Dimensions: HWD 400 x 66 x 6 mm
 Control panel: Fine polished stainless steel, concealed fixing
 Baseframe: Acrylic glass, white
 Information panel: Acrylic glass, blue
 Display: Blue LED
 Buttons: Fine polished stainless steel, flush, arrangement to EN 81-70
 Call acknowledgement: Blue LED
 Symbols: Light grey plastic

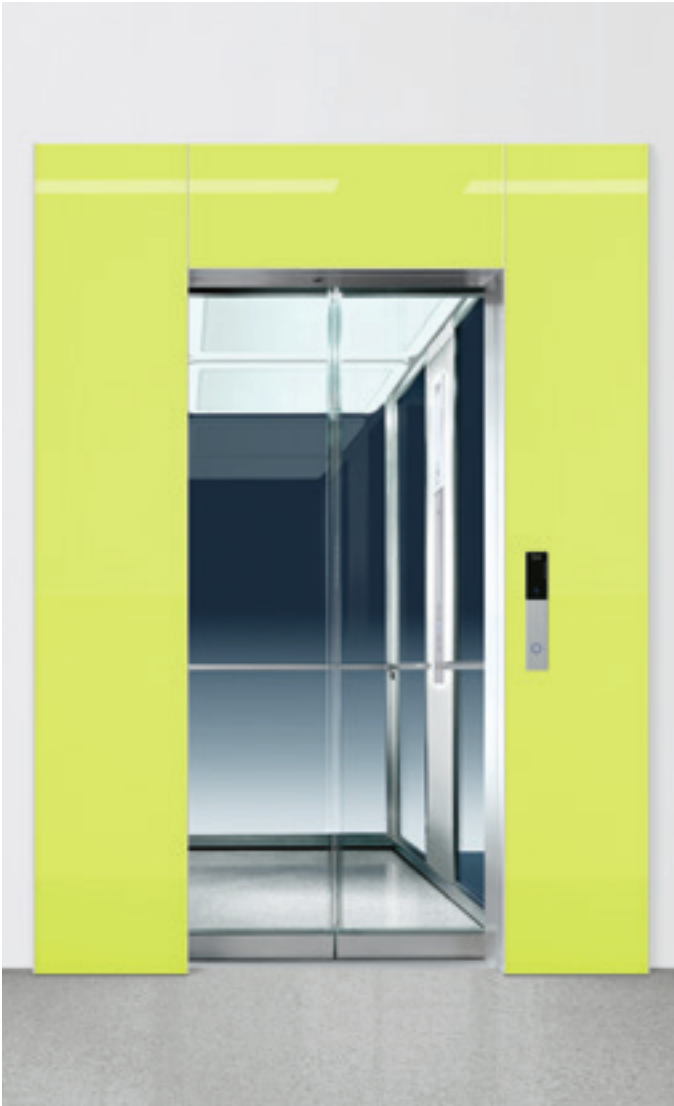

Color Glas® Portal

Portal: Color Glas®
Glass surround: Fine polished stainless steel



Stainless steel portal

Portal: Fine polished stainless steel

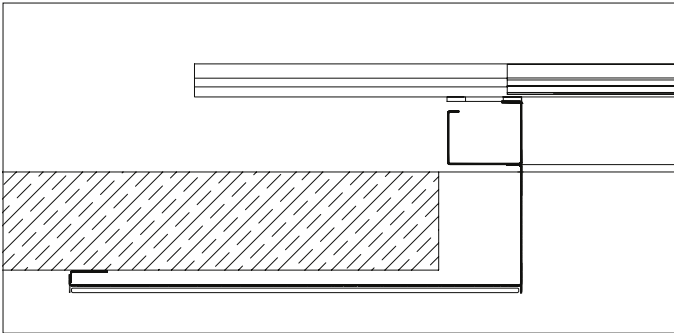

Horizontal section: landing door with doorframe / Color Glas® Portal

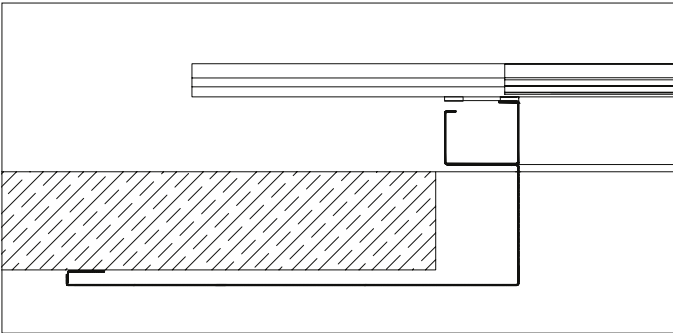

Horizontal section: landing door with door frame / stainless steel portal.



Glass portal P7-G

- Portal: Fully-glazed laminated safety glass LSG
Fine polished stainless steel
- Door: All-glass door
Laminated safety glass
Fine polished stainless steel
- Doorframe: Fine polished stainless steel
- Control panel: Fine polished stainless steel



Horizontal section: car and landing door,
All-glass door with glass portal P7-G



Glass portal P7-G

- Portal: Fully-glazed laminated safety glass
fine polished stainless steel
- Door: Glass frame door
Laminated safety glass LSG
fine polished stainless steel
- Doorframe: Fine polished stainless steel
- Control panel: Fine polished stainless steel

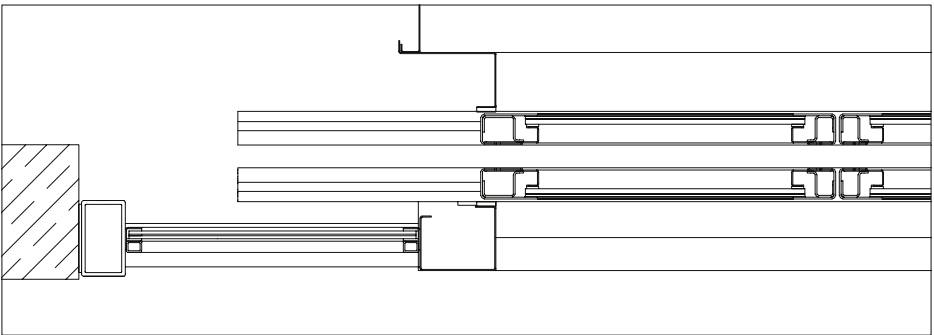

Horizontal section: Car and landing door,
Glass frame door with glass portal P7-G



Tubular hoist frame, square tube
Aluminium façade profile

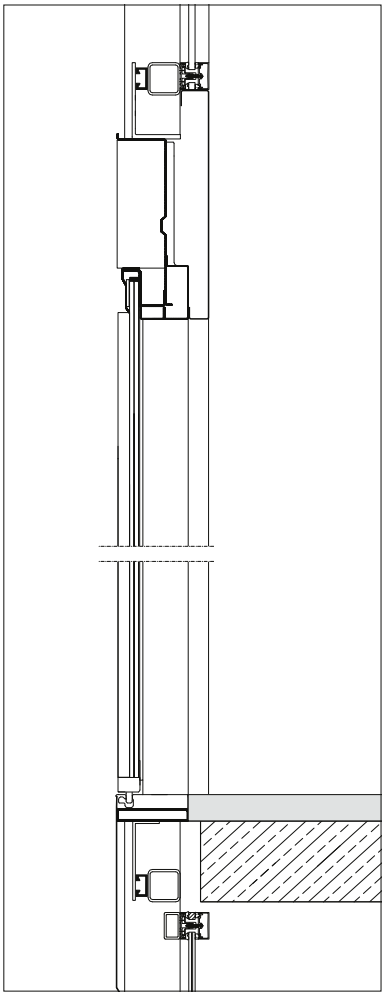

Vertical section

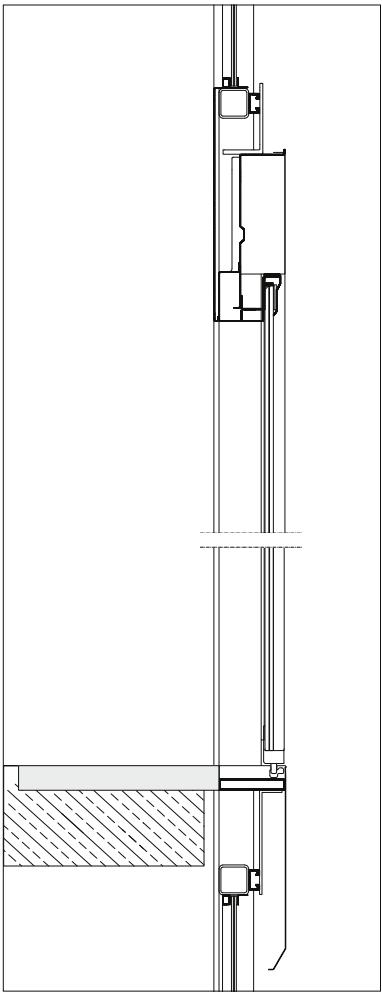

Vertical section



Tubular hoist frame, square tube
Glazing between the profiles

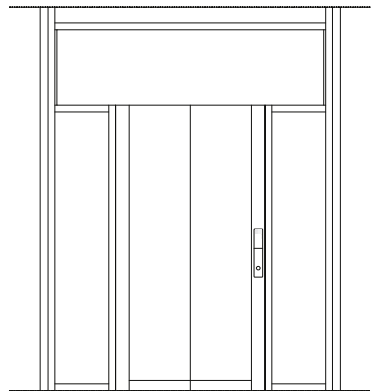

View of door portal

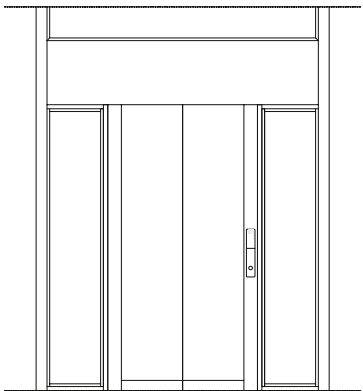

View of door portal



Horizontal section

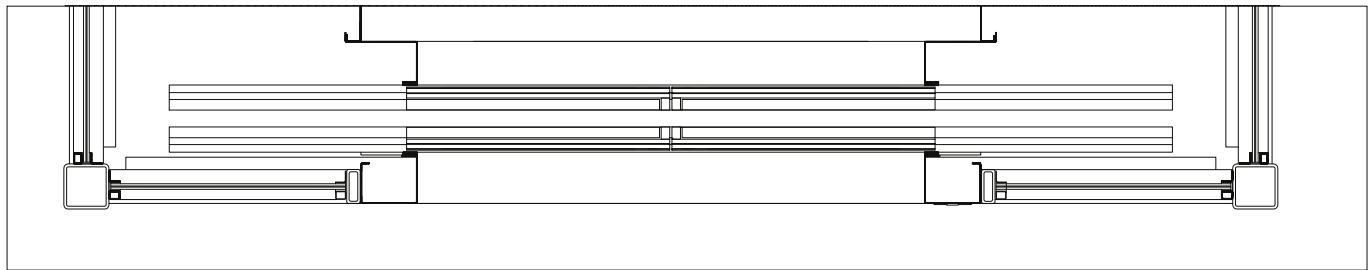

Horizontal section

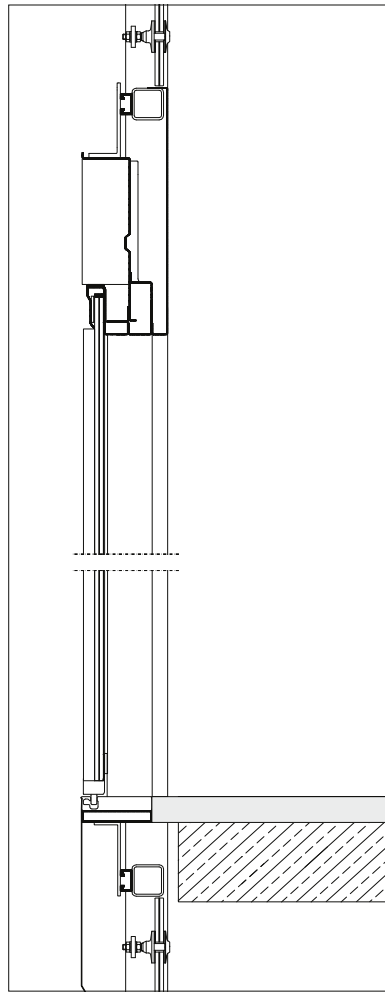

Vertical section

Tubular hoist frame, square tube
Point mount glass fixing,
Glazing between the profiles

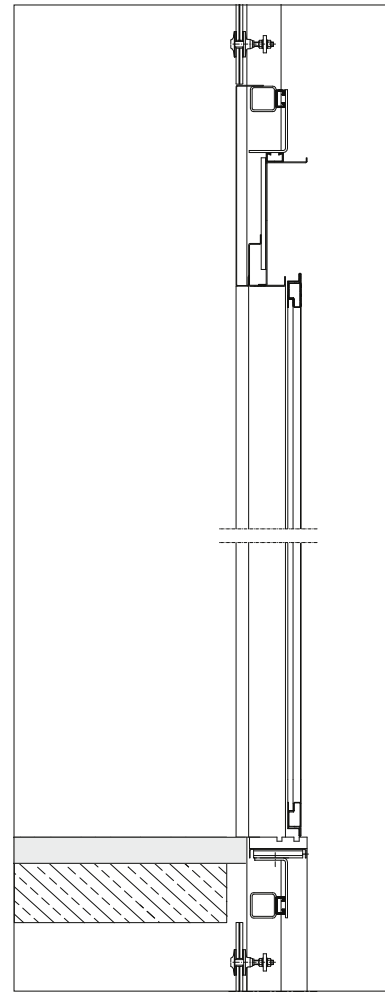

Vertical section



Tubular hoist frame, square tube
Point mount glass fixing,
Glazing in front of the profiles

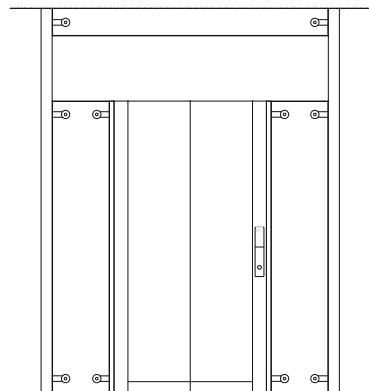

View of door portal

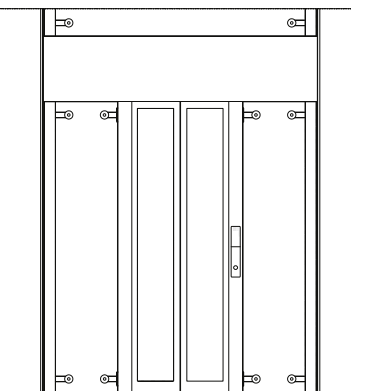

View of door portal

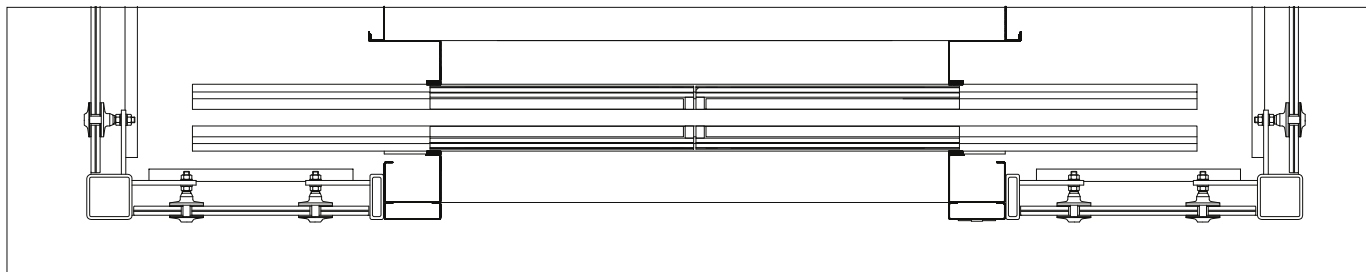

Horizontal section

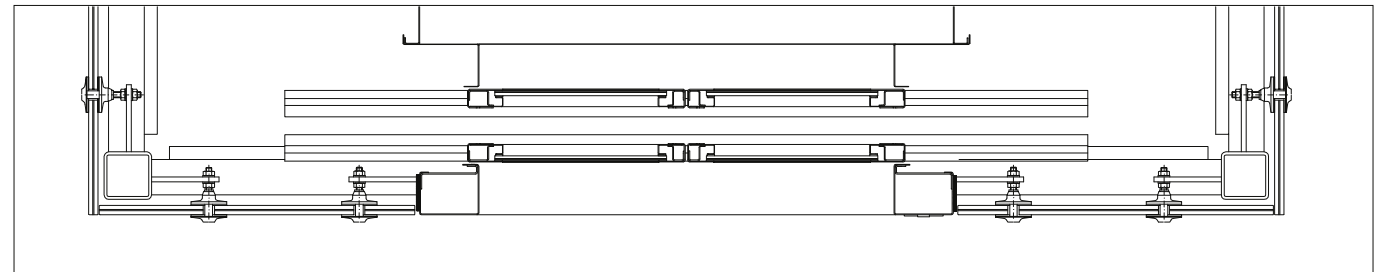

Horizontal section

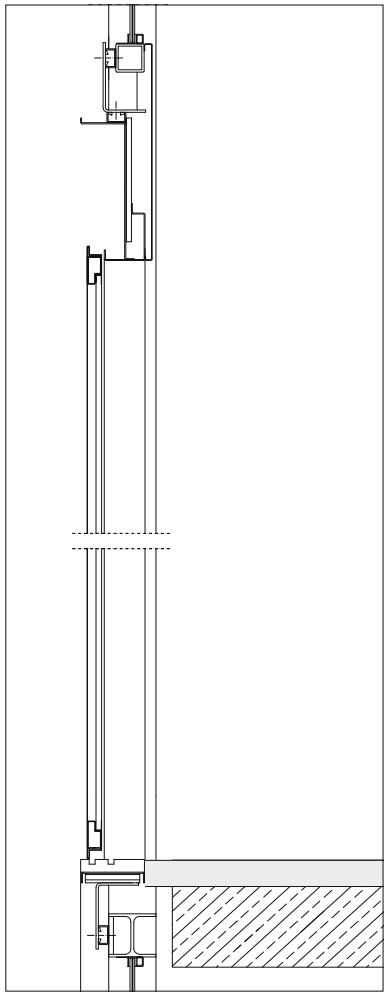
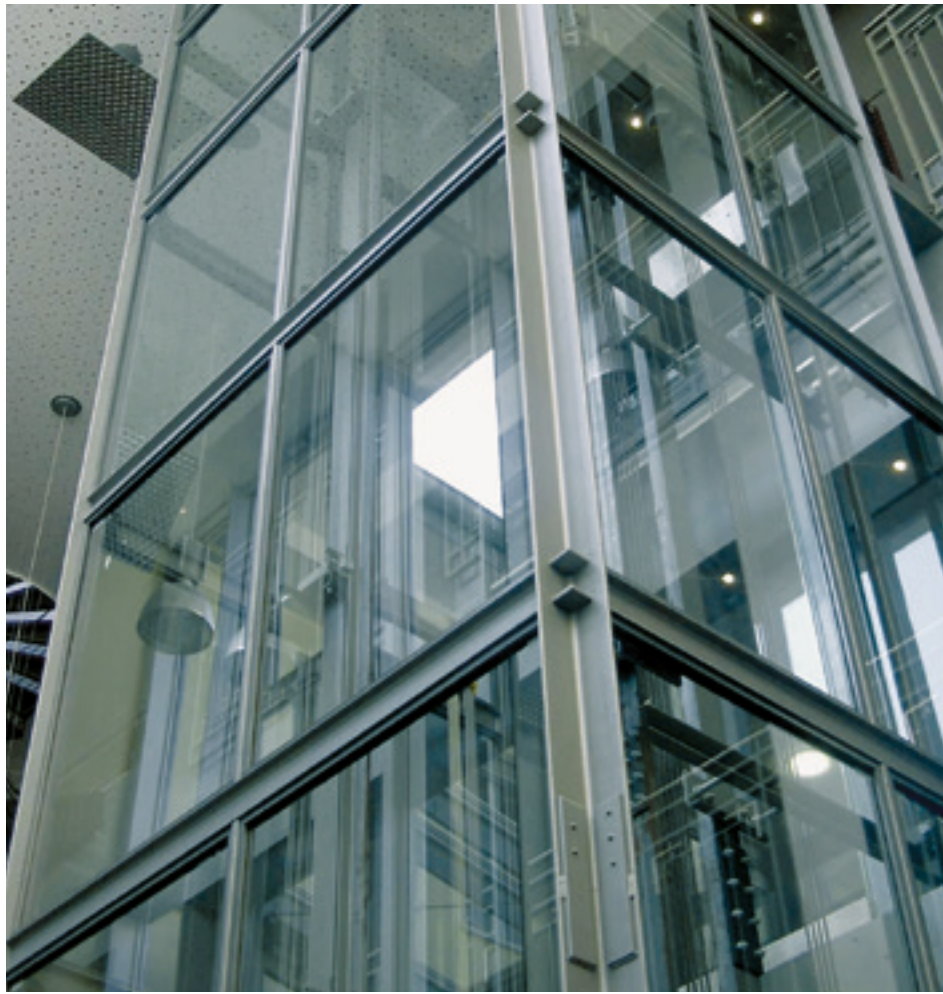

Vertical section

Angular hoistway frame
Angle outside

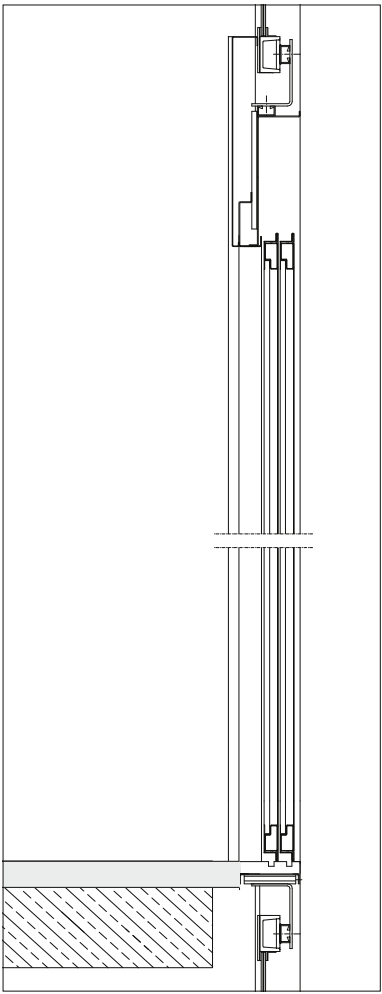

Vertical section



Angular hoistway frame
Angle inside

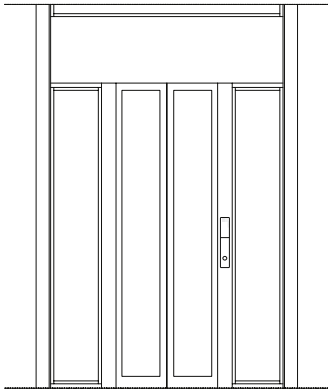

View of door portal

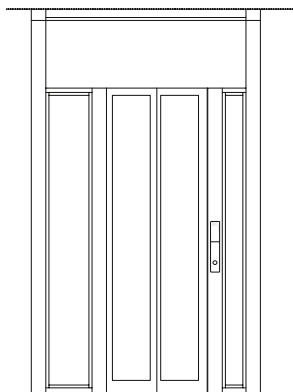

View of door portal

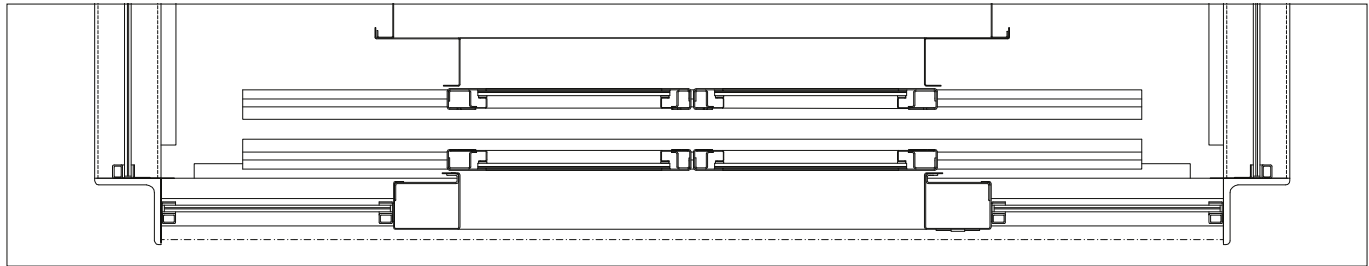

Horizontal section



Horizontal section

Responsibility

„One customer – one responsible project manager. The expectations we place on ourselves are exacting. For the customer, this means they always have a competent partner to handle all of their needs from the first planning meeting to acceptance by the building owner, throughout Europe.“

Florian Hensen, Head of Hamburg Branch



GP THE PLANNING

Shaft head (SK)
Cab height (KH)
Door height (TH)

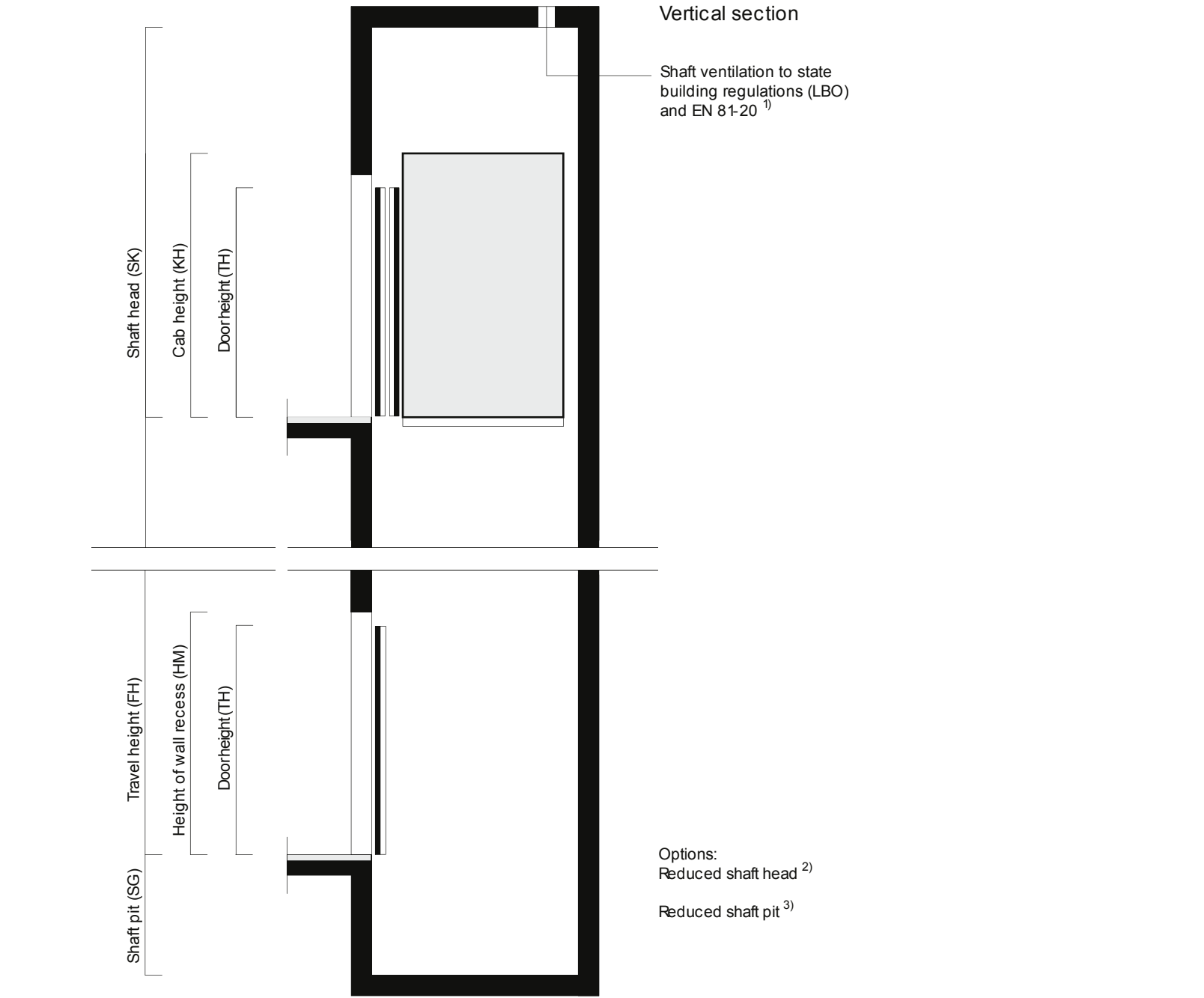

Floorplan

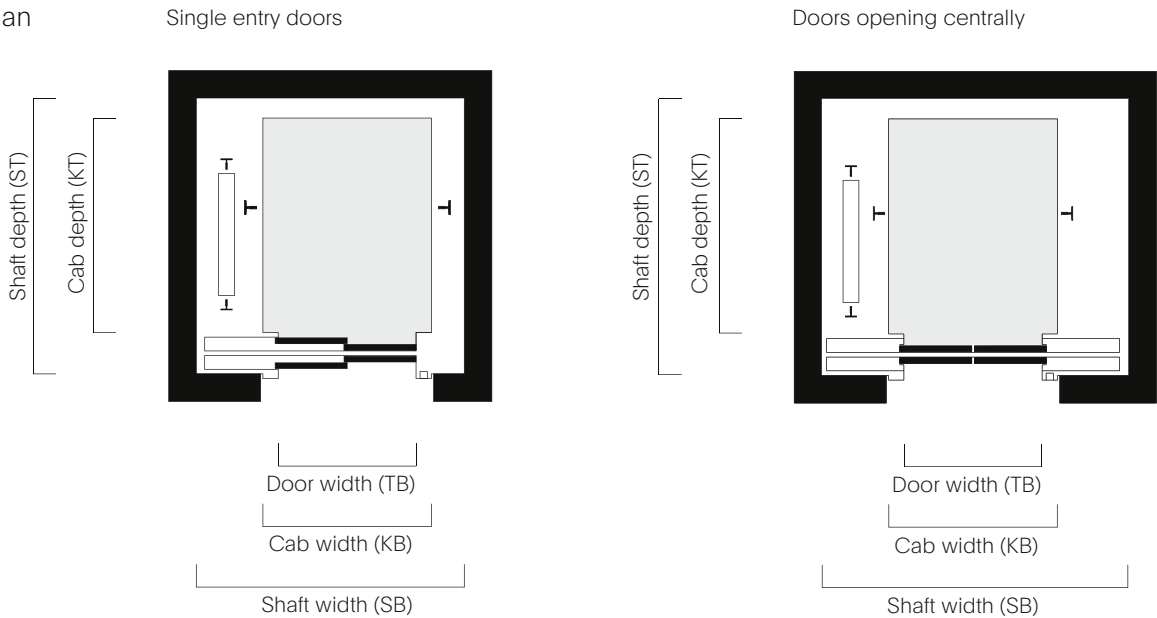

- 1) Compliance with the Buildings Energy Act (GEG) on site.
- 2) Reduced shaft head at v = 1.0 m/s:

For CH 2,200 mm
 - ≥ 3,000 to < 3,900 mm [Q ≤ 1,600 kg] technically possible with alternative measures.
 - ≥ 2,800 to < 3,000 mm [Q ≤ 1,000 kg] in consultation and technical clarification with alternative measures possible.
 - ≥ 2,700 to < 2,800 mm [Q ≤ 1,000 kg] CH 2,100 mm, DH 2,000 mm in consultation and technical clarification with alternative measures possible.

For CH 2,300 mm on request.

Note: there are different approvals for reduced shaft heads and shaft pits in individual countries. In some cases a reduction is not permitted. A clarification with the authorities responsible may be necessary.

We will be happy to support with your inquiries.

At v = 1.6 m/s on request
- 3) Reduced shaft pit:

≥ 500 mm [Q ≤ 1,000 kg] with 6 mm flooring and adhesive

≥ 650 mm [Q ≤ 1,000 kg] with 6 mm flooring and adhesive

At v = 1.6 m/s on request
- 4) Height of wall recess: HM = TH + 115 mm.
- 5) Shaft depth can be reduced by 120 mm by fitting the shaft doors in niches.
- 6) Shaft depth can be reduced by 240 mm by fitting the shaft doors in niches.
- 7) Doors opening on one-side/centrally.
- 8) For CH = 2,300 mm, SK + 100 mm.
- 9) CH = 2,200 mm for LD7 + LD8; CH = 2,300 mm forLD5X

We will be happy to assist you with the planning and tender.
Please give us a call.

Capacity in kg and persons		Cab dimensions in mm			Door dimensions		in mm		Shaft dimensions in mm			
kg	Persons	Width (KB)	Depth (KT)	Height (KH) ^{8) 9)}	(TB)	Height (TH) ⁴⁾	Width (SB)	Depth (ST)		Shaft pit (SG) ³⁾ v = 1,0 m/s / 1,6 m/s	Shaft head (SK) ^{2) 8)} v = 1,0 m/s / 1,6 m/s	
								Door one side ⁵⁾	Opposite entrances ⁶⁾			
450	6	1,000	1,250	2,200/ 2,300	800	2,100	1,660/1,900 ⁷⁾	1,600	1,790	1,050/1,250	3,900/4,100 ⁷⁾	
630	8	1,100	1,400	2,200/ 2,300	900	2,100	1,710/1,900 ⁷⁾	1,750	1,940	1,050/1,250	3,900/4,100 ⁷⁾	
675	9	1,200	1,400	2,200/ 2,300	900	2,100	1,810/1,950 ⁷⁾	1,750	1,940	1,050/1,250	3,900/4,100 ⁷⁾	
1,000	13	1,100	2,100	2,200/ 2,300	900	2,100	1,720/1,910 ⁷⁾	2,450	2,640	1,050/1,250	3,900/4,100 ⁷⁾	
1,600	21	1,400	2,400	2,200/ 2,300	1,200	2,100	2,280/2,160 ⁷⁾	2,750	2,940	1,100/1,300	3,900/4,100 ⁷⁾	

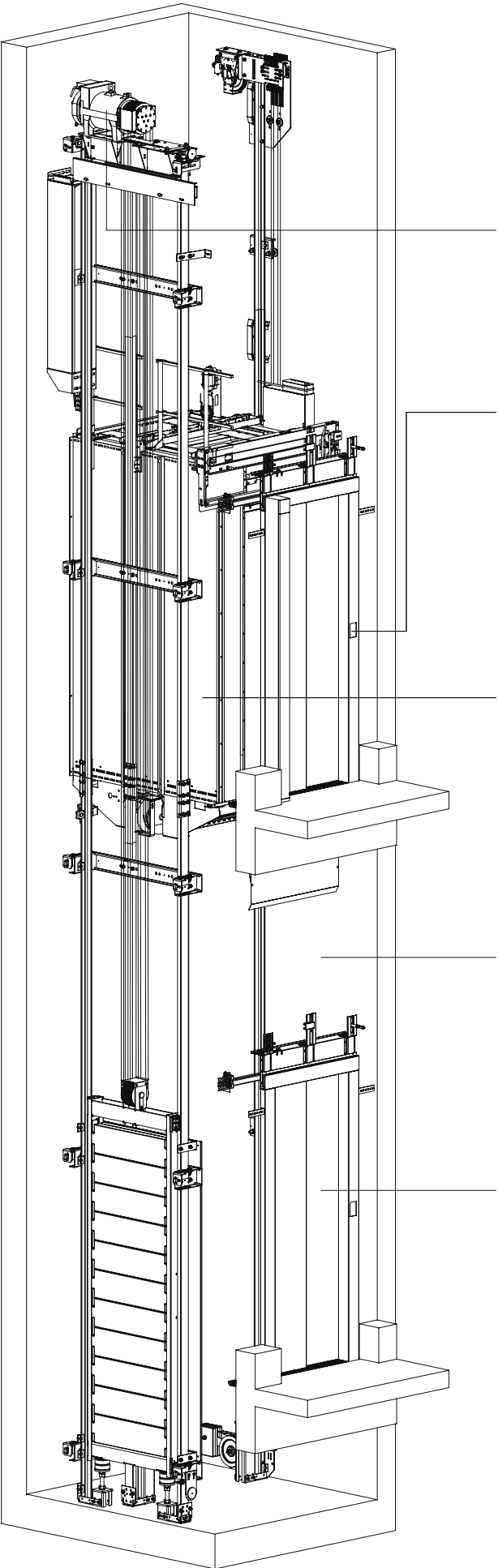

GP Glass Panorama Elevator
Type-tested elevator system
to EN 81

The drive:

- Comfortable: superior frequency-controlled drives
- Energy-saving: highly efficient drives ¹⁰⁾
- Quiet: Sound pressure level below the requirements of the standard. ¹²⁾
- Safe: Stopping accuracy better than the standard. ¹⁶⁾

The control:

- Ride comfort: Float with the Glass Panorama Elevator ¹⁷⁾
- Energy saving mode: Automatic shutdown of car light, fan and displays on standstill. ¹⁰⁾
- Standby mode: Staggered shutdown of control and frequency control for longer standstill. ¹⁰⁾
- LED technology: In control and display panels ¹⁰⁾
- Bus technology: Easy installation. Maintenance-friendly.

The car:

- Large: Maximum well utilisation in new and existing wells. ²⁻⁷⁾
- User-friendly: Fast orientation and easy operation.
- Light: Cabin lighting with vertical light, illumination of the side walls, indirect, glare-free. ^{14) 15)}
- Airy: Generously dimensioned ventilation (supply and exhaust) in the base and ceiling area. ¹⁸⁾
- Pleasant: materials, colours and surfaces.
- Gentle: horizontal and vertical acceleration with top values. ¹⁷⁾

The elevator well:

- Maximum car sizes: In new build and in existing buildings ²⁻⁷⁾
- Adaptable: Reduction of pits and headroom. ^{2) 3)}
- Well smoke control: System for reducing heat loss due to well ventilation with electrically controlled window, roof light or ventilation hood optional. ⁹⁾
- Quiet running: plastic sheathed specialised cable ¹²⁾

The doors:

- Comfortable: Adjustable travel curve ¹⁷⁾
- Safe: Light curtain with narrow detection range.
- Standby mode: Shut down light grid in case of longer standstill. ¹⁰⁾
- Flexible: Central, left or right-opening. One-sided or opposite
- Fire resistance: certified according to EN 81-58

Subject to change without notice.

Capacity in kg	Energy efficiency class ¹⁰⁾	Noise pressure level in dB (A)					
		In front of shaft doors		In the cab		In the shaft	
		DIN ¹¹⁾	GP Elevator ¹²⁾	DIN ¹³⁾	GP Elevator ¹²⁾	DIN ¹¹⁾	GP Elevator ¹²⁾
450	A	65	40	No specification	48	75	50
630/675	A	65	40	No specification	48	75	50
1,000	A	65	40	No specification	48	75	50
1,600	A	65	40	No specification	48	75	50

Capacity in kg	Brightness in Lux		Stopping accuracy in mm			
	1 m above cab floor		Stopping accuracy		Adjustment accuracy	
	EN 81 ¹⁴⁾	GP Elevator ¹⁵⁾	EN 81 ¹⁶⁾	GP Elevator	EN 81 ¹⁶⁾	GP Elevator
450	min. 100	min. 200	+/- 10	+/- 3	+/- 20	+/- 8
630/675	min. 100	min. 200	+/- 10	+/- 3	+/- 20	+/- 8
1,000	min. 100	min. 200	+/- 10	+/- 3	+/- 20	+/- 8
1,600	min. 100	min. 200	+/- 10	+/- 3	+/- 20	+/- 8

Capacity in kg	Smoothness in milli-G ¹⁷⁾		Air volume determination in terms of air exchange rate in m³/h	
	horizontal	vertical	DIN ¹⁸⁾	GP Elevator
450	11 +/- 1	11,2 +/- 1	14	39
630/675	11 +/- 1	11,2 +/- 1	17	53
1,000	11 +/- 1	11,2 +/- 1	25	66
1,600	11 +/- 1	11,2 +/- 1	42	110

10) VDI 4707, Elevators - energy efficiency.
In usage category 2 the Glass Panorama Elevator achieves energy efficiency class A.

11) DIN 8989, Acoustical design in buildings - Elevators.
Structural sound insulation must be used to ensure compliance with DIN 4109 on the basis of DIN 8989. Structural sound insulation measures must be taken into consideration during the planning process. Acoustic consulting is recommended.

12) The sound pressure level indicated refers to a Glass Panorama elevator in a concrete shaft with a mass per unit area in accordance with DIN 8989.

13) DIN 8989 does not stipulate a reference value.
The sound pressure levels only stipulate the level of comfort for the user.

14) DIN EN 81-20, Safety regulations for the construction and installation of elevators. Requirement: Minimum lighting intensity 1 m above cab floor and the controls: 100 Lux.

15) Further maximum values up to 350 Lux are possible, depending on the selected lighting and equipment.

16) EN 81-20.
Adjustment accuracy: At level differences ≥ 20 mm when loading and unloading, the elevator is adjusted and must regain the prescribed stopping accuracy.

17) ISO 18738, Elevators - Measurement of passenger comfort of elevators, describes the measurement procedure.

18) DIN 1946 Part 1 and 2: Cab volume x 5.

450/6

450 kg load capacity 6 persons

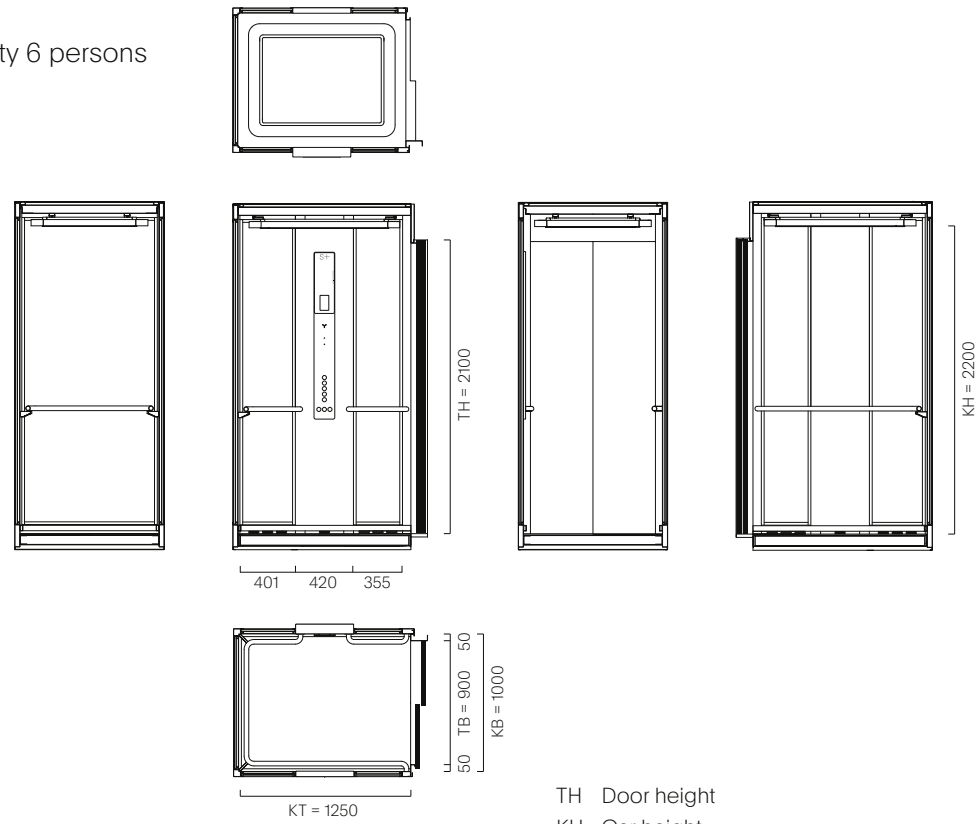

TH	Door height
KH	Car height
KB	Car width
KT	Car depth

630/8

630 kg load capacity 8 persons

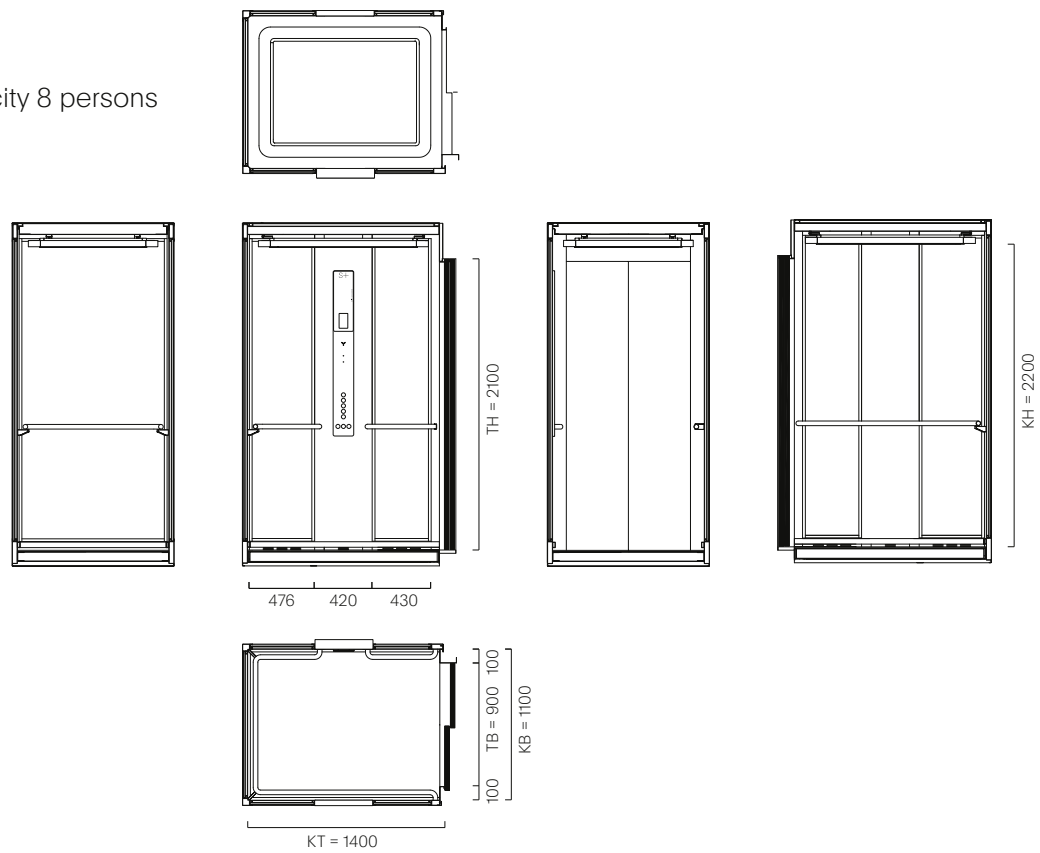

1000/13

1,000 kg load capacity 13 persons

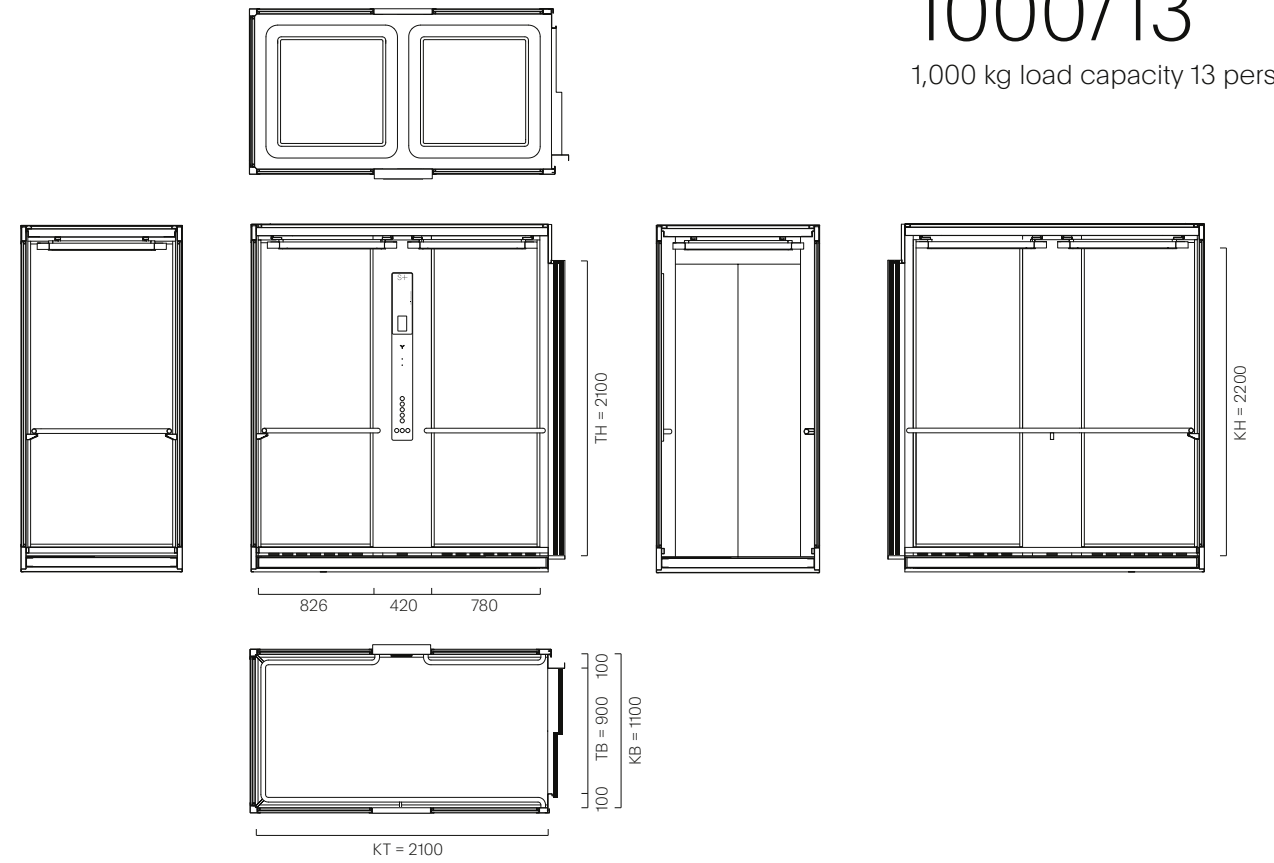

1600/21

1,600 kg load capacity 21 persons

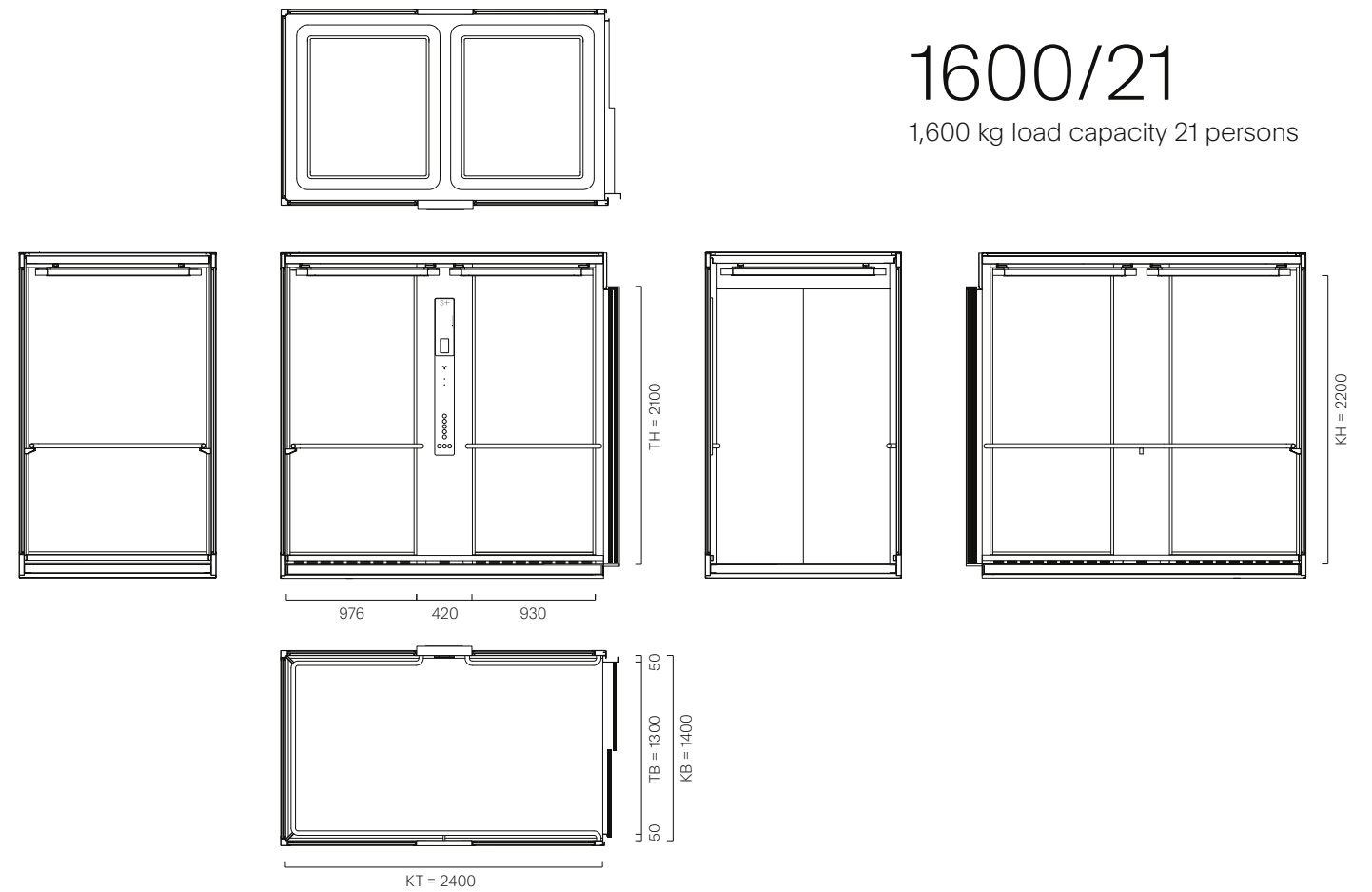

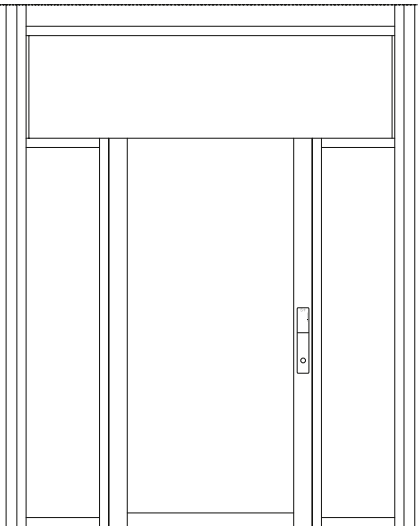

Aluminium façade profile

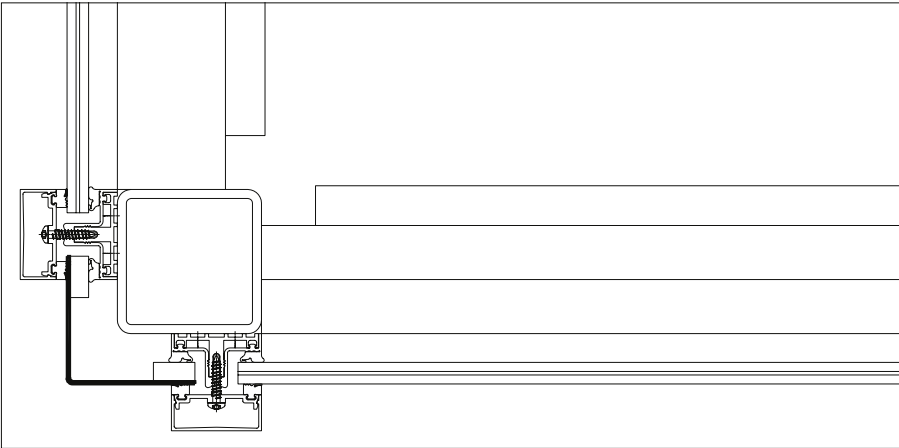

Glazing between the profiles

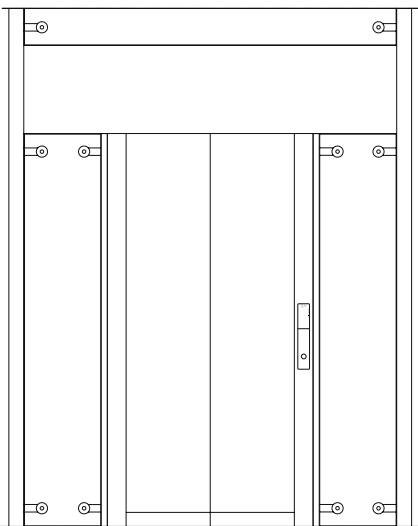
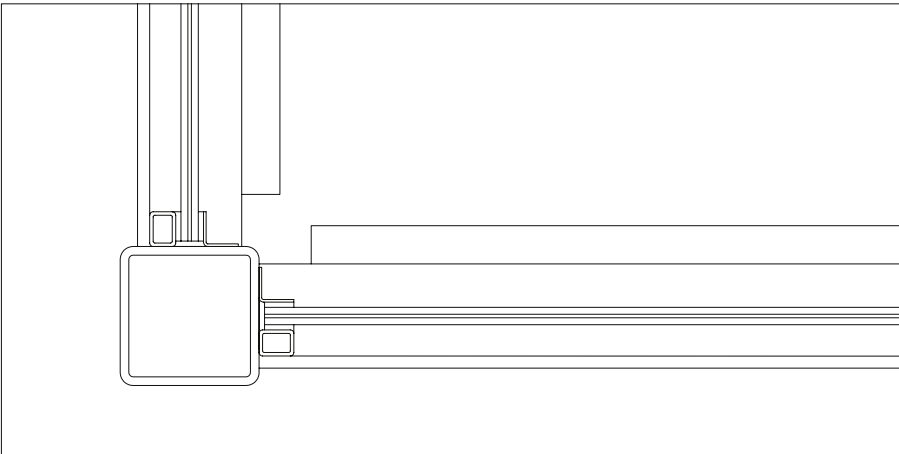

Glass fixing, point fixing

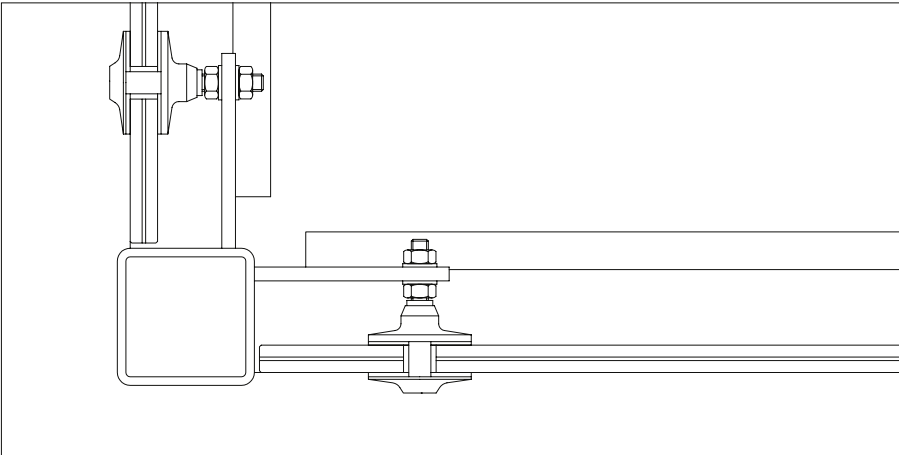

Vertical section
Aluminium façade profile

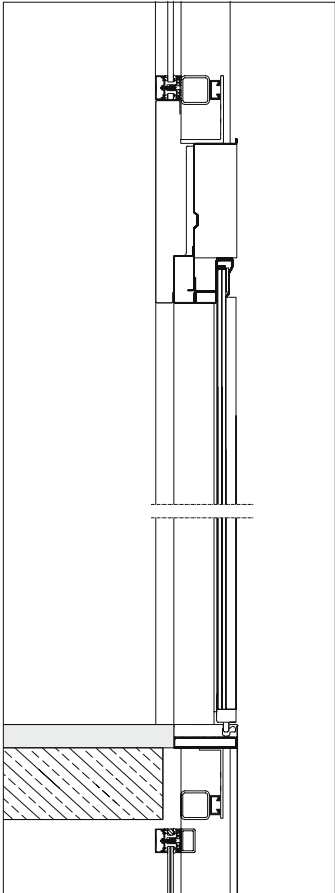

Vertical section
Glazing between the profiles

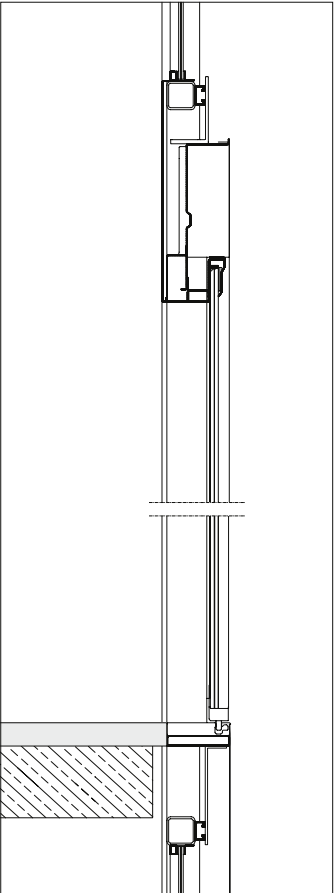

Vertical section
Glass fixing, point fixing

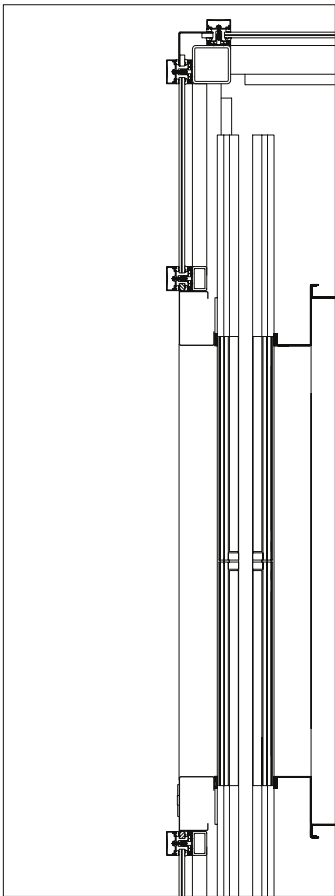
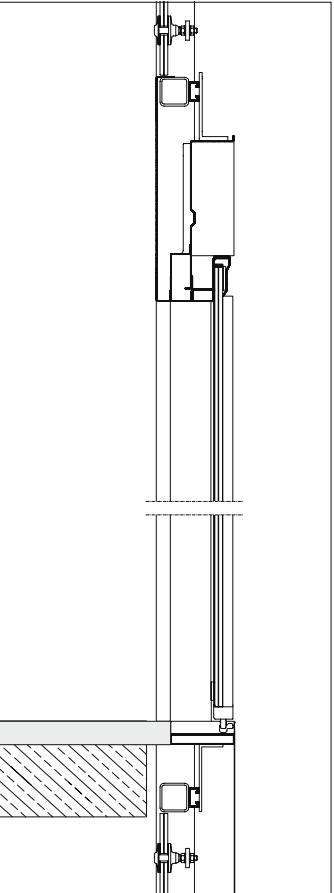

Horizontal section

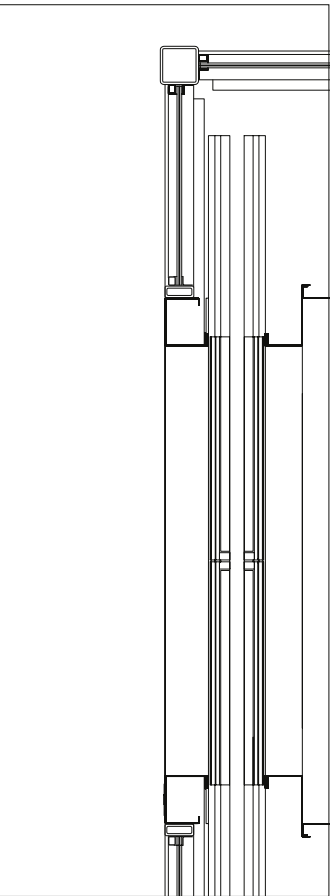

Horizontal section

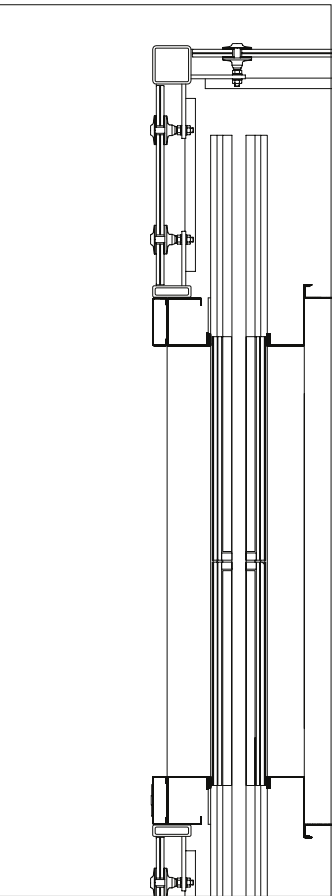

Horizontal section

ENERGY EFFICIENCY.

THE GLASS PANORAMA ELEVATOR ACHIEVES THE HIGHEST ENERGY EFFICIENCY CLASS A¹⁾

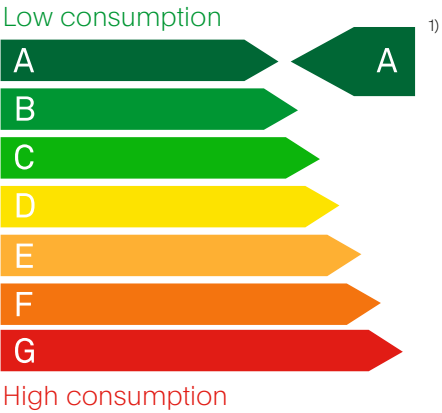

The energy consumption of all buildings in Germany accounts for approx. 40 % of the country's total power consumption.²⁾ elevators are responsible for 3 to 5 % of this figure, extended to the whole of Europe, this means 18 TWh annually.³⁾

The energy consumption of an elevator is determined by a large number of factors. The main factors are:

- the trip consumption
- the idle/standby consumption
- the energy loss due to heat escaping via the well ventilation.

The weighting of the factors is highly dependent on use of the respective elevator. For example, on average, the standby consumption of elevators in residential buildings alone accounts for around 70 % of the total energy consumption of the elevators.

The power consumption is primarily determined by the system components and their energy efficiency.

For elevators which are mostly in standby operation, the energy consumption can be reduced by modern controls by up to 50 %. For cable elevators subject to frequent usage, high-quality drives with a high efficiency level should be used. Intelligent control systems can be used to avoid mistaken trips and optimize call assignment in elevator groups, depending on the level of traffic. Reciprocal energy feed is possible in case of opposite movement direction of cabs in elevator groups. Roll resistance should be optimised by high-quality, maintenance-free ball bearings, round grooves and plastic-sheathed cables and lighter constructions.

A shaft smoke extraction system can reduce the energy loss caused by heat escaping through the shaft. Correct and sustainable elevator maintenance by qualified specialist personnel on the basis of EN 13015 permanently ensures the success of energy-saving measures.

1) The calculation is based on use category 2 according to VDI 4707 for a glass panorama elevator with 1,000 kg load capacity, 25 m travel height and 1.0 m/s speed and energetic recovery.
2) Source: REGIERUNGonline, Building and Living
3) Source: VDMA, Energy efficiency in elevator technology
4) The calculation basis are shaft dimensions of 1,750 x 1,800 mm surface area, 5 doors 900 x 2,000 mm, one-sided opening, shaft height 16 m

TOP TECHNOLOGY FOR CONSISTENT ENERGY SAVINGS.

Energy saving potential in trip consumption

The power consumption of elevators during the trip essentially depends on the type of drive. State-of-the-art and high-quality drive and control technology reduce energy consumption decisively. This is shown by a comparison of the trip consumption of a Glass Panorama Elevator with standard drive types:

- 10 % Energy saving compared to a comparable wire rope elevator with gear and frequency control.
- 45 % Energy saving compared to a comparable wire rope elevator with gear, changeable pole and 2 speeds.
- 75 % Energy saving compared to a comparable hydraulic elevator.

Energy saving potential in standby consumption

The power consumption of elevators essentially depends on their active consumption sources. The standby consumption can account for up to 82 % of the total energy consumption of an elevator. The largest energy saving potential lies in targeted switching off of loads that are not required. This is shown by the technical solutions of the Glass Panorama elevator:

- 32 % Energy saving by using more efficient lamps and switching off the car lighting when the elevator is at a standstill.
- 5 % Energy savings thanks to switching off light curtains, car level and directional indicators.
- 9 % Energy saving by switching off the frequency converter during non-busy periods.

Energy saving potential in the well

Due to the smoke extraction openings required in the headroom, heat from buildings can escape to the outside without hindrance. Here the largest energy saving potential lies in closing the smoke extraction opening with electrically operated roof lights or louvre windows. In the event of smoke detection (automatic) or targeted ventilation (manual), the roof lights or louvre windows open.

10,400 kWh energy saving a year are possible, if the escape of heat through the smoke extraction opening in the headroom is prevented.⁴⁾

Three steps to the energy efficient elevator.

Planning and designing elevator systems in line with needs and so that they are efficient should take into consideration the building type, the planned use and the legal standards and regulations as early as possible. The energy evaluation of the Glass Panorama elevator in three steps:

- Determination of the usage category
 - Producing the energy efficiency forecast
 - Determining the thermal energy loss through the smoke extraction opening in the headroom
- We will be pleased to assist you with the design. Please contact us.

GP THE SERVICE



PERSONAL, COMPETENT AND ALWAYS AVAILABLE.

- 1+1

One customer – one responsible service manager. A competent partner for all matters concerning service.
- 60,000

elevator installations are supported and maintained by Schmitt+Sohn yearly. Own and third-party makes.
- 24/365/0

Our callout response: 24/7, 365 days a year and 0 waiting time.
- 638

qualified service technicians. Always moving. Proper maintenance, repair and evaluation of the elevator installations.
- 117

Service managers are responsible for customers, service technicians for the elevator installations.
- 13015

DIN standard quality. The benchmark for qualified elevator installation service.
- 657

employees in Technology, Development, Production and Administration. Fully up-to-date and service-orientated. Always on the job. Immediate reaction in case of emergency.
- 1

Central spare parts store in Nuremberg with all spare parts. Most are original parts produced by us in-house.
- 35

Branches and sales offices throughout Europe. Near to our customers. For every service to do with your elevator.
- 796

Service vehicles as mobile spare parts stores, equipped with more than 300 of the most important wearing parts. Local. Short response times. High availability.
- 10,000

A Schmitt+Sohn elevator is made up of more than 10,000 parts. Almost all of which we produce ourselves, in our own company. True originals in consistently high quality. 20-year spare parts guarantee. If an order is received before 16:00 we deliver over night, each of the 10,000 spare parts.



- 3

performance-based service agreements. For an enduring partnership.
- SYSTEM MAINTENANCE

The service agreement for the system maintenance includes the inspection and maintenance of all safety devices and guards and setting and adjustment work to DIN 13015.
- FULL MAINTENANCE

The service agreement for full maintenance covers all expenditure that can occur in relation to operation of an elevator installation:
Maintenance work and measures, including all replacement part deliveries and troubleshooting as well as carrying out regular official testing.
- C 2000

The C 2000 service agreement contains modular services:
Alarm and video misuse detection, elevator attendant and building control module, online support around the clock.



NEXSD[®] NEXT ELEVATOR SERVICES

NEXSD[®] is the result of many years of research and development at Schmitt+Sohn elevator. Compatible with many different manufacturers and over 100 different controllers, NEXSD[®] offers the best service with complete transparency, predictive analytics and excellent availability thanks to intelligent algorithms.

Each Glass Panorama elevator is equipped with a NEXSD[®] Box and can offer all of the advantages of NEXSD[®].

Because it is manufacturer-independent and can be retrofitted at any time, NEXSD[®] is unique on the market.



More information is available at:
<https://www.schmitt-elevators.com/nexsd>.
For a video on NEXSD[®], please scan this QR code with your smartphone.

NEXSD CUSTOMER COCKPIT[®]

The NEXSD CUSTOMER COCKPIT[®] provides access to all key operating data for your elevators in real time.

NEXSD AWM[®]

Electronic elevator attendant
The fourth generation of the elevator attendant fulfills all statutory requirements and is seamlessly connected to the controller. Elevator systems are tested fully and on an ongoing basis to detect problems promptly.

NEXSD CARE[®]

The NEXSD CARE[®] system automatically records operating and fault data. Predictive analyses make it possible to detect and correct wear promptly.

NEXSD INSPECT[®]

NEXSD INSPECT[®] is used to collect and analyze relevant data from systems subject to frequent faults. This makes it easier to determine the status of the system on a preventative basis, and identify necessary measures.

You will find your competent contact
in any of our 35 branches.
We look forward to hearing from you.

Germany

Service 24: +49 (0) 800 24 00 365
www.schmitt-aufzuege.de
info@schmitt-aufzuege.de

90402 Nürnberg
Hadermühle 9–15
Fon +49(0)911-24 04-0
Fax +49(0)911-24 04-111

86167 Augsburg
Bürgermeister-Wegele-Straße 12
Halle 1plus
Fon +49(0)821-56 74 745-0
Fax +49(0)821-56 74 745-1

95448 Bayreuth
Nürnberger Straße 19
Fon +49(0)921-78 77 82-0
Fax +49(0)921-78 77 82-28

13509 Berlin
Miraustraße 50–52
Fon +49(0)30-43 60 225-0
Fax +49(0)30-43 60 225-28

09125 Chemnitz
Reichenhainer Straße 171
Fon +49(0)371-53 0 99-0
Fax +49(0)371-53 0 99-99

96450 Coburg
Hahnwiese 5
Fon +49(0)9561-24 98-0
Fax +49(0)9561-24 98-70

01139 Dresden
Washingtonstraße 16/16a
Fon +49(0)351-217 60 90-0
Fax +49(0)351-217 60 90-30

99097 Erfurt
Alte Chaussee 89
Fon +49(0)361-64 49 99-0
Fax +49(0)361-64 49 99-28

45141 Essen
Bamlerstraße 5a
Fon +49(0)201-280 10-0
Fax +49(0)201-280 10-48

60437 Frankfurt
Berner Straße 45
Fon +49(0)69-42 08 05-0
Fax +49(0)69-42 08 05-29

79108 Freiburg
Neuer Messplatz 3
Fon +49(0)761-29 67 89-0

22453 Hamburg
Papenreye 25
Fon +49(0)40-58 97 13-0
Fax +49(0)40-58 97 13-13

74074 Heilbronn
Ferdinand-Braun-Straße 8
Fon +49(0)7131-89 98 5-0
Fax +49(0)7131-89 98 5-44

50226 Köln
Alfred-Nobel-Straße 27
Fon +49(0)2234-95 37 9-0
Fax +49(0)2234-95 37 9-22

30851 Langenhagen
bei Hannover
Erich-Ollenhauer-Straße 3
Fon +49(0)511-72 58 7-0
Fax +49(0)511-72 58 7-25

04416 Leipzig
Weinteichstraße 5
Fon +49(0)34297-16 66-0
Fax +49(0)34297-16 66-19

67065 Ludwigshafen
Am Bubenpfad 1
Fon +49(0)621-57 92 80-0
Fax +49(0)621-57 92 80-9

93059 Regensburg
Im Gewerbepark A2
Fon +49(0)941-46 46 2-0
Fax +49(0)941-46 46 2-46

72070 Tübingen
Industriestraße 24
Fon +49(0)7071-79 69-0
Fax +49(0)7071-79 69-29

85716 München-
Unterschleißheim
Röntgenstraße 2
Fon +49(0)89-95 93 98-0
Fax +49(0)89-95 93 98-18

97076 Würzburg
Friedrich-Bergius-Ring 30
Fon +49(0)931-25 04 2-0
Fax +49(0)931-25 04 2-29

Austria

www.schmitt-aufzuege.at
info@schmitt-aufzuege.at

6020 Innsbruck
Grabenweg 72
Fon +43(0)512-34 65 02-0
Fax +43(0)512-34 65 02-1

8020 Graz
Puchstraße 17-21
Obj. 12, 3. OG
Fon +43(0)316-26 29 23
Fax +43(0)316-26 29 24

4020 Linz
Wiener Straße 131
Fon +43(0)732-33 02 26-0
Fax +43(0)732-33 02 26-16

1100 Wien
Triester Straße 87
Fon +43(0)1-40 55 50 8-0
Fax +43(0)1-40 55 50 8-4

Portugal

www.schmitt-elevadores.com
info@schmitt-elevadores.com

Porto
4465-688 Leça do Balio
Rua de Dom Frei Martim Fagundes
Tel +351 229-56 90 00
Fax +351 229-56 90 09
Serviço 24h: +351 229-569 002

4700-361 Braga
Rua António Marinho, 68
Tel +351 253-61 08 19
Fax +351 253-26 09 51
Serviço 24h: +351 253-610 819

6000-228 Castelo Branco
Rua Fernando Namora,
LT I-3 , Lj.3
Tel +351 272-34 24 72
Fax +351 272-34 24 28
Serviço 24h: +351 272-342 472

3025-037 Coimbra
Urbanização do Loreto LT 4
R/C - C/C
Tel +351 239-49 38 03
Fax +351 239-49 63 29
Serviço 24h: +351 239-493 803

8000-183 Faro
Travessa Henrique Bernardo Ramos
nº 9, CV Dto.
Tel +351 289-82 27 58
Fax +351 289-81 30 98
Serviço 24h: +351 289-813 156

9020-330 Funchal
Avenida da Madalena,
Nº94-A, r/c, Fração R
Tel +351 291-14 77 49
Serviço 24h: +351 291-14 77 49

Lisboa
2790-034 Carnaxide
Rua da Barruncheira, 3–1º Esq.
Tel +351 213-03 03 50
Fax +351 213-03 27 06
Serviço 24h: +351 213-030 359

Czech Republic

www.schmitt-vytahy.cz
info@schmitt-vytahy.cz

36263 Karlovy Vary-Dalovice
Botanická 252/6
Tel +420-353 433-722
Fax +420-353 433-721

14900 Praha 4-Chodov
Klecandova 2380/1
Tel +420-272 191 652
Fax +420-272 191 651

32300 Plzeň
Bolevecká náves 35/27
Tel +420-353 433 735
Fax +420-353 433 721



IMPRINT

Published by::
Aufzugswerke
Schmitt+ Sohn GmbH & Co.KG
Hadermühle 9–15
D-90402 Nürnberg

Editorial team:
Dr. Johannes Schmitt
Maximilian Schmitt
Aniko Peiffer
Marius Schreyer

Layout:
Marius Schreyer Design

Realisation:
Loffmedia

Printing: Druckerei Frey

Paper: Profi Silk
Envelope 300g, inside 170g
Type: Plain

© Schmitt+Sohn Aufzüge
All rights reserved.

Stand 07-2025 • 176941

Illustration acknowledgements:

Portrait photography:
Gerd Grimm

Photography of references:
Projekttriangle Design Studio
Martin Grothmaak
Tom Ziora
Gerd Grimm

Product photography:
MBS Studios
Thomas Esch
Marius Schreyer Design
Gerd Grimm

Legal notice / disclaimer:

The brochure GP THE GLAS PANORAMA ELEVATOR, last updated 2025, is copyright protected. All rights reserved by the author. Any distribution or transmission to third parties, and any duplication, editing, presenting, sending, renting, lending or other use of this brochure or parts thereof without the express written consent of the au-
thor is prohibited, and will be prosecuted by civil and criminal means.

The persons shown in this brochure have provided their consent in accordance with the law. Transmission of this personal data without authorization is considered a violation of data protection law, and reported by the author.

Subject to technical amendment.
Colour variations may occur due to printing methods.

Registered design:
All colour combinations shown are registered and protected as industrial designs by Schmitt Markenschutzgesellschaft mbH in Germany and in other countries.

Trademark:
Color Glas® is a trademark of Schmitt Markenschutzgesellschaft mbH in Germany and in other countries.



SCHMITT+ SOHN ELEVATORS

Schmitt+Sohn Elevators GmbH & Co. KG
Hadermühle 9–15
D-90402 Nuremberg

Fon +49(0)911 - 2404 - 0
Fax +49(0)911 - 2404 - 111

neuanlage@schmitt-aufzuege.com
service@schmitt-aufzuege.com
www.schmitt-aufzuege.com

The Schmitt+Sohn Aufzüge company has received internationally renowned design prizes for its corporate design, the corporate presentation, the elevator systems and the elevator series.

- iF product design award 1997, Schmitt+Sohn Elevator Systems
- iF product design award 2008, Schmitt+Sohn Color Glas® Elevators
- Designpreis der Bundesrepublik Deutschland 2009, Nomination, Schmitt+Sohn Color Glas® Elevators
- red dot award communication design 2011, Schmitt+Sohn Corporate Design
- red dot award communication design 2011, Schmitt+Sohn Corporate Brochure
- iF communication design award 2011, Schmitt+Sohn Corporate Brochure
- Designpreis der Bundesrepublik Deutschland 2012, Nomination, Schmitt+Sohn Corporate Brochure
- Iconic Award 2014 for Schmitt+Sohn Product Brochures
- Iconic Award 2014 for Schmitt+Sohn Trade Fair Stand Bau 2013
- Iconic Award 2014 for Schmitt+Sohn New Building for Coburg Branch
- Iconic Award 2014 for Schmitt+Sohn Color Glas® Elevators
- Iconic Award 2014 for Schmitt+Sohn Forum Product
- German Design Award 2015, Special Mention for Schmitt+Sohn Corporate Design
- German Design Award 2015, Special Mention for Schmitt+Sohn Color Glas® Elevators
- German Brand Award 2020, Winner in Excellence in Brand Strategy and Creation for Schmitt+Sohn Aufzüge
- German Brand Award 2020, Gold in Excellent Brands for Schmitt+Sohn Aufzüge



Schmitt+Sohn Elevators GmbH & Co. KG
Hadermühle 9-15
D-90402 Nuremberg

Fon +49(0)911 - 2404 - 0
Fax +49(0)911 - 2404 - 111

neuanlage@schmitt-aufzuege.com
service@schmitt-aufzuege.com
www.schmitt-aufzuege.com