

S+

SERVICE

SCHMITT+SOHN ELEVATORS

PERSONAL COMPETENT
AVAILABLE

S+

S+

SCHMITT+SOHN ELEVATORS

1

Nennlast
630 kg oder
8 Personen

Nr. 331861
Jahr 2022 | CE 0408



SERVICE
PERSONAL COMPETENT
AVAILABLE

CONTENTS

Welcome	6
<hr/>	
Key performance indicators	8 – 9
<hr/>	
Service	10 – 31
Service contracts	14
Spare parts	22
Service quality	24
Consultation	28
<hr/>	
Modernisation	32 – 65
Drive	38
Cab	42
Doors	50
Controls	54
Energy efficiency	58
Safety	60
Comfort	64
<hr/>	
Contract customer	66 – 73
<hr/>	
Contact	74
Imprint	76



WELCOME

Excellent service is a claim. In combination with our name, it quickly becomes a conviction. For peak performance, it is a new challenge every day. The acceptance of responsibility for every customer. A conviction. An attitude.

For long-lasting partnerships. Supported by the timeless values of a modern family company. With over 100 years of experience. Personal, expert and available at all times. This is what we stand for.

Welcome to Schmitt+Sohn elevators.

Maximilian Schmitt
Managing partner



Responsibility
since 1861.



Our key performance indicators

Schmitt+Sohn at a glance – the key performance indicators of a successful company

1861

Foundation of the company. A long tradition in elevator construction and service begins.

6

generations of experience. The company family remains a constant.

18

domestic and foreign companies. Decentralised, and always close by.

4

countries in Europe. We maintain locations in: Germany, Portugal, Austria, and the Czech Republic.

2,100

systems produced annually. Production in our own plants.

100,000

elevator systems built. Our reference customers are distributed throughout Europe.

1,900

employees. Success has many faces. 118 apprentices are included in this number.

9001

standard quality. Improving. Developing. Looking ahead.

24

-hour on-call readiness 365 days per year. Always there for you.

50,000

systems to be serviced annually. Competence you can rely on.

180

million euros in turnover. Convincing results.

0

bank liabilities. Independence for strong partnerships.

Our Values

Ongoing learning: That is what our 1,900 passionate employees, who contribute their expertise and abilities every day, stand for.

Quality: Continuous development and improvement of our processes and products, for example in production. Each year, 2,100 new systems leave our company with a consistently high level of quality.

Corporate reliability: The foundation of long-lasting relationships to our customers and our employees. This is a value we have been focused on for over 160 years.

Our products

We develop outstanding products that meet high technical and aesthetic requirements. They are created through a dialog between architecture, design, and technology. This is part of our self-conviction as a company. A systematic approach, functionality, and the quality of painstaking workmanship down to the last detail are part of our commitment to meaningful development and design. Human mobility is our mission.

Our service

We provide you access to a service manager to support you for the entire time your elevators are in service. This is a big responsibility, as we service over 50,000 systems each year. Thanks to a decentralized network, we are always nearby to ensure you receive the support you need. Reliability is our top priority: our services are available to you 24 hours a day, 365 days a year - with no waiting time, for successful, long-term partnership.



View our corporate film here.

SERVICE
AT YOUR SIDE

Service contracts

Spare parts

Service quality

Consultation

“Safety and availability.
Doesn’t sound very exciting?
That’s not such a bad thing. Professional
service functions smoothly and directly.
Without excitement but with high
availability.”

Denise Yazidi, Sales service contracts.
Stands for excellent service.





Service contracts The basis for enduring partnerships

One customer – one responsible service manager.
Holding ourselves to high standards. For our customers, this means we are a competent partner that can handle all issues related to service, anywhere in Eu-rope, including for elevators from third-party manufacturers. With more than 20,000 elevators serviced by us, this is the way we work every day.

We are committed to not just on-call service, but responsible service with discernment.

Every service contract is backed up by the full logistics chain of a modern service provider:
Personal, competent, and always available.

Maintenance contracts

System maintenance

The solution for all operators who appreciate transparent costs and take advantage of services based on their needs, without making sacrifices in terms of safety or maintenance quality. Recommended for all elevator systems – regardless of manufacturer and year of construction. Includes inspections and maintenance of all safety equipment, as well as adjustments and settings. Always certified in accordance with DIN 13015.

Full maintenance

The solution for all operators who place a premium on long-term, economical planning reliability. Recommended for new and updated elevator systems. Full maintenance includes all potential expenses associated with operating a elevator system: repair work and measures, including all replacement parts deliveries and correcting operational disruptions, as well as support in carrying out regular officially required testing. Maximum planning reliability with minimal bureaucratic complexity. The all-around, stress-free package for your elevator.

X-TRAC shaft smoke extraction

Systematic functional inspections, cleaning and servicing of all safety equipment in the shaft smoke extraction system. Optimal energy savings and safety in case of a fire.

Options

ZÜSCO

Competent assistance with legally required ZÜS primary testing by our technicians, using an electronic test load system.

ZÜSPRO

ZÜSCO services, plus testing fees and handling all organisational tasks. From scheduling to service and procedural coordination.

Elevator caretaker

Inspections must be conducted at regular intervals in accordance with the Industrial Safety Regulation (BetrSichV). Our service technicians handle the duties of a elevator caretaker, and inspect all relevant safety criteria with complete documentation.

Customer portal

You receive access to all information relevant to your collaboration with us via an individual web login – orders, elevators, and order history at a glance. As a Schmitt+Sohn customer, your service manager is always just a call away. Access the customer portal with just a click.

Maintenance - Overview of services

Services

		System maintenance	Full maintenance	Shaft smoke extraction
Maintenance	– Inspection and check of all functional and safety devices	●	●	●
	– Care, setting and adjustment work	●	●	
	– Minor repairs during maintenance	●	●	
	– Cleaning and lubricating agents	●	●	
	– Small consumable materials (signal and acknowledgement lamps)	●	●	
	– Inspection and check of all functional and safety devices of the the smoke extraction system in the elevator shaft			●
	– Cleaning of dirt and contamination caused by use	●	●	
	– Software updates for components of the Schmitt+Sohn controls	●	●	
	– Customer Portal	●	●	●
	– E-Shop	●	●	●
Repair	– Rectification of malfunctions		●	
	– Supply of spare parts		●	
	– Gearbox and motor oil change		●	
	– Hydraulic oil change		●	
	– Cable replacement		●	
	– Drive pulley replacement		●	
Passenger release	– Release of trapped passengers by our own qualified specialist personnel	○	●	
Service 24	– Free service hotline 0800 - 24 00 365	●	●	●
Spare parts	– Stocking of the most important spare parts in over 500 service vehicles	●	●	●
	– Over 10,000 spare parts available within 24h	●	●	●
	– Spare parts available for over 20 years	●	●	●
Legally prescribed tests	– Provision of specialist personnel for the main tests	○	●	
	– Provision of test equipment (electronic load measurement system)	○	●	
	– Organising and carrying out tests	●	●	
	– Payment of fees for primary and intermediate testing	○	○	
Standards	– EN 13015	●	●	

● included ○ options

C2000 contracts

Safety, at the push of a button

C2000 Remote emergency call

The C2000 emergency call system provides assistance quickly, reliably, and simply:

- detects trapped persons
- connects directly to the 24 h Schmitt+Sohn on-call headquarters
- ensures professional support and expert rescue for trapped persons

Because of this, our service fulfils the operator’s obligations under the law.*
Your elevator functions risk-free – with increased availability thanks to immediate repairs and re-commissioning. Directly, without detours and lost time. Over 30,000 contractual customers already trust in our services.

All Schmitt+Sohn new systems come equipped with this as a series features. It can also be retrofitted at any time – regardless of manufacturer or controller – quickly, inexpensively, and fully eligible for apportioning costs. Buy or rent – low monthly operating costs or a 0 investment. You choose. The C2000 on call. Safety, at the push of a button.

Options

C2000 AWM

Assumption of all primary duties of a elevator caretaker under the digital elevator caretaker model. The solution, when it is not possible or economically feasible for the operator to provide a elevator caretaker.

C2000 Visio – video misuse detection

100% avoidance of unforeseen added costs due to misuse of the emergency call function.

C2000 Visio – digital video monitoring

Effectively prevents and supports clarification of property damage and vandalism. Recommended for high-traffic areas in public facilities.

C2000 GSM**

The quick and inexpensive alternative to a landline connection.
Immediately available; all you need is a cellular phone card. No on-site installation work or associated costs or wait time. An attractive contractual model with low basic fees and included minutes.

*Technical rules for operating safety 3121 and 2181

**Sufficient GSM network coverage at the installation site is required



C 2000 – Overview of services

Services		C 2000 emergency call system	C 2000 AWM	C 2000 Visio
Emergency call system	– Connection to the certified Schmitt+Sohn on-call centre	●		
	– 24h monitoring of the emergency call function	●		
	– Professional care and release of trapped persons	●		
	– Professional release by Schmitt+Sohn service technicians	●		
	– Repair and recommissioning of the elevator system	●		
	– Permanently monitored emergency power supply	●		
	– Control call function to EN 81-28	●		
	– Electronic misuse suppression	●		
Elevator monitor	– Takeover of all main elevator attendant duties			●
	– Monitoring of stopping accuracy			●
	– Cab light monitoring			●
	– Safety circuit monitoring			●
	– Monitoring of the shaft and cab doors			●
	– Monitoring of the motor temperature			●
Standards	– TRBS 2181, TRBS 3121	●	●	
	– EN 81-28, EN 81-70	●	●	
	– ÖNORM B 2458	●	●	
Communication	– Digital telephone connection	●	●	
	– GSM mobile radio network	○	●	
Vandalism	– Video misuse detection			●

● included ○ options



NEXSD[®] NEXT ELEVATOR SERVICES

NEXSD[®] is the result of many years of research and development at the Schmitt+Sohn elevator company. Cross-manufacturer and compatible with over 100 different controllers, NEXSD[®] offers the best service, predictive analysis and the highest availability with full transparency thanks to intelligent algorithms.

Every elevator comes already equipped with an NEXSD[®] Box, meaning it can offer all the advantages of NEXSD[®].

Because it is manufacturer-independent and can be retrofitted at any time, NEXSD[®] is unique on the market.



More information is available at:
<https://www.schmitt-elevators.com/nexsd>.
For a video on NEXSD[®], please scan this QR code with your smartphone.

NEXSD CUSTOMER COCKPIT[®]

The NEXSD CUSTOMER COCKPIT[®] provides access to all key operating data for your elevators in real time.

NEXSD AWM[®]

Electronic elevator attendant
The fourth generation of the elevator attendant fulfills all statutory requirements and is seamlessly connected to the controller. Elevator systems are tested fully and on an ongoing basis to detect problems promptly.

NEXSD CARE[®]

The NEXSD CARE[®] system automatically records operating and fault data. Predictive analyses make it possible to detect and correct wear promptly.

NEXSD INSPECT[®]

NEXSD INSPECT[®] is used to collect and analyze relevant data from systems subject to frequent faults. This makes it easier to determine the status of the system on a preventative basis, and identify necessary measures.

Spare parts Guaranteed always available

A Schmitt+Sohn elevator is made of more than 10,000 parts. We manufacture almost all of them ourselves in our factories. For true originals, in long-lasting high quality. With a replacement parts guarantee for 20 years.

Nuremberg is our technical logistics hub. All of our replacement parts are kept in stock there. Most of these are original designs we produce in-house, but some are replacement parts for third-party systems, regardless of manufacturer. As a reference on a mobile device and in printed form – your contact person always has the complete manual with them.

Our 796 service vehicles are already outfitted with the 300 most important wear parts. Mobile warehouse for short reaction times and optimal availability.

Directly on site – anywhere. If you need specialised components, we are able to react within a day. If you place your order before 4:00 PM, our logistics headquarters delivers it overnight, or within just a few hours in urgent cases.





Service quality Competence without compromises

People are the foundation for quality service. We only work with our own staff members, meaning we can influence what we do, and how we do it.

Each service technician personally services the same systems within their territory for many years. This stability is what makes our technicians experts on your elevator system. Regular ongoing training at the Schmitt+Sohn Academy and our company-wide knowledge network combine individual expertise to achieve excellent service.

Direct communication channels and exchange are the basis for reacting to your concerns in a flexible and timely manner.

Our employees are professionals with a broad perspective who focus on your needs, with optimal tools to serve you.

Development and in-house manufacturing are two other significant factors in our capability.

What we offer: top performance born from conviction, quality in its purest form and competence without compromises.



Our mission is to provide peak performance for every Schmitt + Sohn contractual customer.

Competent

The diversity of the elevator systems we service demands broad professional expertise. Our service technicians are well-equipped. In addition to regional, specially trained key users, you also have access to the technical office, support team, and the extensive Schmitt+Sohn knowledge network. Schmitt+Sohn's expertise is the result of collaboration between all of us, for each individual customer.

Available

Service from Schmitt+Sohn is always available, and our availability goes beyond simply answering the phone. Contracting customers have access to the complete logistics chains of an international service provider, if necessary.

- 34 branches and sales offices in Europe
- 17 Service managers
- 638 qualified service technicians
- 50 key users
- 10 technical support employees
- 796 service vehicles serve as a mobile replacement parts warehouse
- 34 warehouses in our branches
- Central warehouse containing over 10,000 parts in Nuremberg
- Redundant service centres staffed around the clock

Reliable

High availability – the foundation for economy in elevator operation. Our trained service technicians identify potential problems in advance. Promptly replacing wear parts prevents defects, which reduces downtimes to a minimum.

Transparent

Our technicians handle tasks associated with maintenance using check lists on a routine basis for all elevator types and manufacturers. A detailed maintenance log provides reliable documentation. Mobile data collection devices allow for seamless access to all parameters relevant for the order, as does the customer portal.

Independent testing organisations regularly review our services, to ensure we can provide convincing performance in the long-term.

Proven processes. Efficient tools. Qualified employees.
Service at Schmitt+Sohn. Peak performance for you



Consultation Expertise as a service

Comprehensive professional expertise and specialised tools are the basis of our competence.

Optimised services ensure reliable budgets and the highest availability. Customised concepts give you the certainty of knowing all aspects of economical and sustainable renovation have been taken into consideration.

Excellent advising means partnership through dialogue, and answers to questions before you even ask them. Complete solutions tailored to you, instead of just one standard for all.



Excellent consultation knows the answer.
Operators carry great responsibility.
Partners can share this.

- ⓘ Since 2015 , operators have been responsible for assessing risks associated with the system (risk assessment) and accordingly providing necessary and appropriate protection measures.
- ✓ Manufacturer-independent performance of risk assessment (risk assessment plus) through our specially trained personnel.
- ⓘ Operators of elevator systems subject to monitoring requirements are obliged under the Betriebssicherheitsverordnung (BetrSichV) (Operating safety regulations) to operate the elevator according to the latest status of the technology, to maintain it in a proper condition, to monitor it and to have the necessary repair and maintenance work carried out professionally.
- ✓ The European standard DIN EN 13015 specifies all elements which must be taken into account for proper maintenance.
As a certified maintenance company, Schmitt+Sohn has incorporated DIN EN 13015 into its quality management system to ISO 9000:2000.
- ⓘ Anyone who operates an elevator system must ensure that emergency calls from a cab are responded to within an appropriate time, and that release measures are carried out properly. This requires regular monitoring and checking of the serviceability of the elevator by a suitably qualified person on-site (elevator supervisor).
- ✓ The C2000 emergency call system in combination with the elevator monitoring module.
- ⓘ Every elevator system subject to monitoring requirements must undergo an annual, legally prescribed test by a ZÜS (central monitoring organisation).
- ✓ Support by our specialist service personnel in the performance of the legal test.
- ⓘ Before a renovation, costs and benefits must be weighed in consideration of economic and ecological aspects.
- ✓ The Schmitt+Sohn energy forecasting tool can be used to determine and display the expected energy savings.
- ⓘ Optimal use of state funding increases the economic efficiency of renovation concepts.
- ✓ A wide range of offers are available. The KfW banking group (Kreditanstalt für Wiederaufbau) funds building renovations that improve accessibility and energy efficiency. Schmitt+Sohn gives you the overview you need.
We systematically review your project for potential support via state funds.

MODERNISATION VALUE RETENTION WITH SAFETY

Drive

Cab

Doors

Controls

Energy efficiency

Safety

Comfort

„The Modern Art Museum in Munich,
international exhibition in Vienna,
the historical Town Hall in Prague,
a famous hotel in Porto.
Our lifts can be found throughout
Europe, as can we.“

Florian Hensen, New System Sales.
Stands for excellent service.





Modernisation Innovative technology Timeless design

Modern, matching elevator components reduce the down-times, increase reliability and enable more efficient use of the elevator. The result: maximum passenger comfort and safety.

The investment in modern elevator systems is also well worthwhile with regard to cost-effectiveness. The significant reduction in maintenance and repair requirements reduces the running costs. The use of energy-optimised assemblies can also reduce the energy consumption of elevator systems by up to 50 %.

Through smooth movement, stopping accurate to the millimetre and the minimum noise level, users benefit from unique elevator comfort. Excellent design and innovative lighting concepts also increase the attractiveness and the value of the property.

We don't just work according to the state of the art, we help shape it. We don't just meet standards - we set them. Renovations by Schmitt+Sohn mean economic efficiency through value retention, regardless of the manufacturer of your elevator system.

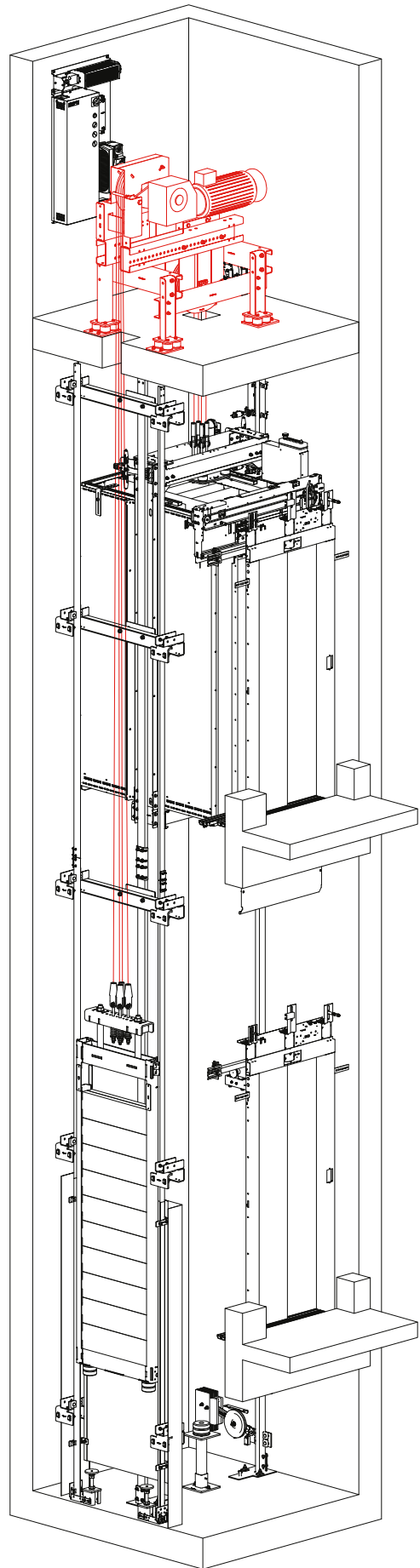

Drive – Performance that drives us

Saving energy and travelling safely. Modern drives can do even more, since they must continually comply with new requirements. In addition to the expectations of users, and safety regulations also change frequently.

Safety and efficiency, smooth running performance, durability and economic efficiency. Renovations with perspective.



Frequency-regulated gearless drive

- Application area: Speeds up to 2.5 m/s
- Energy efficiency: High energy-saving due to the low connection values
Low mains loading due to reduced current peaks
- Comfort: Stopping accurate to the millimetre without time delay
Automatic adjustment of level differences
Adjustable, computer-controlled travel curve

Option Gearless Kit 2:1

- Application area: existing elevator systems with a gearbox drive and 1:1 suspension up to 1,000 kg
- Solution: renovation via conversion kit to a gearless drive with 2:1 suspension.
- Advantages: Excellent efficiency thanks to the use of smaller, gearless drives
-Reduced on-site work due to the use of existing ceiling openings
-Use of innovative traction equipment

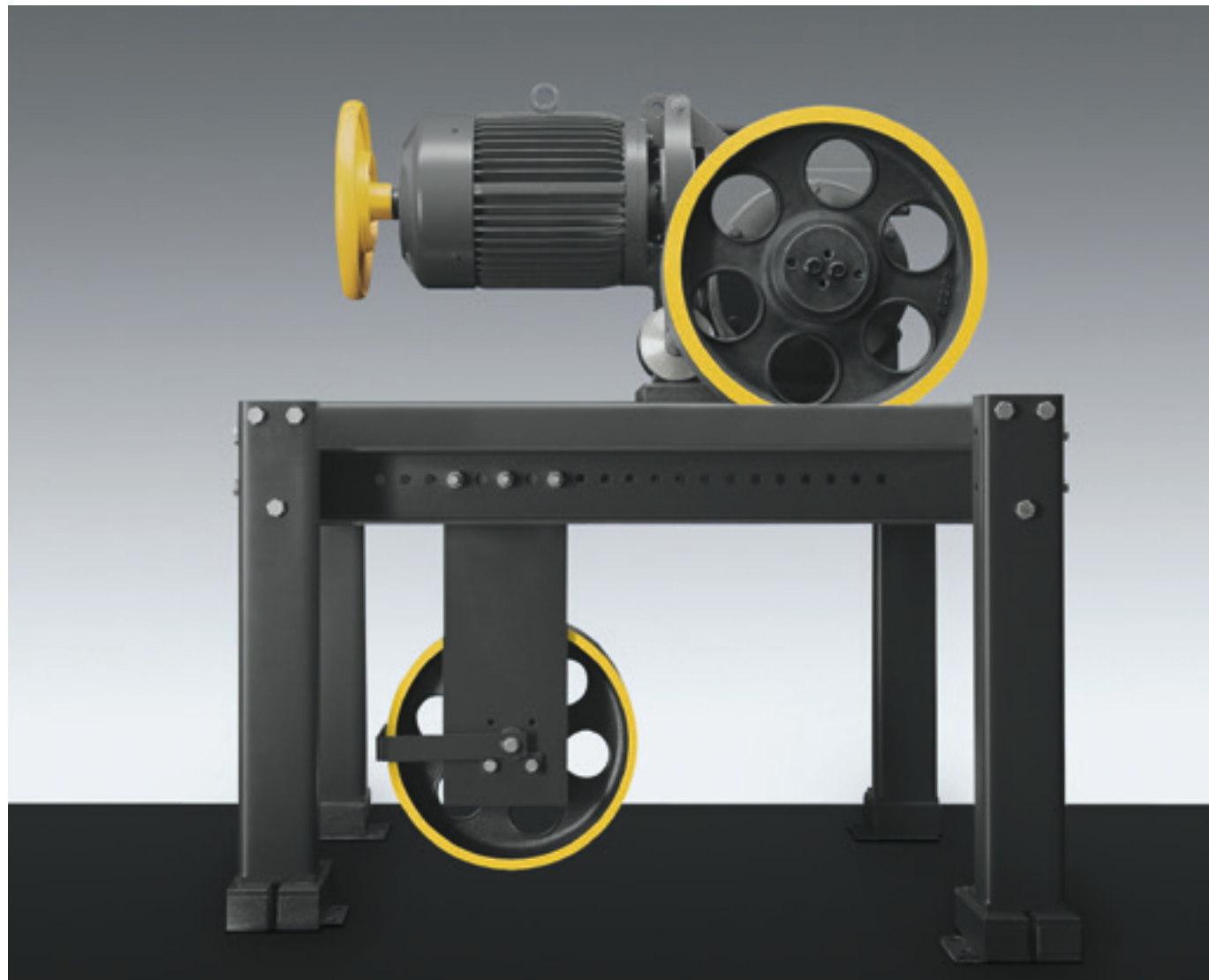

Frequency-regulated rotary current drive with worm gear

- Application area: Speeds up to 2.0 m/s
- Energy efficiency: High energy-saving due to the low connection values
Low mains loading due to reduced current peaks
- Comfort: Stopping accurate to the millimetre without time delay
Automatic adjustment of level differences
Adjustable, computer-controlled travel curve

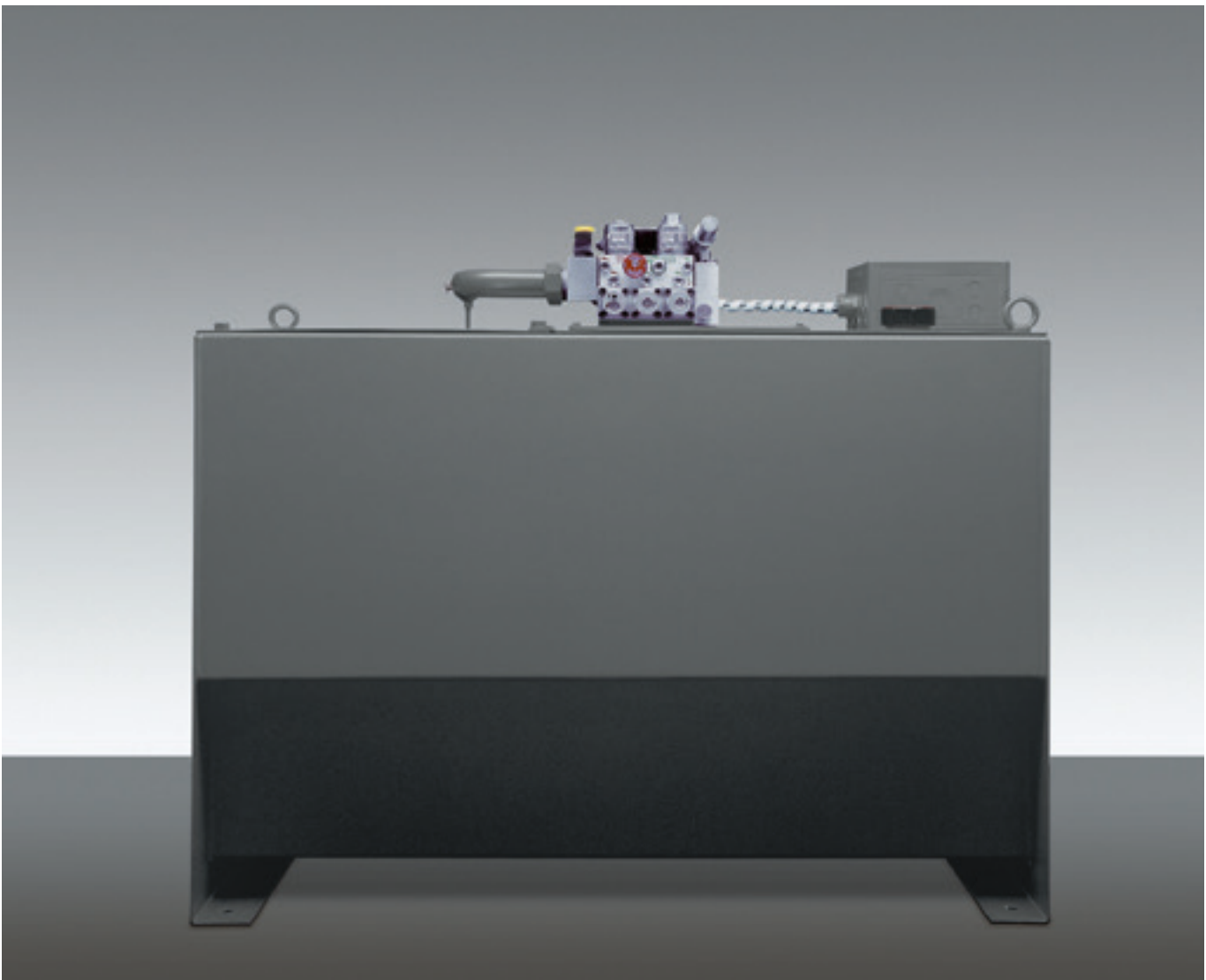

Hydraulic drive

- Application area: Speeds up to 0.8 m/s with low to medium lift heights and passenger volume
- Energy efficiency: Low mains loading due to reduced current peaks
- Comfort: Automatic adjustment of level differences

Option
Frequency-regulated hydraulic drive

- Application area: Speeds up to 1.0 m/s with low to medium lift heights and high passenger volume
- Energy efficiency: Low mains loading due to reduced current peaks
Reduced wear due to low oil temperatures
- Comfort: Stopping accurate to the millimetre without time delay
Automatic adjustment of level differences
Adjustable, computer-controlled travel curve

The spatial flexibility of the machine room offers a genuine alternative to the cable elevator without machine room in individual cases.

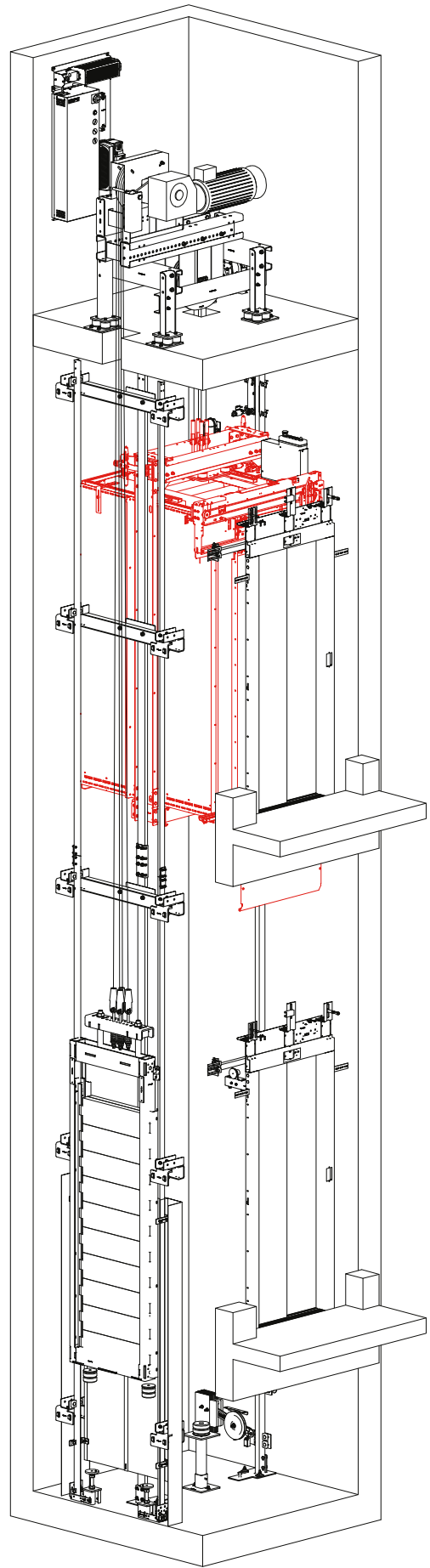

Cab – Concentration on what is most important

Schmitt+Sohn cars stand for functional design, clear lines and timeless elegance. Skilful processing of high-quality materials lets us create the extraordinary.

Sophisticated detailed solutions and coordinated colours and surfaces. Useful accessories for individual requirements. -Stylish feel and long-term value retention.

Impressive, internationally award-winning overall quality.

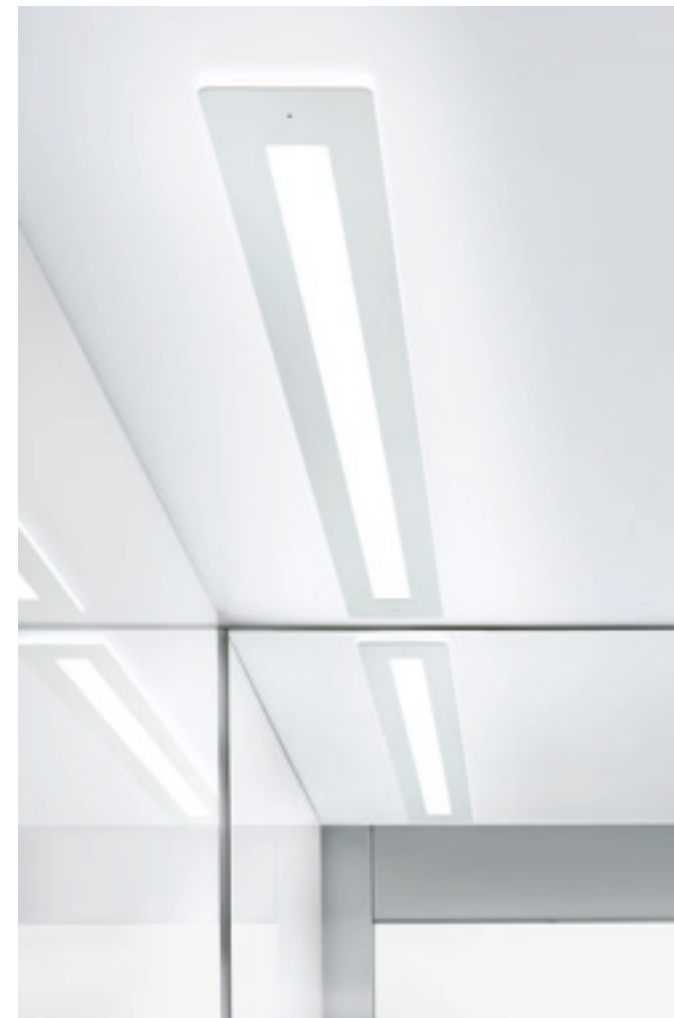



Cabs with plastic coating
The solution for all applications

Side walls:	Plastic coated
Rear wall:	Plastic coated, mirror, light-coloured, rear wall, centre
Cabin door:	Stainless steel with finishing grinding
Floor:	DC plastic, DC 2 stripes, skirting rail in stainless steel with finishing grinding
Ceiling:	Satin-finish lacquer, white
Operating panel:	BT-I-TFT-LED
Lighting:	LD7, wallwasher, LED neutral white
Handrail:	Stainless steel with finishing grinding

Stainless steel cabs
The material for generations

Side walls:	Stainless steel with finishing grinding
Rear wall:	Stainless steel with finishing grinding, mirror, light-coloured, rear wall, centre
Cabin door:	Stainless steel with finishing grinding
Floor:	DC plastic, DC 2 stripes, skirting rail in stainless steel with finishing grinding
Ceiling:	Satin-finish lacquer, white
Operating panel:	BT-I-TFT-LED
Lighting:	LD7, wallwasher, LED neutral white
Handrail:	Stainless steel with finishing grinding

Color Glas® Cabs
The solution for the most discerning requirements

Side walls:	Color Glas®
Rear wall:	Mirror, light-coloured
Cabin door:	Stainless steel with finishing grinding
Floor:	Granite Light grey, Skirting rail stainless steel with finishing grinding
Ceiling:	Satin-finish lacquer, white
Operating panel:	BT-I-TFT-LED
Lighting:	LD8 Illuminated ceiling, LED neutral white
Handrail:	Stainless steel with finishing grinding

CG-X Color Glas® Cabs
A statement for elegance

Side walls:	Color Glas®
	Brilliant white, line graphic brilliant black
	Brilliant black, line graphic brilliant white
Rear wall:	Mirror, light-coloured
Cabin door:	Stainless steel with finishing grinding
Floor:	Granite Light grey, Skirting rail stainless steel with finishing grinding
Ceiling:	Satin-finish lacquer, white
Operating panel:	BT-I-TFT-LED-XS
Lighting:	LD5X, Illuminated ceiling, LED neutral white
Handrail:	Stainless steel with finishing grinding

X1.0

Simply extraordinary

Small effort, big impact: the innovative, modular cladding system. When high-quality, timeless elegance is needed. Your car in internationally award-winning overall quality.

Technical information / product specifications

Detail	Description	Series	Accessories
Walls	Plastic coated, single colour	●	
	Stainless steel, polished		○
Ceiling	White. Concealed, generously dimensioned cab ventilation at cabin depth in both side walls.	●	
Lighting	LD7-LED wall washers, indirect, glare-free lighting	●	
	LED neutral white, panel painted metal, brilliant white		
	Filter disc and illuminated frame acrylic glass, white, semi-transparent		
	LD7-LED-RGB wall washers		○
	LED neutral white, LED-RGB with colour and lighting control ¹⁾		
Floor	LD8-LED illuminated ceiling, direct and glare-free lighting.		
	Neutral white LED. Frame aluminium brilliant white, illuminated surface		○
	plastic, white, semi-transparent. ²⁾		
Floor	Plastic DC, DC 2 stripes		○
	Linoleum, rubber, nubs, plastic EL ³⁾		○
Skirting rail	Stainless steel, satin finish. Concealed, generously dimensioned cab ventilation.	●	
Mirror	Mirror S2, glass with splinter protection film, back wall, centre, car height, light, flush recessed, mirror edges sanded and polished	●	
Handrail	Stainless steel, satin finish, suitable for the handicapped to DIN EN 81-70 ⁴⁾ .	●	
	Side walls car depth, diameter 33.7 mm.		
Operating panel Cab	Handrail holder solid stainless steel, handrail end pieces stainless steel welded		
	Stainless steel, polished, accessible arrangement in accordance with DIN EN 81-70, concealed attachment.		
	Information panel acrylic glass, white, illuminated frame acrylic glass, white,		○
Car door front	satin finish, LED, neutral white.High-resolution TFT display, flush short-stroke button, round, Button panel stainless steel, call acknowledgement		
	LED blue, symbols light grey plastic		
	Full replacement of the car door front, stainless steel, polished ⁵⁾		○
Car door front	Cladding of the car door front, stainless steel, polished ⁵⁾		○
Car door leaves	Cladding of the car door leaves, stainless steel, polished ⁵⁾		○

● included ○ options

1) The brightness in the car can be reduced in RGB mode.
2) Multi-piece illuminated ceiling for Q ≥ 1,000 kg.
3) PVC-free,without chlorine and plasticizers, high load-bearing capacity and wear-resistance, easy care, environmentally friendly.
4) Coordination on intended use between Schmitt+Sohn and customer required. Not for 320 kg load-bearing capacity.
5) If technically possible

X options

1 concept



Brilliant white

Light grey

Lime green



Deep orange

Azure blue

Pearl white

Due to the car panel, the controls must be renovated.



ISI 2040® elevator with LD8 LED illuminated ceiling.

- Dimensions: HWD 38 x 940 x 1,300 mm*
HWD 50 x 940 x 1,300 mm* (LD8-LED-RGB)
Edge distance to side walls 80 mm each,
to entry side and to back wall 50 mm each.
- Lighting: power LED, neutral white
- Accessories: LED RGB, colour control
- Frame: aluminium, brilliant white
- Light surface: plastic, white translucent,
B1 flame-resistant

* Example dimensions for car size
KB 1,100 mm x KT 1,400 mm
KB: Cab width
KT: Cab depth

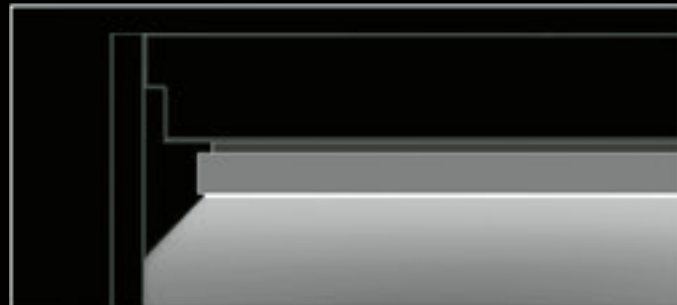

Vertical section of LD8 LED illuminated ceiling.
Functional diagram of direct lighting.
LED neutral white.

LD8 LED illuminated ceiling LD8 LED RGB illuminated ceiling

Highest functionality, puristic design and brilliant light technology characterise the totally new LD8 LED illuminated ceiling. The homogenous, neutral white illuminated surface and the very flat design of the LD8 are among its essential features.

The especially developed frame geometry not only achieves a virtually frameless light surface – it also gives the LD8 a very delicate appearance. The interior of the elevator car appears generously roomy and elegant. Impressive colours and shapes are a feast for your eyes.

Intelligent LED RGB color control facilitates versatile and attractive lighting designs. Colors, color changes and rhythms can be combined with one another effectively.

This creates impressive, inspiring, and unusual lighting effects in the elevator cab.

Colors change in the illuminated frame of the cab lighting. The light coming from the side is visually amplified by the reflection on the ceiling of the cab. The powerful LED light panel in the car generates excellent brightness.

Lighting effects can be programmed based on customer-specific, design, or functional requirements.

Applications include, for instance:

- Simulating the natural progression of daylight
- Creating lighting moods
- Visualizing different floors in different colors

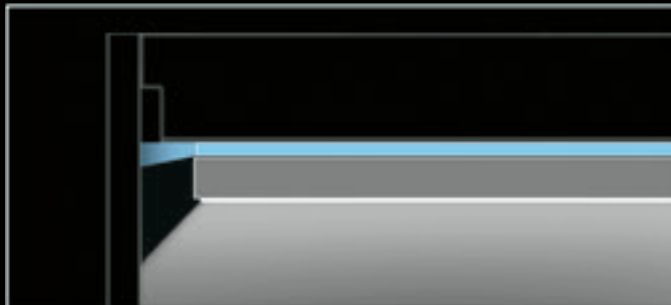

Vertical section: LD8-LED-RGB ceiling light.
Functional diagram of direct lighting.
LED neutral white, LED-RGB lighting control.



ISI 2040® elevator with LD8 LED RGB illuminated ceiling.

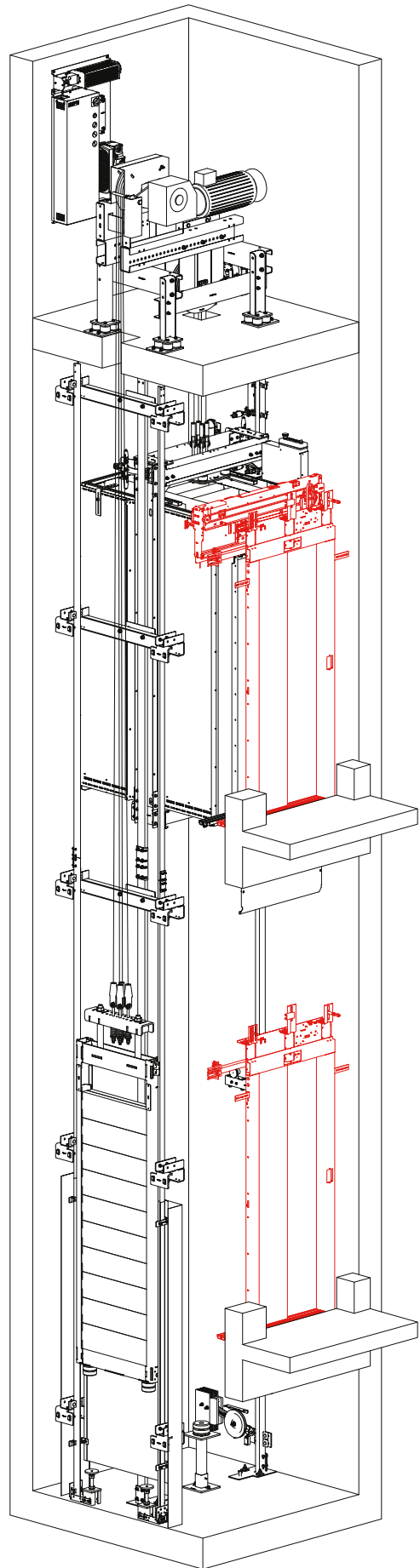

Doors – Reliable precision

The best way to manage 200,000 door movements per year* is with precise forces. The highest level of flexibility and comfort are essential.

You provide the use case, our modular system creates solutions for fault-free function over the course of many years.

*Assumption: Office elevator with 280 movements per day.

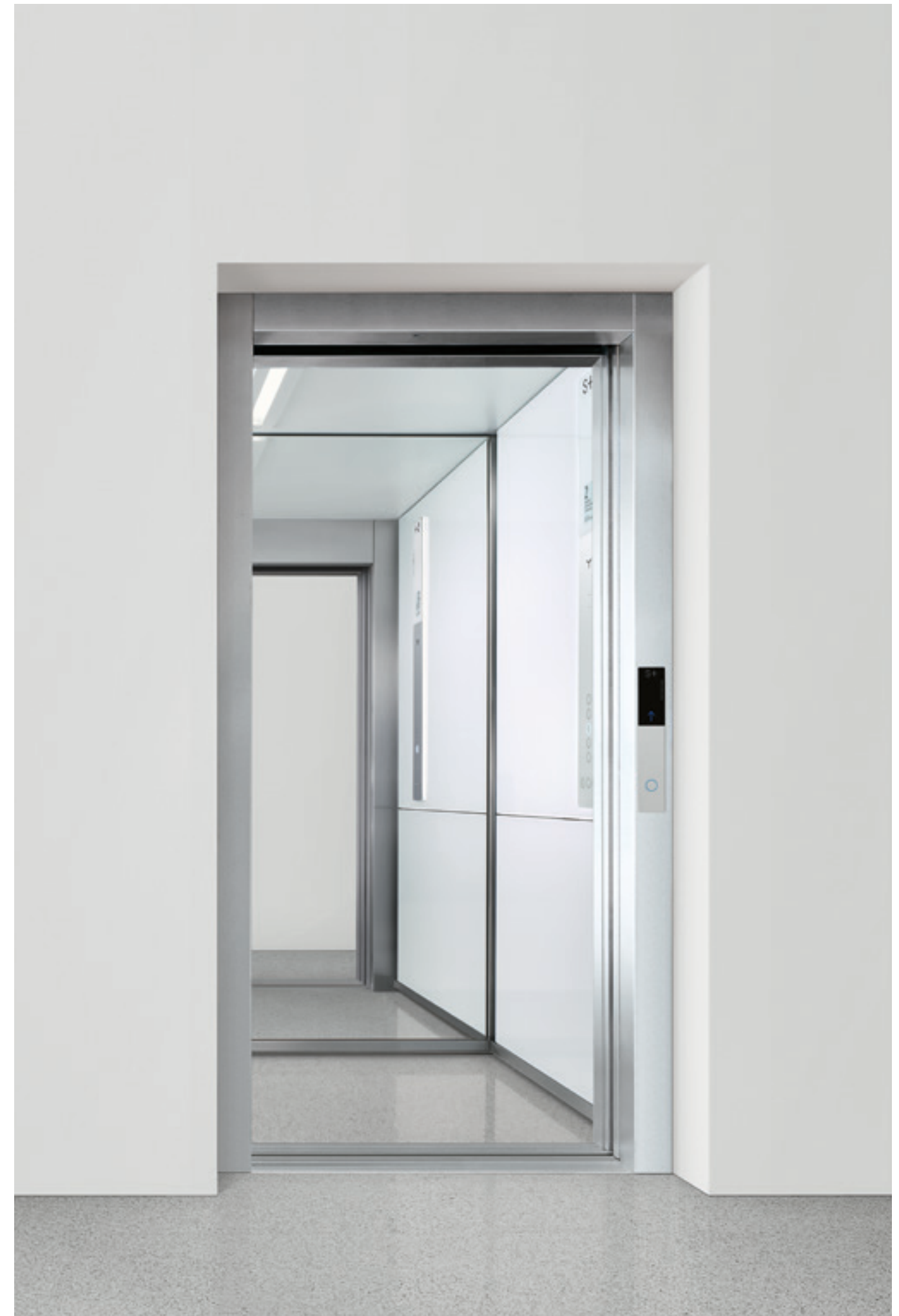



Wall connection T1

- Shaft door: Two-piece, one-side opening, sliding door, primed steel plate
Accessories: Stainless steel, satin finish
- Door frame / wall connection: Primed steel plate
Accessories: Stainless steel, satin finish
- Operating panel: Stainless steel, satin finish
- Buttons: Stainless steel, satin finish, inset flush
- Call acceptance: Blue LED
- Symbols: Plastic, light grey

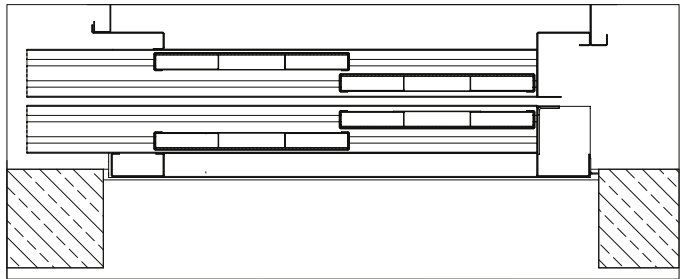

Horizontal section of cab and shaft door with door frame / wall connection T1.

Cabin and shaft door with wall connection T1 and wall skirting M1

- Wall skirting: Primed steel plate
Accessories: Stainless steel with finishing grinding



Cabin and shaft door with wall connection T1 and wall skirting M1
Door monitoring

- Door monitoring: Light grid



Cabin and shaft door with wall connection T1
Door sills, service access frame

- Service access frame: Primed steel plate
Accessories: Stainless steel, satin finish
- Shaft door: Two-piece, one-sided opening, sliding door, primed steel plate
Accessories: Stainless steel with finishing grinding
- Door frame / wall connection: Primed steel plate
Accessories: Stainless steel with finishing grinding
- Cabin door: Two-piece, one-sided opening, sliding door, Stainless steel with finishing grinding
- Door sills: Aluminium

Controls – Technology that thinks with you

Optimising traffic flow, reducing costs, energy consumption and waiting times. Modern controls designed for the specific type of building combine all these advantages.

Diverse communication options mean excellent function and low maintenance.

Flexible adjustment to requirements allows for options like preferred control, access authorisation, and fire control.

Intelligent technology for your custom solution on site.

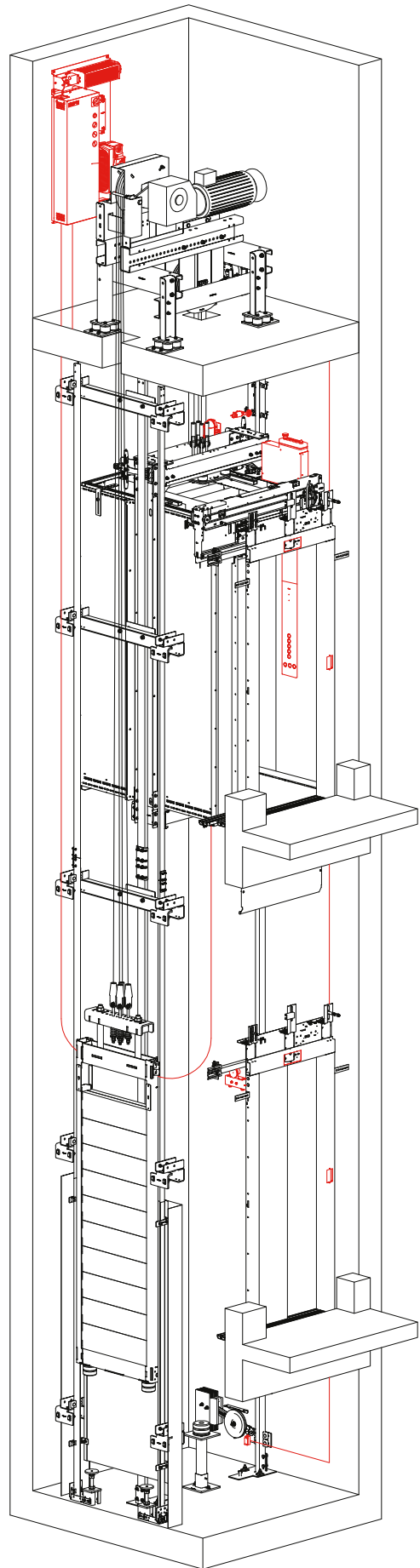

Controls

Type: MC12 with frequency regulation

Design: Microprocessor control with CAN-Bus technology

Options

Single-button collective control

Typical application area: Medium-sized residential and commercial buildings and hotels.

Downwards collective control

Typical application area: Residential buildings, commercial buildings with different tenants, visitors' lifts in hospitals with the traffic focus at the main entrance.

Two-button collective control

Typical application area: Larger commercial and administration buildings, department stores, hospitals and hotels, i.e. buildings with traffic between floors.

Group controls

Typical application area: High-rise buildings, hospitals, large commercial and administration buildings with several lift systems.



Operating panel BT-I-TFT-LED

Operating panel EN 81-70-B

Dimensions: HWD 1,205 x 150 x 15 mm
 Operating panel: Stainless steel with finishing grinding
 Light frame: Acrylic glass, white, satin finish, white LED
 Information panel: Acrylic glass, white
 Display: High-resolution TFT
 Buttons: Stainless steel with finishing grinding, flush-mounted
 Call acknowledgement: Blue LED
 Symbols: Plastic, light grey

Dimensions: HWD 180 x 500 / 600 x 99,5 mm
 Operating panel: Stainless steel with finishing grinding, DIN EN 81-70-B
 Buttons: Stainless steel with finishing grinding, large buttons, raised
 Main access: Plastic ring, green, raised
 Call acknowledgement: Blue LED
 Symbols: Plastic, light grey, raised, tactile

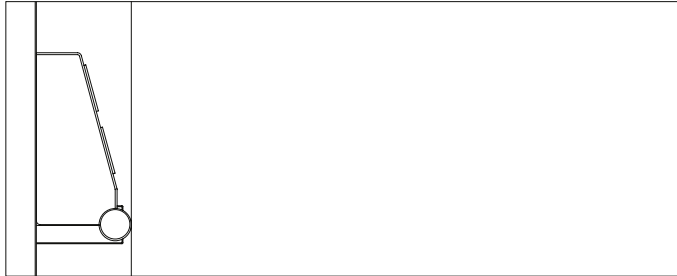
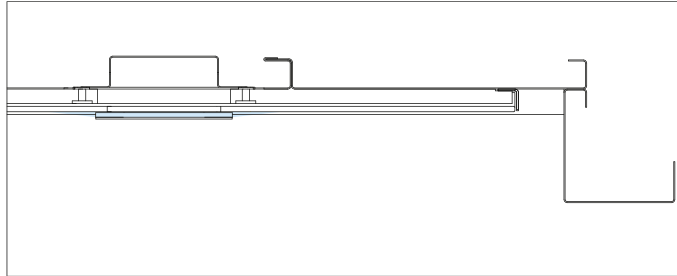

Horizontal section of side wall with mounted operating panel. Lighting scheme, light frame .

Vertical section of side wall, operating panel EN 81-70-B.

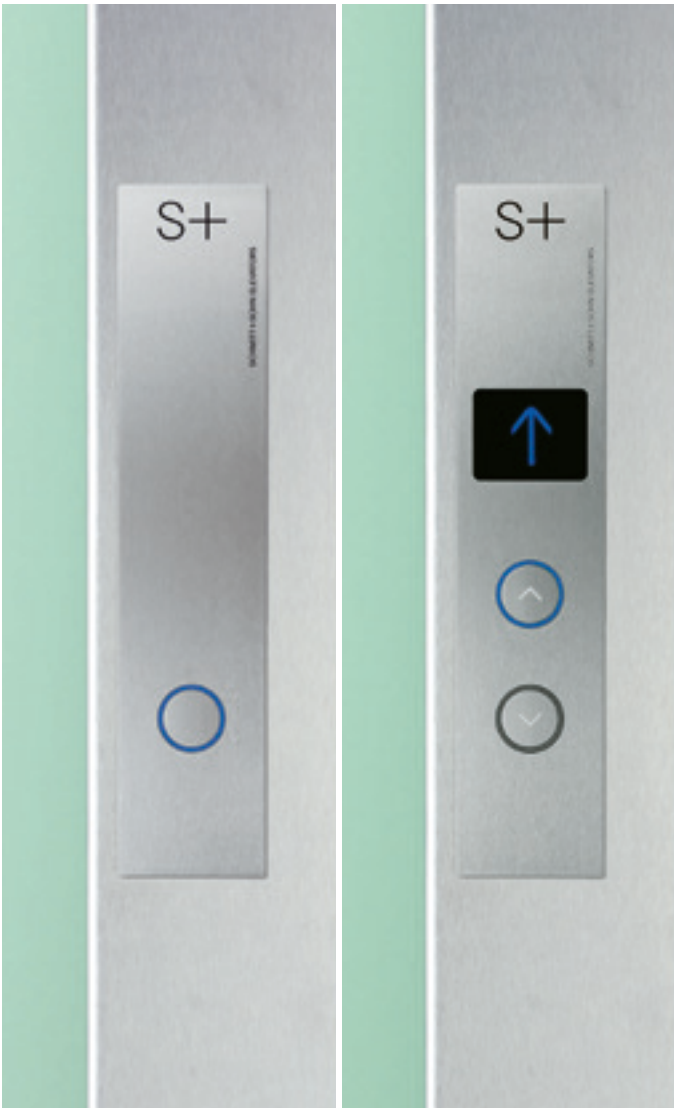

Operating panel BT-TP-66-1
 Single-button collective control
 Operating panel BT-TP-66-2
 Two-button and group collective control

Operating panel BT-TP-A-100
 Attached panel
 Single-button collective control

Dimensions: HWD 305 x 66 x 2 mm
 Operating panel: Stainless steel with finishing grinding, concealed attachment
 Display: Blue LED
 Buttons: Stainless steel with finishing grinding, flush-mounted, Arrangement to DIN EN 81-70
 Call acknowledgement: Blue LED
 Symbols: Plastic, light grey

Dimensions: HWD 437 x 100 x 26 mm
 Operating panel: Stainless steel with finishing grinding
 Skirting frame: Acrylic glass, white, optional areas surrounded by LED lighting
 Display: Blue LED
 Display: Blue LED
 Buttons: Stainless steel with finishing grinding, inset-flush
 Call acceptance: Blue LED
 Symbols: Plastic, light grey

Horizontal section of cab and shaft door with door frame / wall connection T1 / Operating panel BT-TP-A-100.

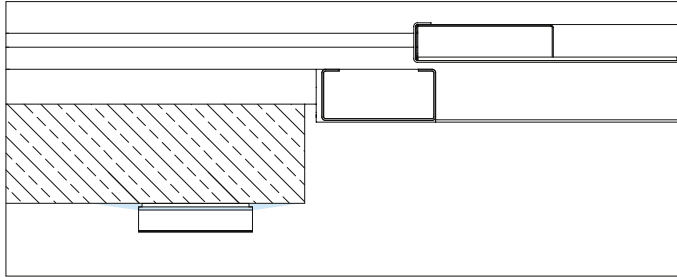

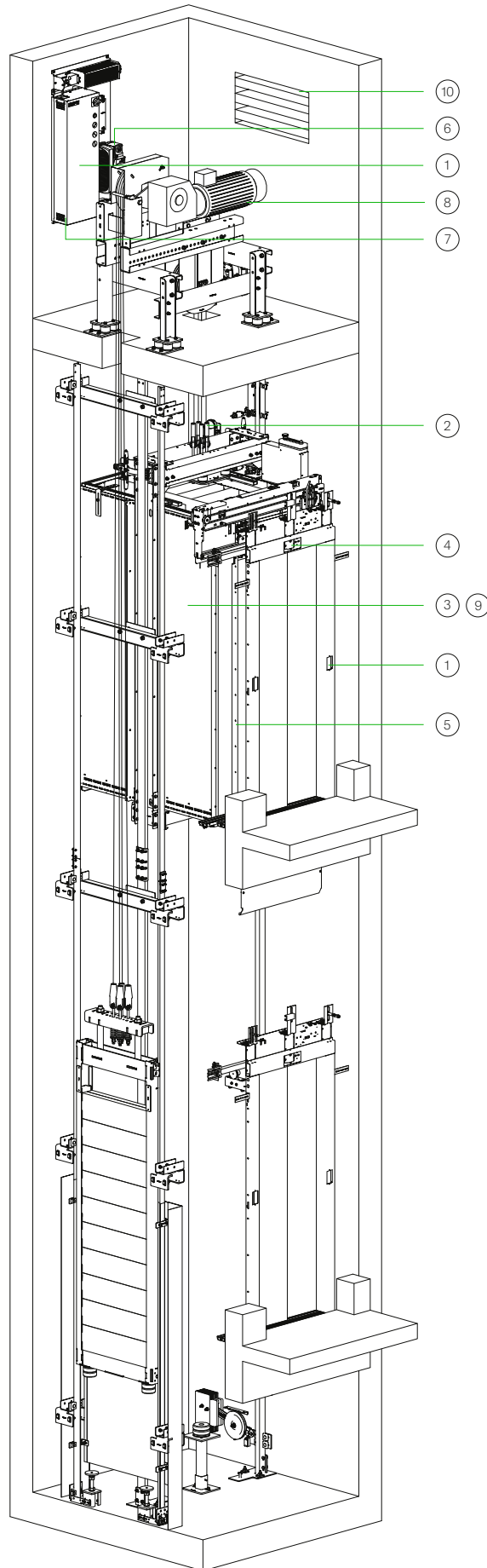

Energy efficiency – Economical and sustainable

40% of the power consumed throughout Germany is consumed by buildings. Elevators make up 3% to 5% of this consumption, amounting to 18TWh annually throughout Europe.

- Primary causes are:
- Consumption while travelling
 - Consumption while at a standstill
 - Energy loss due to escaping heat

Modern controllers and shaft smoke extraction systems can achieve savings of up to 50%. Targeted use of new components significantly improves efficiency.

Your Schmitt+Sohn service technician ensures the ongoing success of your system through elevator maintenance

Assembly / Functional Measures

Controls		Potential saving
① Double call block	Simultaneous external calls in upwards and downwards direction	☆☆
② Idling control	Deletion of multiple calls with cab empty	☆☆
③ Cab lighting deactivation*	Deactivation of cab lighting in parking position	☆☆☆☆☆☆
④ Deactivation of the display*	Deactivation of the cab display in parking position	☆☆
⑤ Deactivation of the light barrier*	Deactivation of the light barrier with closed doors	☆☆
⑥ Connection of the intermediate circuit	Mutual energy supply with opposite running of cabs in the group	☆☆☆☆
⑦ Requirement-optimised group algorithms	Optimisation of the group algorithm according to different usage requirements: – Energy-efficient operation – High transport performance and short waiting times	☆☆☆☆
Drive		
⑧ Frequency-regulated cable drive		☆☆☆☆☆
Frequency-controlled hydraulic drive	Reduction of the connection performance by electronically regulated travel curve	☆☆☆☆☆☆
Cab		
⑨ LED lighting	Use of LED instead of halogen lighting	☆☆☆☆☆☆
Shaft		
⑩ X-TRAC	Intelligent shaft smoke extraction with general building approval. The smoke extraction opening is closed by an electronically-controlled window / dome, and automatically opened only if required, e.g. in the event of fire.	☆☆☆☆☆☆

*Included in the MC 12 standard scope of delivery

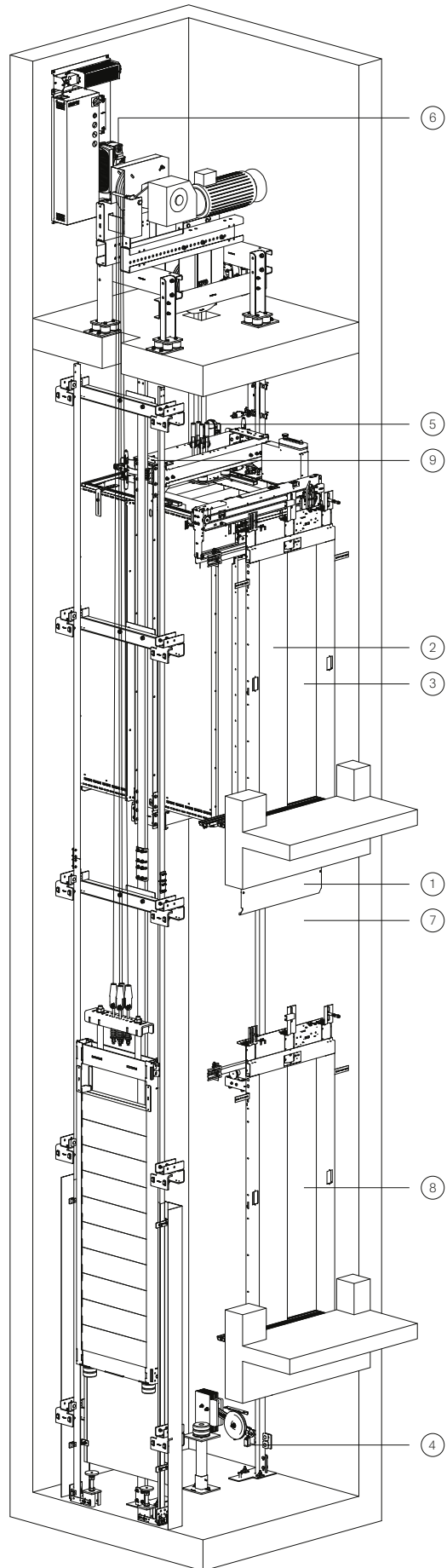

Safety – Special responsibility

Over half of all elevators are over 20 years old, and do not contain state-of-the-art technology.

At Schmitt+Sohn, avoiding risk is our top priority.

We are making the industry safer by creating new, custom solutions.
Effective, durable, reliable.

Based on the commitment and lived responsibility of a family company.

Dangers of older elevators

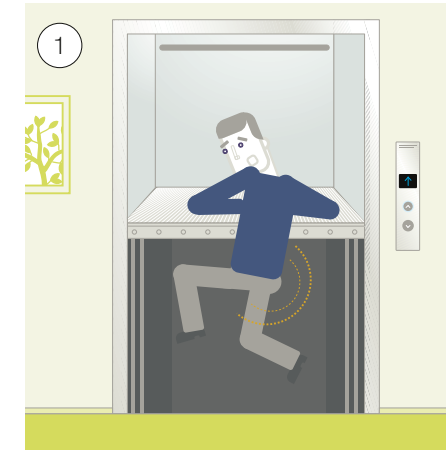

Skirts under the cab

- ❗ Danger of falls during emergency release
- ✓ Fitting of a suitable cab door skirt



Emergency call system and transfer

- ❗ Lacking emergency call transfer when passengers are trapped
- ✓ Installation of an emergency call transfer system

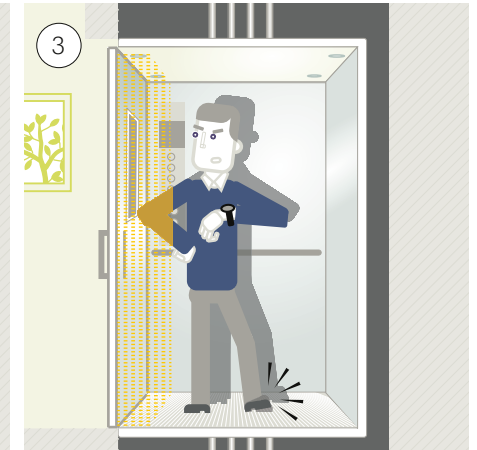

Cabs without doors

- ❗ Cabs without doors – danger of trapping against the shaft wall
- ✓ Installation of a cab closure door

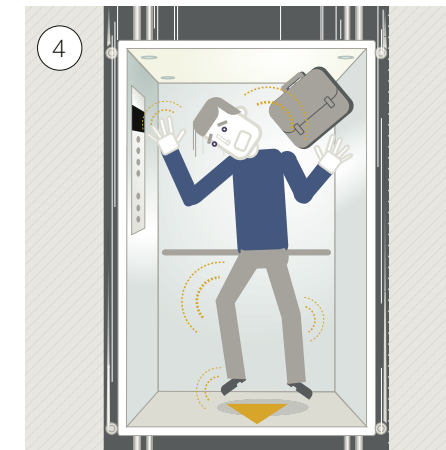

Speed limiter safety switch

- ❗ Danger of injury due to excessive speed of the cab
- ✓ Installation of electrical monitoring of the catchment device



Overload display

- ❗ Overloading of the lift
- ✓ Retro-fitting of a loading control



Stopping regulation and adjustment

- ❗ Danger of tripping due to inaccurate stopping
- ✓ Improvement of the stopping accuracy by installation of modern control and regulation equipment

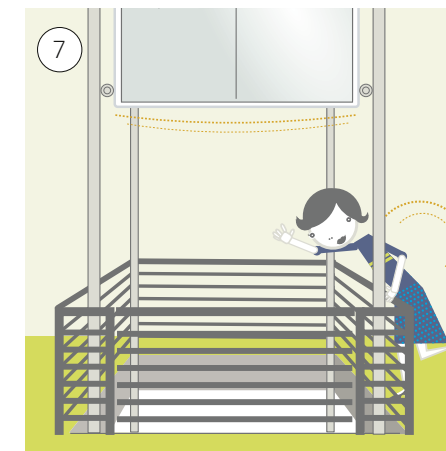

Shaft protection

- ❗ Danger of falling into the shaft and injury from moving parts
- ✓ Increase of available protection



Closure device for shaft sliding doors

- ❗ Danger of falling due to open shaft doors
- ✓ Installation of a closure device

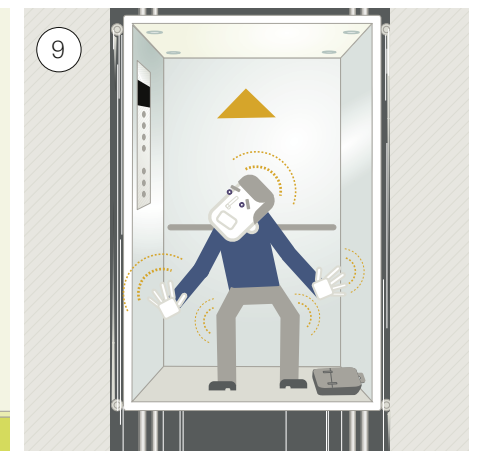

Uncontrolled upwards movement

- ❗ Danger of injury due to uncontrolled movement of the cab
- ✓ Retrofitting of an additional braking system



Risk assessment plus

The plus means service

Elevator operators are being assigned more and more responsibilities. According to Sec.3f of the Industrial Safety Regulation, this includes the obligation to identify necessary safety measures through regular risk assessments.

As your competent partner, we assess the situation on site in line with regulations and standards, including detailed documentation.

Our services go well beyond minimum requirements. In addition to comparing the current and target situations for more than 50 potential hazards with the help of specially trained GBU technicians, we provide a package of measures built on this comparison for a comprehensive risk assessment. Your personal service technician is available to you during and after the completion of work if advising is needed. Any actions are carried out specifically for you and tailored to your needs in a transparent, targeted, and cost-neutral manner.

Overview of services	GBU PLUS
Comparison to the state of the art	●
Package of measures	●
Risk assessment	●
Individual emergency rescue instructions Detailed emergency rescue instructions based on on-site circumstances. Easy-to-understand process description for maximum safety.	○
● included	○ options

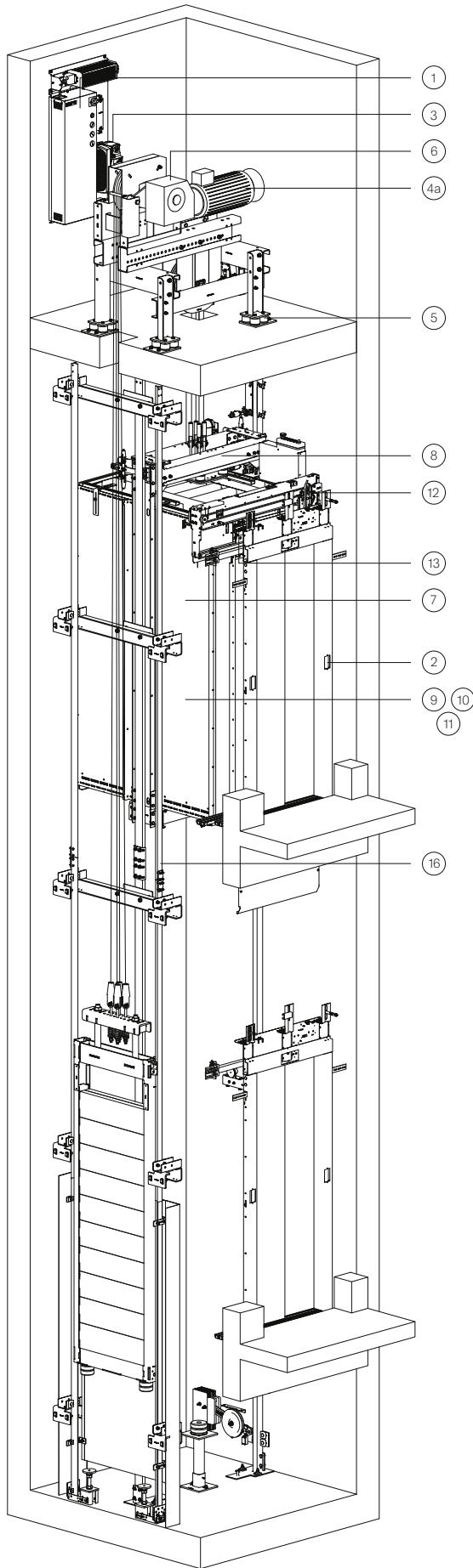

Comfort – Clearly top-class

Spatial effect

Elegant: outstanding design and innovative lighting concepts. For the eye.

Operating characteristics

Excellent: controllable acceleration, smooth running travel, precision stops to the millimetre. For a good feeling.

User-friendliness

Precise: intelligent control systems. Clear, user-friendly operating elements. Short wait times. Intuitive use and simple orientation. For efficiency.

Sound insulation

Understated: consistent use of noise-reducing renovations. For value in utility.

Comfort has many facets. Ideally, each of these impresses on its own – but in a Schmitt+Sohn elevator, their perfect combination makes every trip in one of our elevators an experience.

The modernisation of the following assemblies has significant effects on the following comfort features:

Assembly		Space effect	Travel characteristics	User-friendliness	Noise protection
Controls	① Microprocessor controls		●	●	●
	② Operating panels	●		●	
	③ Frequency regulation		●		●
Drive	④a Regulated gearless drives		●		●
	④b Regulated hydraulic assemblies (not shown)		●		●
	⑤ Insulation of the machine frame				●
	⑥ Conversion to dual-circuit braking systems		●		●
Cab	⑦ Cab	●	●		●
	⑧ Cab frame		●		●
	⑨ Panelling	●			●
	⑩ Equipment	●		●	
	⑪ Lighting	●		●	
Doors	⑫ Regulated door drives		●	●	●
	⑬ Door running rollers		●	●	●
	⑭ Light barriers			●	
Shaft	⑮ Guide rails		●		●
	⑯ Roller guides		●		●

CONTRACT CUSTOMER WITH SCHMITT+SOHN A PARTNERSHIP

Personal

Competent

Available

„One customer – one responsible service manager. An exacting commitment in itself. For the customer, this means: A competent partner, who takes care of every aspect of service. Throughout Europe.“

Tim Goebel, Authorised representative, Sales Service and Modernisation Manager.
Stands for excellent service.



Contract customer with Schmitt+ Sohn

Personal
Competent
Available

Contractual customers at Schmitt+Sohn.

This means: personal service at the highest level. Competence around the clock. Safety in perfection. Responsibility, born from tradition. With the independence of a family company. Guided by classic values. Carried forward by progress. A strong team. Always together. Always present. Always on the customer's side. With a focus on longterm partnerships and the highest possible satisfaction.

Excellent service for over 100 years. Throughout Europe, and where you are. Whenever you need us.





Installation precision – roller guide
Fine adjustment of the door mechanism
10,000 parts availability, service 24 / 365 / 0
Quality down to the last detail

Checking the lift control
Checking the shaft installation
Door and portal production – quality control
Experience and care

Excellent service That is what we stand for

Personnel

Your personal service manager is available to serve you throughout the entire service period. As your direct contact person, they are ready to help and support you with all of your concerns. The same service technician is always assigned to provide support to an individual elevator. Clarity through commitment. Quality through responsibility.

Expertise

Service managers at Schmitt+Sohn have a high level of qualifications, and usually have many years of professional experience as service technicians. They understand customers' needs and concerns based on their own experience. They know what they are talking about. You can trust in their promises.

The in-house Schmitt+Sohn Academy delivers continuous ongoing training. All employees benefit from regular continuing training measures. Over 118 apprentices are already creating the foundation for the excellent service of the future today. Our investment in long-term partnerships.

Available

Service from Schmitt+Sohn means service around the clock. and our availability goes beyond simply answering the phone. With 34 branches and sales offices, 117 service managers, 638 service technicians, 50 key users and 10 technical support employees, we are available throughout Europe. Replacement parts are available quickly thanks to our 796 vehicles that serve as a mobile replacement parts warehouse, 34 warehouses at our branch offices and a central warehouse containing over 10,000 parts in Nuremberg. Immediate reaction thanks to our on-call service, which is available around the clock to manage our service technicians.

The logistics of an international service provider.

In every one of our 34 European branches, you will find competent contact partners, who will be able to assist you on all subjects relating to elevators.

Germany

Service 24: +49 (0) 800 24 00 365
www.schmitt-aufzuege.de
info@schmitt-aufzuege.de

90402 Nürnberg
Hadermühle 9–15
Fon +49(0)911-2404-0
Fax +49(0)911-2404-111

86167 Augsburg
Bürgermeister-Wegele-Straße 12
Halle 1plus
Fon +49(0)821-56747450
Fax +49(0)821-56747451

95448 Bayreuth
Nürnberger Straße 19
Fon +49(0)921-787782-0
Fax +49(0)921-787782-28

13509 Berlin
Miraustraße 50–52
Fon +49(0)30-4360225-0
Fax +49(0)30-4360225-28

09125 Chemnitz
Reichenhainer Straße 171
Fon +49(0)371-53099-0
Fax +49(0)371-53099-99

96450 Coburg
Hahnwiese 5
Fon +49(0)9561-2498-0
Fax +49(0)9561-2498-70

01139 Dresden
Washingtonstraße 16/16a
Fon +49(0)351-2176090-0
Fax +49(0)351-2176090-30

99097 Erfurt
Alte Chaussee 89
Fon +49(0)361-644999-0
Fax +49(0)361-644999-28

45141 Essen
Bamlerstraße 5a
Fon +49(0)201-28010-0
Fax +49(0)201-28010-48

60314 Frankfurt
Riederhofstraße 16–18
Fon +49(0)69-420805-0
Fax +49(0)69-420805-29

50226 Frechen
Alfred-Nobel-Straße 7–9
Fon +49(0)2234-95379-0
Fax +49(0)2234-95379-22

Austria

www.schmitt-aufzuege.at
info@schmitt-aufzuege.at

6020 Innsbruck
Grabenweg 72
Fon +43(0)512-346502-0
Fax +43(0)512-346502-1

8020 Graz
Puchstraße 17-21
Obj. 12, 3. OG
Fon +43(0)316-262923
Fax +43(0)316-262924

4020 Linz
Wiener Straße 131
Fon +43(0)732-330226-0
Fax +43(0)732-330226-16

1100 Wien
Triester Straße 87
Bürogebäude, 2. Stock
Fon +43(0)1-4055508-0
Fax +43(0)1-4055508-4

79108 Freiburg
Neuer Messplatz 3
Fon +49(0)761 296789-0

22453 Hamburg
Papenreye 25
Fon +49(0)40-589713-0
Fax +49(0)40-589713-13

74074 Heilbronn
Ferdinand-Braun-Straße 8
Fon +49(0)7131-89985-0
Fax +49(0)7131-89985-44

30851 Langenhagen
Erich-Ollenhauer-Straße 3
Fon +49(0)511-72587-0
Fax +49(0)511-72587-25

67065 Ludwigshafen
Am Bubenpfad 1
Fon +49(0)621-579280-0
Fax +49(0)621-579280-9

04416 Markkleeberg-Wachau
Weinteichstraße 5
Fon +49(0)34297-1666-0
Fax +49(0)34297-1666-19

93059 Regensburg
Im Gewerbepark A2
Fon +49(0)941-46462-0
Fax +49(0)941-46462-46

72070 Tübingen
Industriestraße 24
Fon +49(0)7071-7969-0
Fax +49(0)7071-7969-29

85716 Unterschleißheim
Röntgenstraße 2
Fon +49(0)89-959398-0
Fax +49(0)89-959398-18

97076 Würzburg
Friedrich-Bergius-Ring 30
Fon +49(0)931-25042-0
Fax +49(0)931-25042-29

Portugal

www.schmitt-elevadores.com
info@schmitt-elevadores.com

Porto
4465-688 Leça do Balio
Rua Dom Frei Martim Fagundes
Tel +351-229 569 000
Fax +351-229 569 009
Serviço 24h: +351-229 569 002

Lisboa
2790-034 Carnaxide
Rua da Barruncheira, 3–1º
Esquerdo
Tel +351-213 030 350
Fax +351-213 032 706
Serviço 24h: +351-213 030 359

4700-361 Braga
Rua António Marinho, 68
Tel +351-253 610 819
Fax +351-253 260 951
Serviço 24h: +351-253 610 819

6000-228 Castelo Branco
Rua Fernando Namora,
LT I-3 , Lj.3
Tel +351-272 342 472
Fax +351-272 342 428
Serviço 24h: +351-272 342 472

3025-037 Coimbra
Urbanização do Loreto LT 4
R/C - C/C
Tel +351-239 493 803
Fax +351-239 496 329
Serviço 24h: +351-239 493 803

8005-325 Faro
Praceta Henrique Bernardo Ramos nº9
Tel +351-289 822 758
Fax +351-289 813 098
Serviço 24h: +351-289 813 156

Czech Republic

www.schmitt-vytahy.cz
info@schmitt-vytahy.cz

36211 Karlovy Vary
Jenišov 116
Tel +420 353 433-722
Fax +420 353 433-721

14900 Praha 4 – Chodov
Klecandova 2380/1
Tel +420 272 191-652
Fax +420 272 191-651

323 00 Plzeň 1 – Bolevec
Bolevecká náves 35/27
Tel +420 353 433-735
Fax +420 353 433-721

Germany Austria Portugal Czech Republic

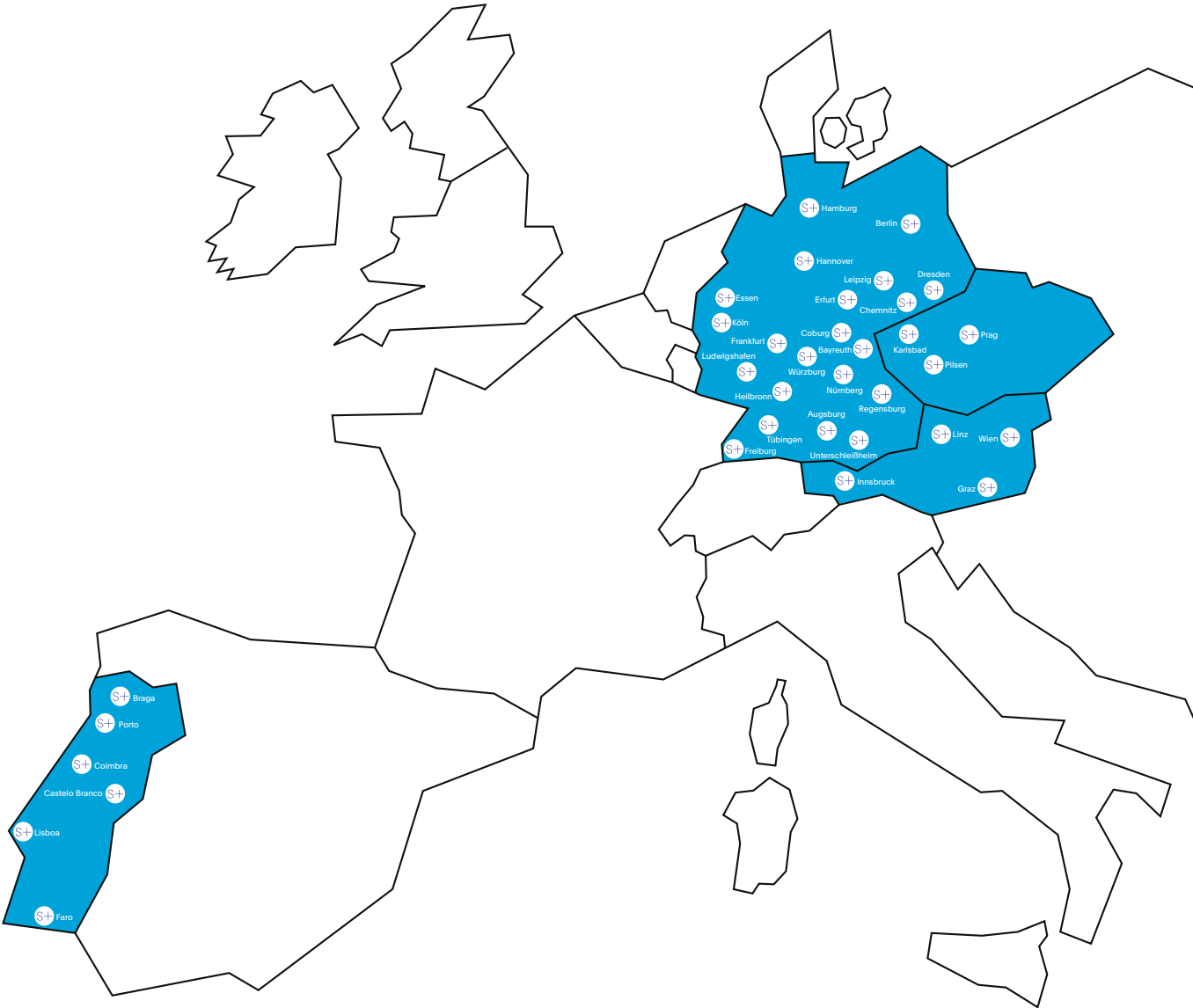

Imprint

Publisher:
Aufzugswerke
Schmitt+ Sohn GmbH & Co.KG
Hadermühle 9–15
D-90402 Nürnberg

Editorial:
Dr. Johannes Schmitt
Maximilian Schmitt
Tim Goebel
Aniko Peiffer
Marius Schreyer

Design:
Marius Schreyer Design

Product design:
Schmitt+ Sohn Aufzüge
Marius Schreyer Design

Realization:
Loffmedia

Printing:
Aumüller Druck

Illustrationen:
Sonja Gagel

Paper: Profi Silk
Envelope 300g, inside 170g
Type: Plain

© Schmitt+ Sohn Aufzüge
All rights reserved.

As at 03-2023 • 177370

Illustration acknowledgements::

Portrait photography::
Gerd Grimm
Projekttriangle Design Studio
Martin Grothmaak
Tom Ziora

Photography of references
and documentation:
Projekttriangle Design Studio
Martin Grothmaak
Tom Ziora
Willy Weihreter

Product photography:
MBS Studios
Thomas Esch
Marius Schreyer Design
Gerd Grimm

Legal notice / disclaimer:

The brochure, „Service. Personal competent available“ is copyright protected. All rights reserved by the author. Any distribution or transmission to third parties, and any duplication, editing, presenting, sending, renting, lending or other use of this brochure or parts thereof without the express written consent of the author is prohibited, and will be prosecuted by civil and criminal means.

The persons shown in this brochure have provided their consent in accordance with the law. Transmission of this personal data without authorization is considered a violation of data protection law, and reported by the author.

Subject to technical amendment.
Colour variations may occur due to printing methods.

Registered designs:
All colour combinations illustrated are registered and protected as community designs by Schmitt Markenschutzgesellschaft mbH in Germany and other countries.

Trademark:
ColorGlas® is a trademark of Schmitt Markenschutzgesellschaft mbH registered in Germany and other countries.



SCHMITT+ SOHN ELEVATORS

Schmitt+ Sohn Elevators GmbH & Co.KG
Hadermühle 9–15
D-90402 Nuremberg

Phone +49(0)911 - 2404 - 0
Fax +49(0)911 - 2404 - 111

neuanlage@schmitt-aufzuege.com
service@schmitt-aufzuege.com
www.schmitt-aufzuege.com

The company Schmitt+ Sohn Elevators has been awarded internationally renowned design prizes for its corporate design, the company presentation, its elevator systems and elevator series.

- iF product design award 1997, Schmitt+ Sohn Elevator Systems
- iF product design award 2008, Schmitt+ Sohn Color Glas® Elevators
- 2009 Design Prize of the Federal Republic of Germany, nomination, Schmitt+ Sohn Color Glas® Elevators
- red dot award communication design 2011, Schmitt+ Sohn Corporate Design
- red dot award communication design 2011, Schmitt+ Sohn Corporate Company Brochure
- iF communication design award 2011, Schmitt+ Sohn Company Brochure
- 2012 Design Prize of the Federal Republic of Germany, nomination, Schmitt+ Sohn Company Brochure
- German Design Award 2015, special mention for Schmitt+ Sohn Corporate Design
- German Design Award 2015, special mention for Schmitt+ Sohn Color Glas® Elevators
- Iconic Award 2014 for Schmitt+ Sohn product brochures
- Iconic Award 2014 for Schmitt+ Sohn exhibition stand construction 2013
- Iconic Award 2014 for Schmitt+ Sohn new construction of branch in Coburg
- Iconic Award 2014 for Schmitt+ Sohn Color Glas® Elevators
- Iconic Award 2014 for Schmitt+ Sohn Product Forum
- German Brand Award 2020, Winner in Excellence in Brand Strategy and Creation
- German Brand Award 2020, Gold in Excellent Brands for Schmitt+ Sohn Elevators



Schmitt+Sohn Elevators GmbH & Co.KG
Hadermühle 9-15
D-90402 Nuremberg

Phone +49(0)911 - 2404 - 0
Fax +49(0)911 - 2404 - 111

neuanlage@schmitt-aufzuege.com
service@schmitt-aufzuege.com
www.schmitt-aufzuege.com